

TOWNSHIP N° 29 SOUTH RANGE N° 64 EAST

MOUNT DIABLO MERIDIAN

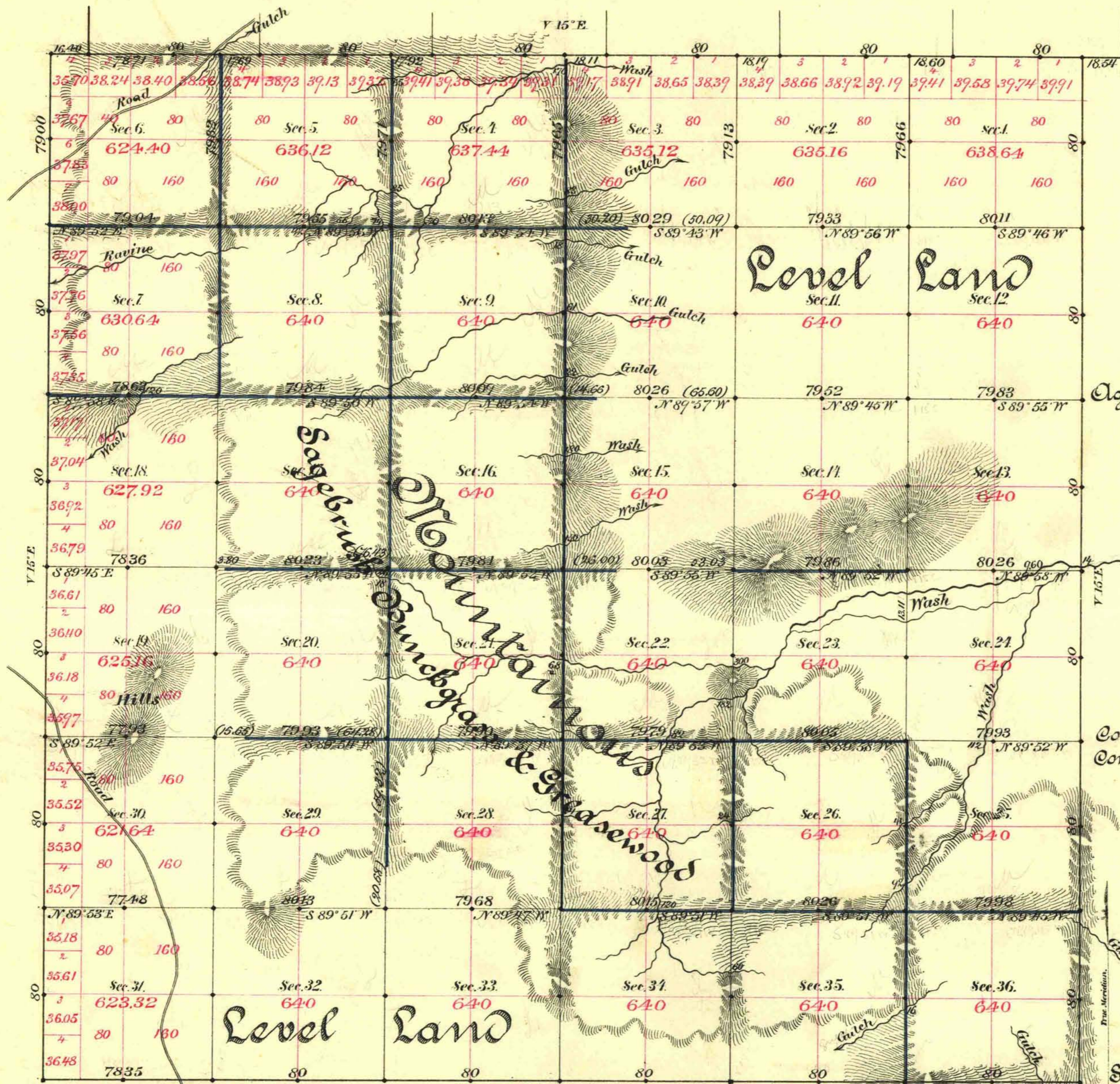

Aggregate Area of Public Land Surveyed 22935.56 Ac.

Commenced Sept 19th 1883
Completed " 27th "

Subdivisions run with a Var. of 15° East

Surveys Designated.	By Whom Surveyed.	Date of Contract.	Amount of Surveys.	When Surveyed.	Acres.
East Oddy	E. A. Magee	July 24 th 1882	16 - 85 - 80	1883	152
W. S. & W.	W. H. Myrick	" 22 nd "	17 - 77 - 35	"	151
Section lines black	"	"	28 - 40 - 20	Sept	"
" blue	"	"	31 - 26 - 64	"	"
Convergency	"	"	1 - 10 - 51	"	"

The above Map of Township No. 29 South of Range No. 64 East Mount Diablo Meridian is strictly conformable to the field notes of the survey thereof on file in this Office, which have been examined and approved.

Surveyor General's Office, Reno, *L. C. Conning*
U. S. Surv. Gen'l. of Nevada.
February 23rd 1884