

TOWNSHIP N<sup>o</sup> 29 NORTH RANGE N<sup>o</sup> 61 EAST MOUNT DIABLO MERIDIAN

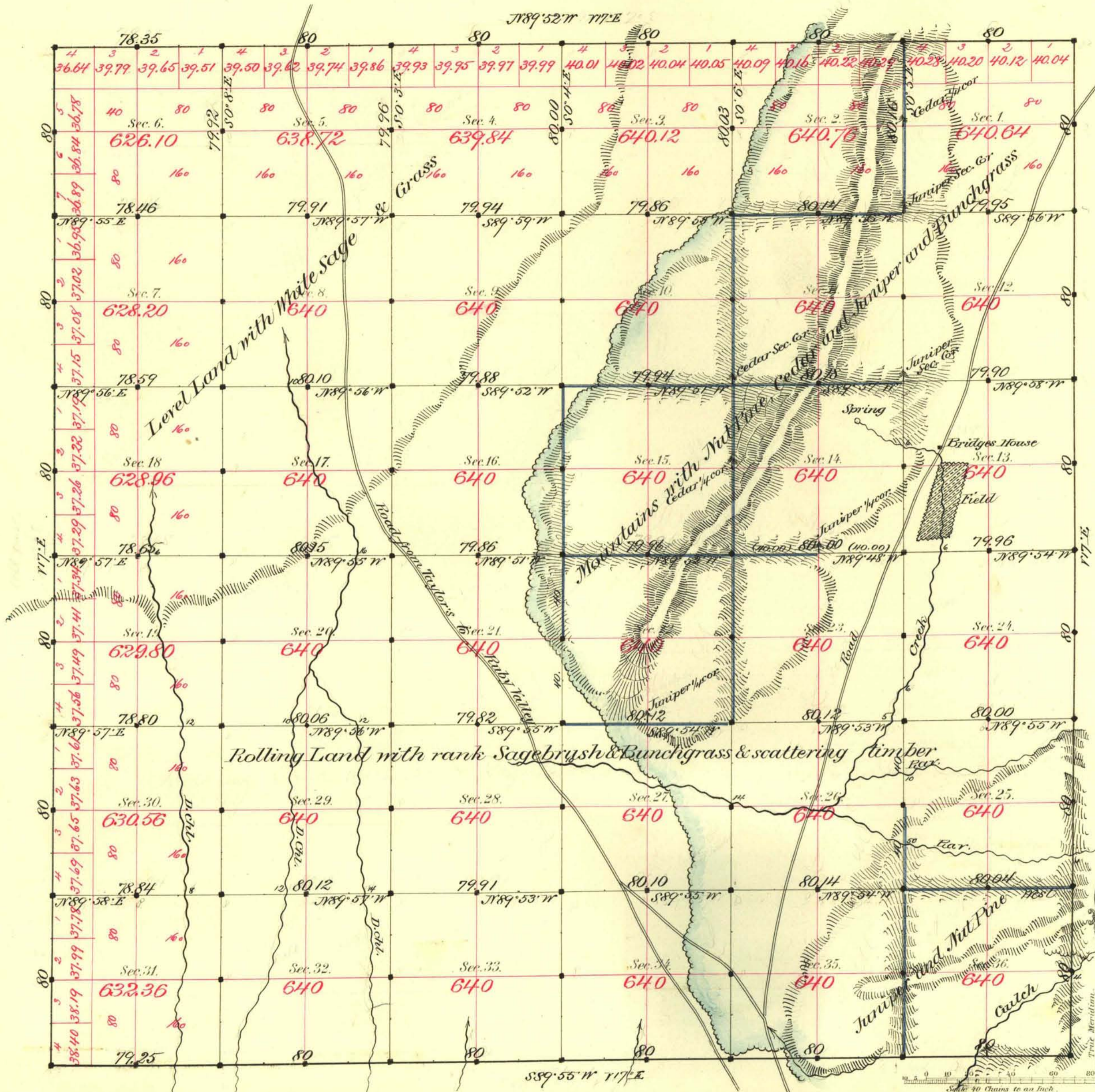

Aggregate Area of Public Land Surveyed 22,976.06 Ac.

Commenced July 1<sup>st</sup> 1882  
Completed " 22<sup>nd</sup> "

Subdivisions run with a Var. of 1<sup>st</sup> East

Survey Designated	By Whom Surveyed	Date of Contract	Amount of Surveys	When Surveyed
Township lines	Parker & Thorburn	Aug. 12 <sup>th</sup> 1881	23 - 77 - 80	1881
Subdivisions Black line	Monroe & McClellan	June 12 <sup>th</sup> 1882	46 - 33 - 03	July 1882
" "	" "	" "	13 - 40 - 54	" "

17<sup>th</sup> Cor.  
130  
140

The above Map of Township No. 29 North of Range No. 61 East  
Mt. Diablo Meridian  
is strictly conformable to the field  
notes of the survey thereof on file in this Office, which have been examined and approved.  
Surveyor General's Office,  
Sierra Nevada  
September 5<sup>th</sup> 1882

*[Signature]*  
Sur. Gen. Ser.