

Recd with Sur Gen letter of Feby 9, 1874

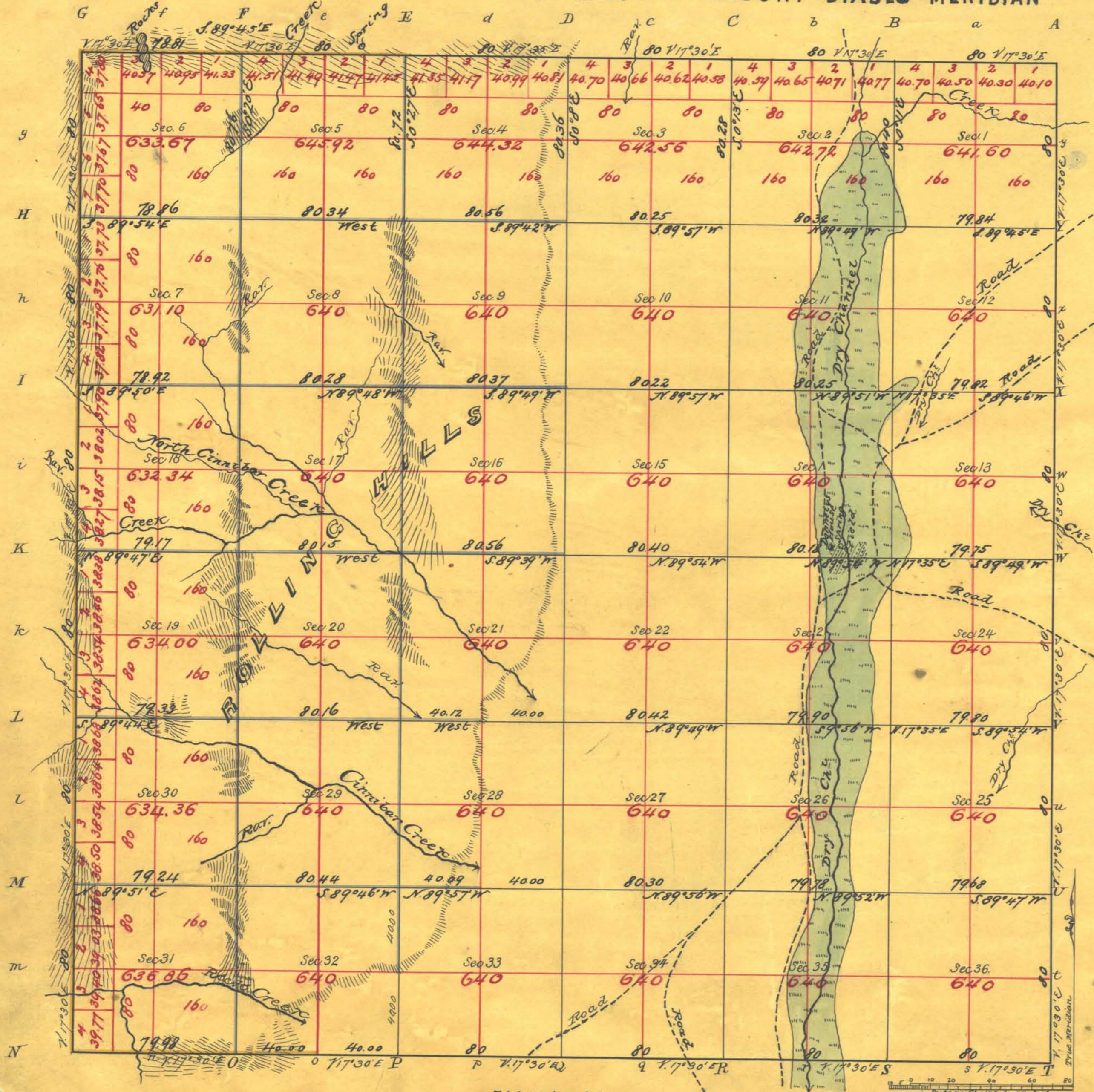

Aggregate Area of Public Land 23,019.45 Acres

Paid Reprint 25626

Filed in the District Land Office at Carson Nevada February 10th 1874

Department of the Interior,
General Land Office,
Washington, D. C., November 14th 1874

*Commenced October 28th 1873
Completed " 30th 1873*

I hereby certify that this is a true and literal exemplification of the township plat of survey to which it purports to relate, now on file in this office.

[Signature]
Commissioner

Subdivision lines not otherwise noted run with a variation of 17° 30' E

Surveys Designated	By Whom Surveyed	Date of Contract	Amount of Surveys	When Surveyed	No.
North Boundary Township roads	M. Hatch of N. Eaton	July 14 th 1869	35 05 25	1869	27
Subdivisions	M. Hatch, J. H. Eaton, J. Chapman	August 31 st 1872	10 40 00	1872	51
Subdivision lines	"	"	34 41 95	"	51
Township lines (Yellow)	W. M. Shaffer, G. M. Caswell	July 10 th 1873	9 38 79	1873	58
Subdivisions (Blue) and G. S. Preble	"	"	25 40 07	Oct. 1873	58

The above map of Township N° 28 North of Range N° 38 East Mount Diablo Meridian is strictly conformable to the field notes of the survey thereof on file in this Office which have been examined and approved

*Surveyor General's Office
Virginia City, Nevada
January 30th 1874*

*E. S. Davis
Sur. Genl Nevada*