

TOWNSHIP N^o 26 NORTH RANGE N^o 38 EAST MOUNT DIABLO MERIDIAN

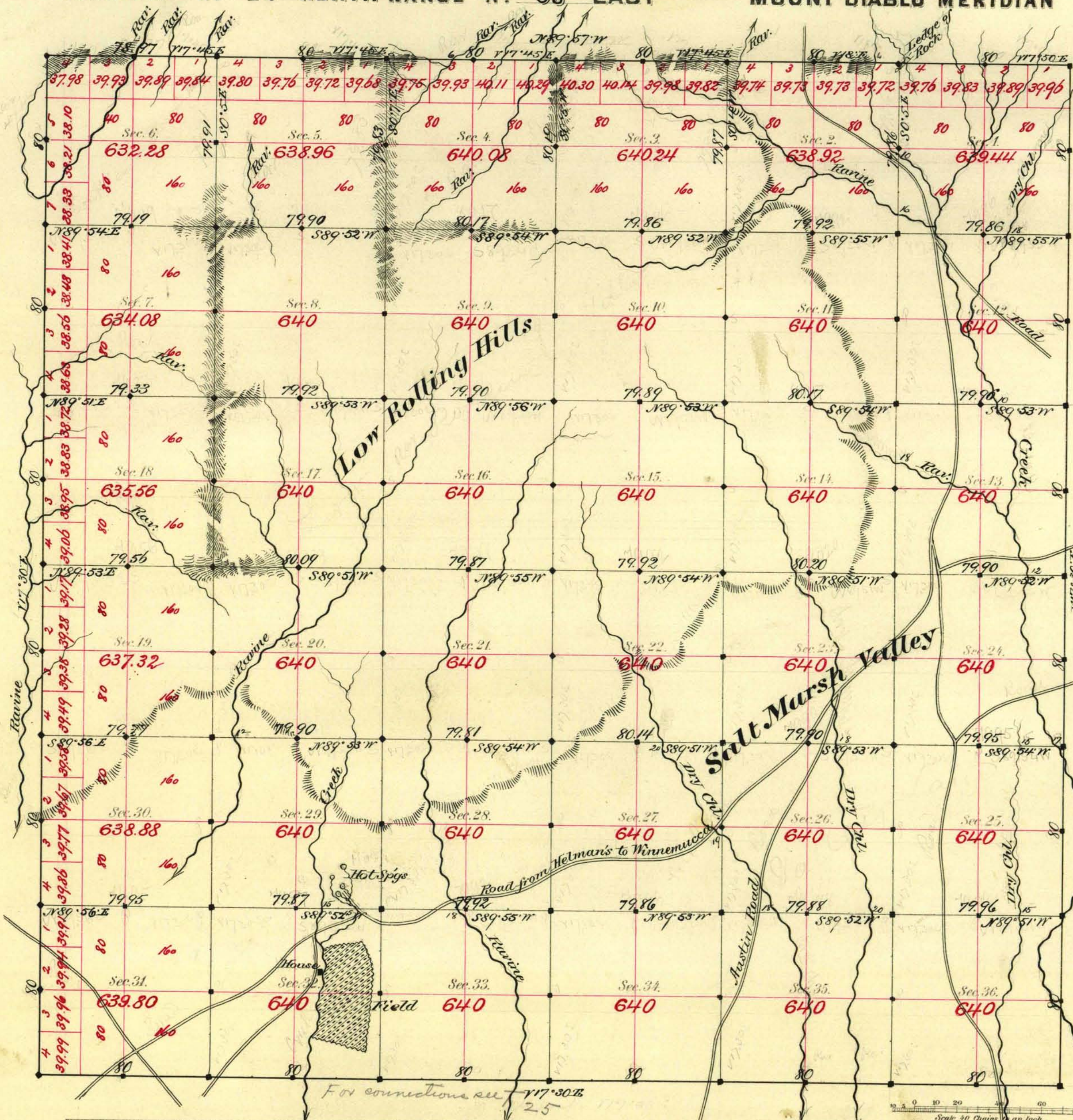

Aggregate Area of Public Land Surveyed 23,015.56 Ac.

Commenced October 26th 1882
Completed November 1st "

Subdivisions not noted run with a Var. of 17.30 East.

Survey Designated	By Whom Surveyed	Date of Contract	Amount of Survey	When Surveyed
1/2 lines	Conkling & Stewart	Nov. 14 th 1881	23 - 78 - 187	1881
Subdivs	C. L. Bridges	July 20 th 1882	59 - 76 - 187	1882

770 Cont.
132
156

The above Map of Township N^o 26 North of Range N^o 38 East of Mount Diablo Meridian is strictly conformable to the field notes of the survey thereof on file in this Office, which have been examined and approved.
Surveyor General's Office,
Reno Nevada
January 29th 1883
D. L. Davis
Sur. Genl.