

TOWNSHIP 24 NORTH, RANGE 63 EAST, OF THE MOUNT DIABLO MERIDIAN, NEVADA  
DEPENDENT RESURVEY

OFFICIALLY FILED  
NEVADA LAND OFFICE  
10:00 A.M. APRIL 13, 1967

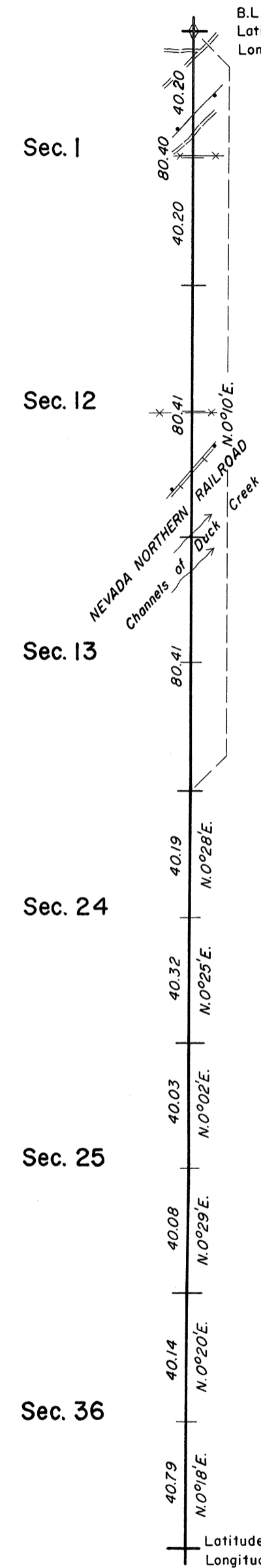

Mean Magnetic Declination  
17°30'E.

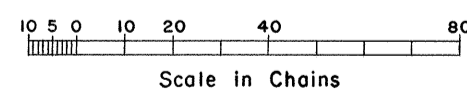

History of the earlier surveys is contained in the field notes.

This plat represents the dependent resurvey of the east boundary, designed to restore the corners in their true original locations according to the best available evidence.

Survey executed by Horace G. Parker, Cadastral Surveyor, beginning July 10, 1964, and completed July 15, 1964, pursuant to Special Instructions for Group No. 413, Nevada, dated June 14, 1963.

UNITED STATES DEPARTMENT OF THE INTERIOR  
BUREAU OF LAND MANAGEMENT  
Washington, D. C. March 9, 1967

This plat is strictly conformable to the approved field notes, and the survey, having been correctly executed in accordance with the requirements of law and the regulations of this Bureau, is hereby accepted.

For the Director

*E. J. Huntington*  
Chief, Division of Engineering