

# TOWNSHIP 22 SOUTH, RANGE 58 EAST, OF THE MOUNT DIABLO MERIDIAN, NEVADA.

## DEPENDENT RESURVEY

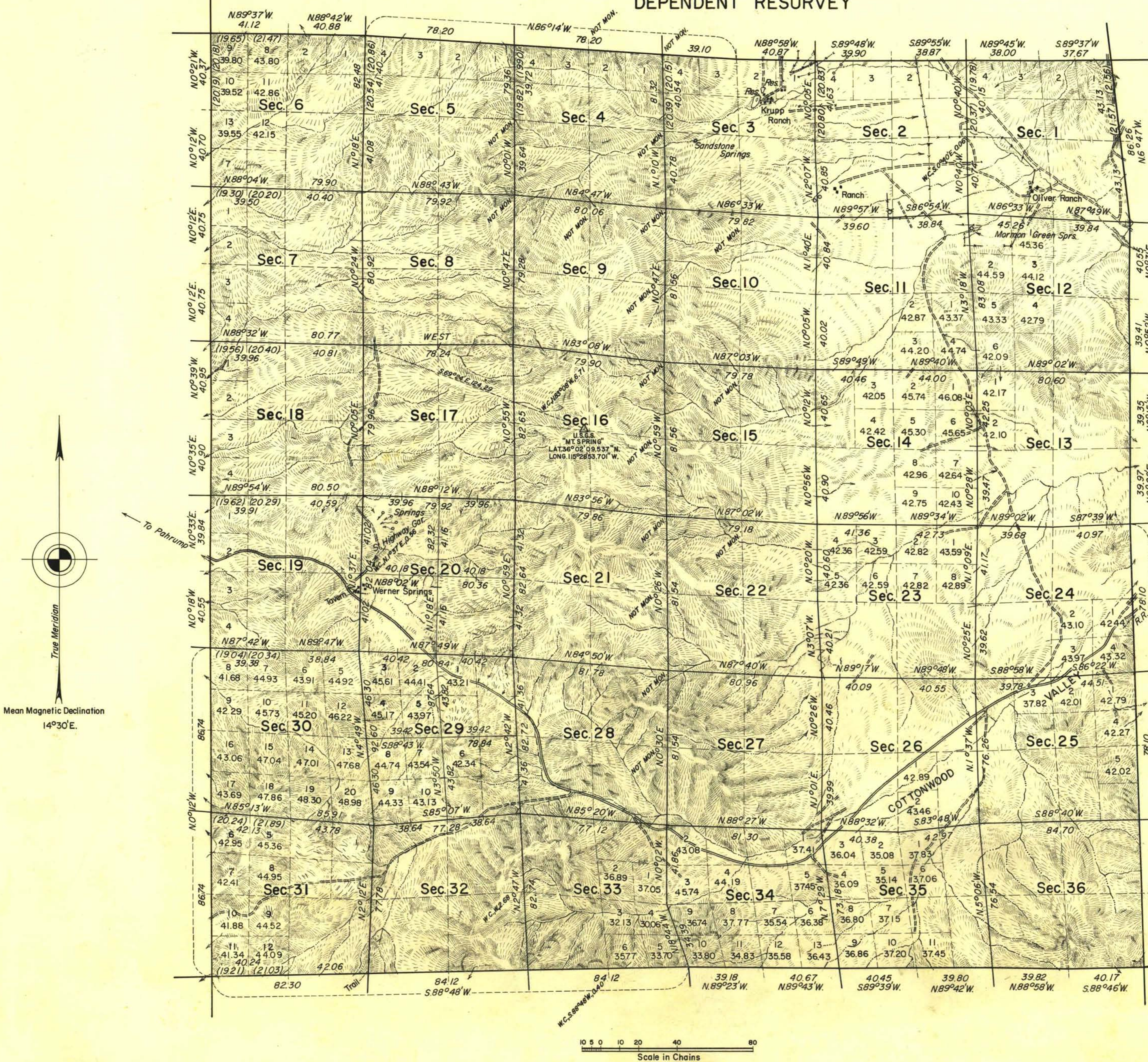

The exterior boundaries and subdivisional lines were surveyed by Brunt and Proctor in 1881.

This plat represents the dependent resurvey of the exterior boundaries and subdivisional lines designed to restore the corners in their original locations according to the best available evidence, and the survey of the subdivision of sections 20 and 29, T. 22 S., R. 58 E., Mt. Diablo Meridian, Nevada. Except as shown hereon, lottings and areas are as shown on plat approved September 9, 1881.

Survey executed by Horace G. Parker March 26, 1956 to January 29, 1958 under special instructions dated March 13, 1956 and supplemental special instructions dated August 20, 1956 for Group 365, Nevada.

Topography within the township taken from U. S. Geological Survey topographic maps.

UNITED STATES DEPARTMENT OF THE INTERIOR  
BUREAU OF LAND MANAGEMENT  
Washington, D. C. May 11, 1959

This plat is strictly conformable to the approved field notes, and the survey, having been correctly executed in accordance with the requirements of law and the regulations of this Bureau, is hereby accepted.

For the Director

*Earl G. Harrington*  
Cadastral Engineering Staff Officer

Latitude 35°59'03"N.  
Longitude 115°25'00"W.

Area resurveyed: 23,214.15 acres

2491-a

T.22 S., R.58 E.

M.S.  
55852 P. R.H.