

TOWNSHIP N^o 21 SOUTH RANGE N^o 68 EAST MOUNT DIABLO MERIDIAN

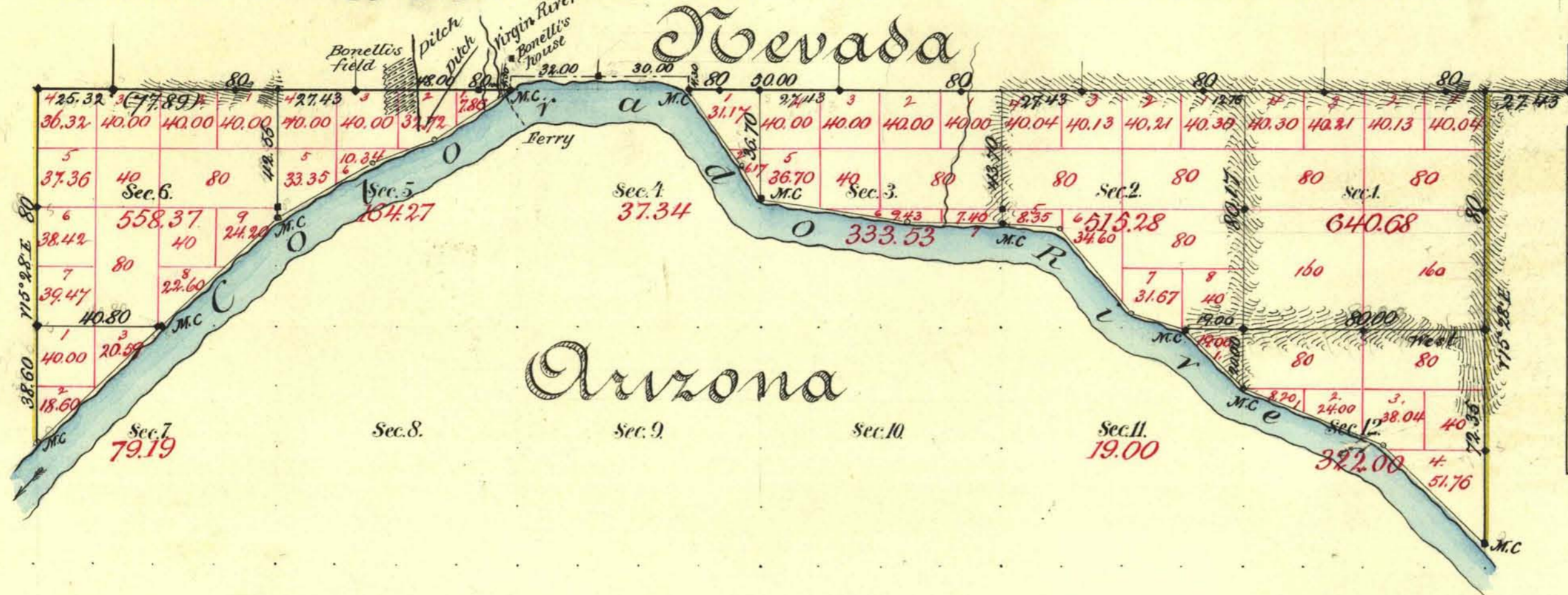

Meanders of the Colorado River

Sec	Course	Dist	Sec	Course	Dist
Commence at M.C. on N. bdy. of Tp. thence			Commence at M.C. on N. bdy. of Tp. thence		
7	N 46° E	57.00	4	S 35° E	31.10
6	" 44 1/4 "	52.80	"	" 23 "	12.50
5	" 60 1/4 "	36.00	3	" 81 1/4 "	49.00
"	" 69 "	21.80	"	" East "	31.61
"	" 55 1/2 "	29.00	2	" 87 "	19.00
			"	" 40 "	37.00
			"	" 69 1/4 "	20.00
			11	" 45 "	28.34
			12	" 68 1/4 "	50.00
			"	" 45 "	47.60
			Aggregate		522.68
			6-42-68		

Aggregate area of Public Land surveyed 2,669.66 ac.

Sec. 18. Sec. 17. Sec. 16. Sec. 15. Sec. 14. Sec. 13.

Sec. 19. Sec. 20. Sec. 21. Sec. 22. Sec. 23. Sec. 24.

Sec. 30. Sec. 29. Sec. 28. Sec. 27. Sec. 26. Sec. 25.

Sec. 31. Sec. 32. Sec. 33. Sec. 34. Sec. 35. Sec. 36.

Commenced June 15th 1883
Completed " 29th "

Bulldens run with a Var. of 16' 28" East

Surveys Designated.	By Whom Surveyed.	Date of Contract.	Amount of Surveys.	When Surveyed.
M. Body	W. H. Myrick	May 20 th 1882	25-47-89	1882
Or W "	"	July 11 th 1882	3-30-95	1882
Bulldens	"	"	4-42-92	June
Conveyance	"	"	1-67-80	"
Meanders	"	"	6-42-68	"

719 Com
-109
145
!

The above Map of Township No. 21 South of Range No. 68 East Mount Diablo Meridian is strictly conformable to the field notes of the survey thereof on file in this Office, which have been examined and approved.

Surveyor General's Office, Reno. *L. L. Downing*
March 22nd 1884 U.S. Surv. Genl. of Nevada.