

TOWNSHIP N° 20 SOUTH RANGE N° 68 EAST MOUNT DIABLO MERIDIAN

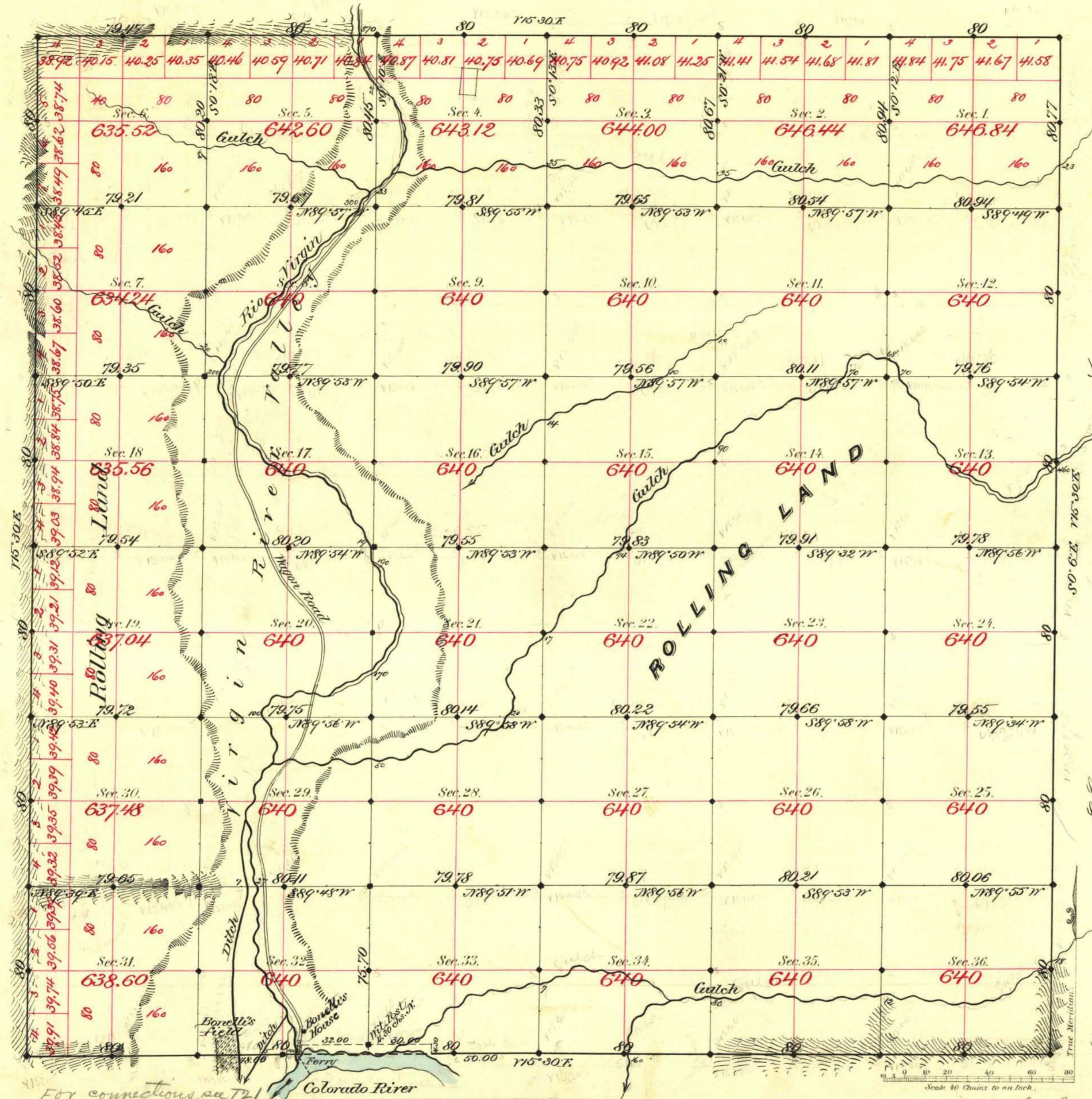

Aggregate Area of Public Land Surveyed 23,041.44 Ac.

Commenced July 27th 1882
Completed August 2nd "

Subdivisions run with a Var. of 15° 40' East.

For connections see T21

Surveys Designated	By Whom Surveyed	Date of Contract	Amount of Surveys	When Surveyed	77 th Cont.
N. 504	Woods & Myrick	Jan'y 20 th 1881	25- 79- 47	1881	109
S. 507	W. H. Myrick	May 20 th "	18- 00- 77	1882	139
Subdivs	"	"	59- 74- 09	July & Aug. "	"

The above Map of Township No. 20 South of Range No. 68 East
Mount Diablo Meridian is strictly conformable to the field
notes of the survey thereof on file in this Office, which have been examined and approved.
Surveyor General's Office. } *C. S. Davis*
New Nevada } Sur. Gen. Nevada
Sept. 18th 1882