

TOWNSHIP N°20 SOUTH, RANGE N°65 EAST OF THE MOUNT DIABLO MERIDIAN, NEVADA.

SUBDIVIDED IN 1882

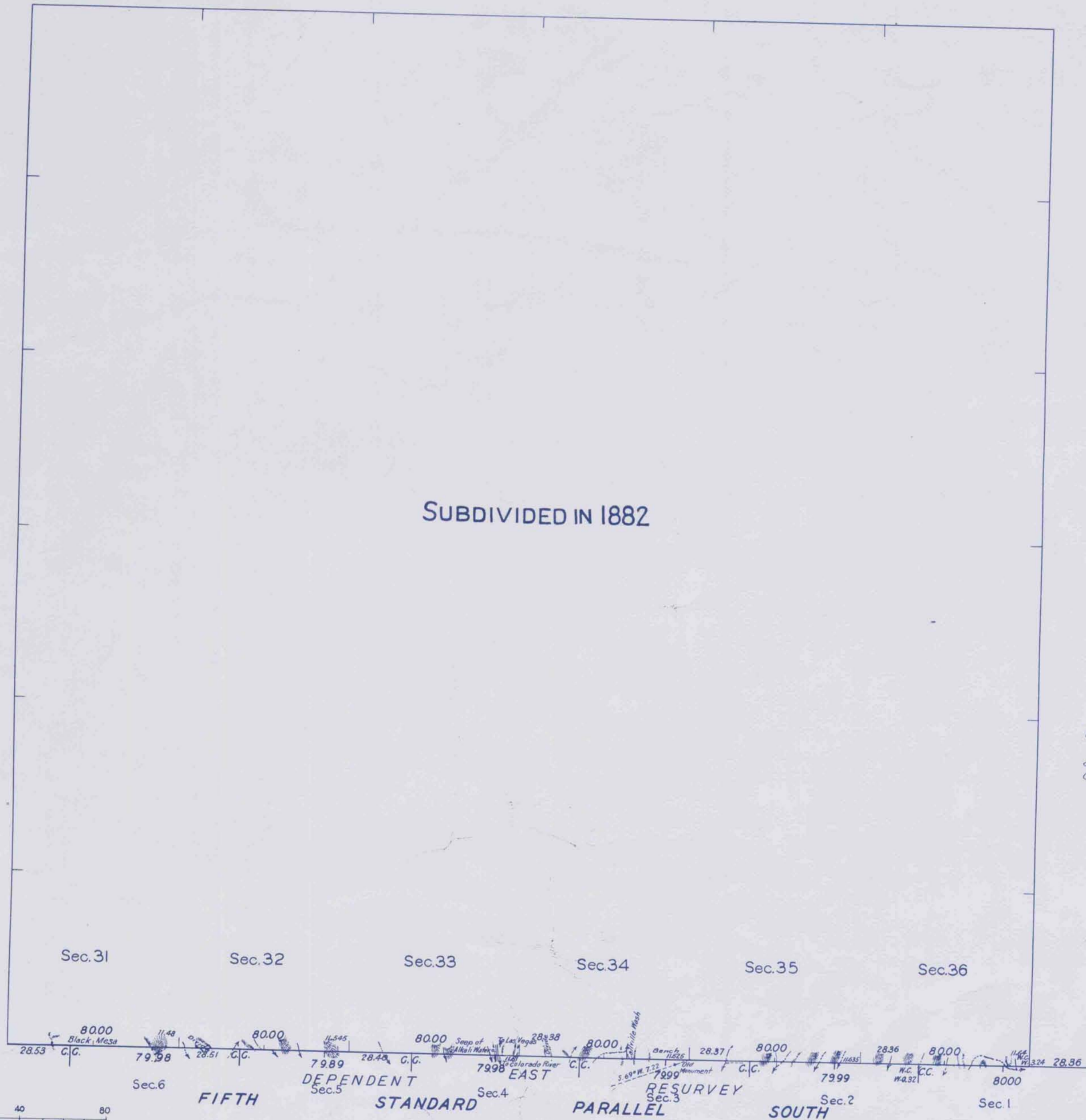

Note:
This resurvey was executed under
authority of letter 1403991-E-WHR-
dated March 9, 1931.



Latitude: 36° 09' 33" N.
Longitude: 114° 46' 30" W

Scale: 40 Chains to an Inch.

LINES DESIGNATED	BY WHOM SURVEYED	GROUP		MILEAGE		WHEN SURVEYED	
		N°	DATE	MLS.	CHS.	BEGUN	COMPLETED
Fifth Standard Parallel South	Carl S. Swanholm and Andrew Nelson.	169	April 10, 1931.	6	00	June 6, 1931.	June 16, 1931.

Office of U.S. Supervisor of Surveys.
Denver, Colorado, March 1, 1933.
The above plat of Township No. 20 South, Range No. 65
East of the Mount Diablo Meridian, Nevada,
is strictly conformable to the field notes of the survey
thereof which have been examined and approved.

DEPARTMENT OF THE INTERIOR
GENERAL LAND OFFICE
Washington, D.C., April 10, 1933
The survey represented by this plat
having been correctly executed in accordance
with the requirements of law and the regulations
of this office, is hereby accepted.

William H. Brown
U.S. Supervisor of Surveys.

D. C. Gandy
Acting Assistant Commissioner.

46.M.
A.R.J.

2997

SRWS
6/30