

1956 SEP 19 AM 11 39
BUREAU OF LAND MANAGEMENT
NEVADA STATE OFFICE
RENO, NEVADA

TOWNSHIP 20 NORTH, RANGE 64 EAST, MOUNT DIABLO MERIDIAN, NEVADA. DEPENDENT RESURVEY

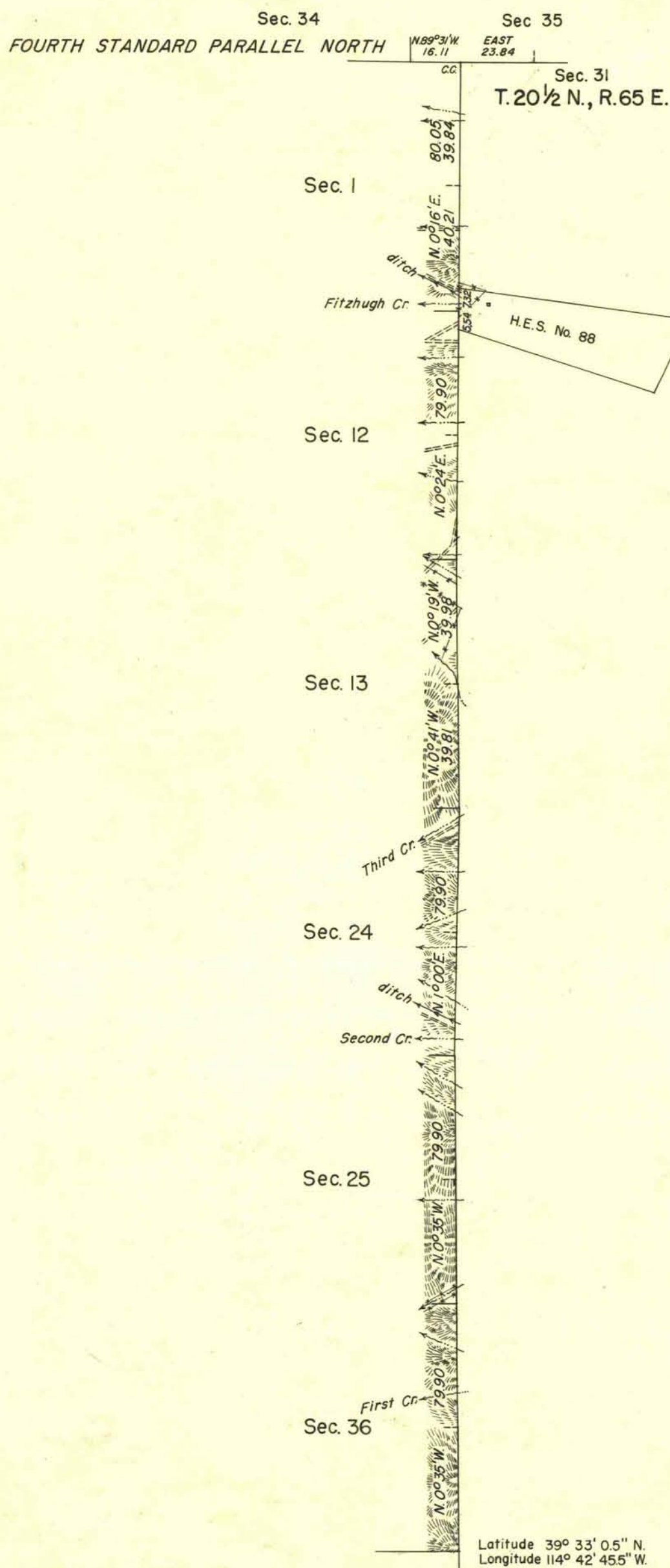

The east boundary was surveyed by E. B. Monroe and A. G. Bateman in 1872.

This plat represents the dependent resurvey of the east boundary of T. 20 N., R. 64 E., Mount Diablo Meridian, Nevada, designed to restore the corners in their original locations according to the best available evidence.

Survey executed by Emil Voigt and James W. Hardison, August 26 to October 17, 1943, under special instructions dated April 4, 1939 for Group 257, Nevada.

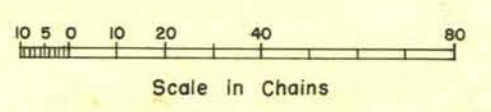

UNITED STATES DEPARTMENT OF THE INTERIOR
BUREAU OF LAND MANAGEMENT
Washington, D. C. March 28, 1956

This plat is strictly conformable to the approved field notes, and the survey, having been correctly executed in accordance with the requirements of law and the regulations of this Bureau, is hereby accepted.

For the Director
Earl B. Harrington
Cadastral Engineering Staff Officer

ABD

2870 A

T. 20 N., R. 64 E.

M.S. J.M.