

# TOWNSHIP NO 19 SOUTH, RANGE NO 64 EAST, OF THE MOUNT DIABLO MERIDIAN, NEVADA.

## INDEPENDENT RESURVEY

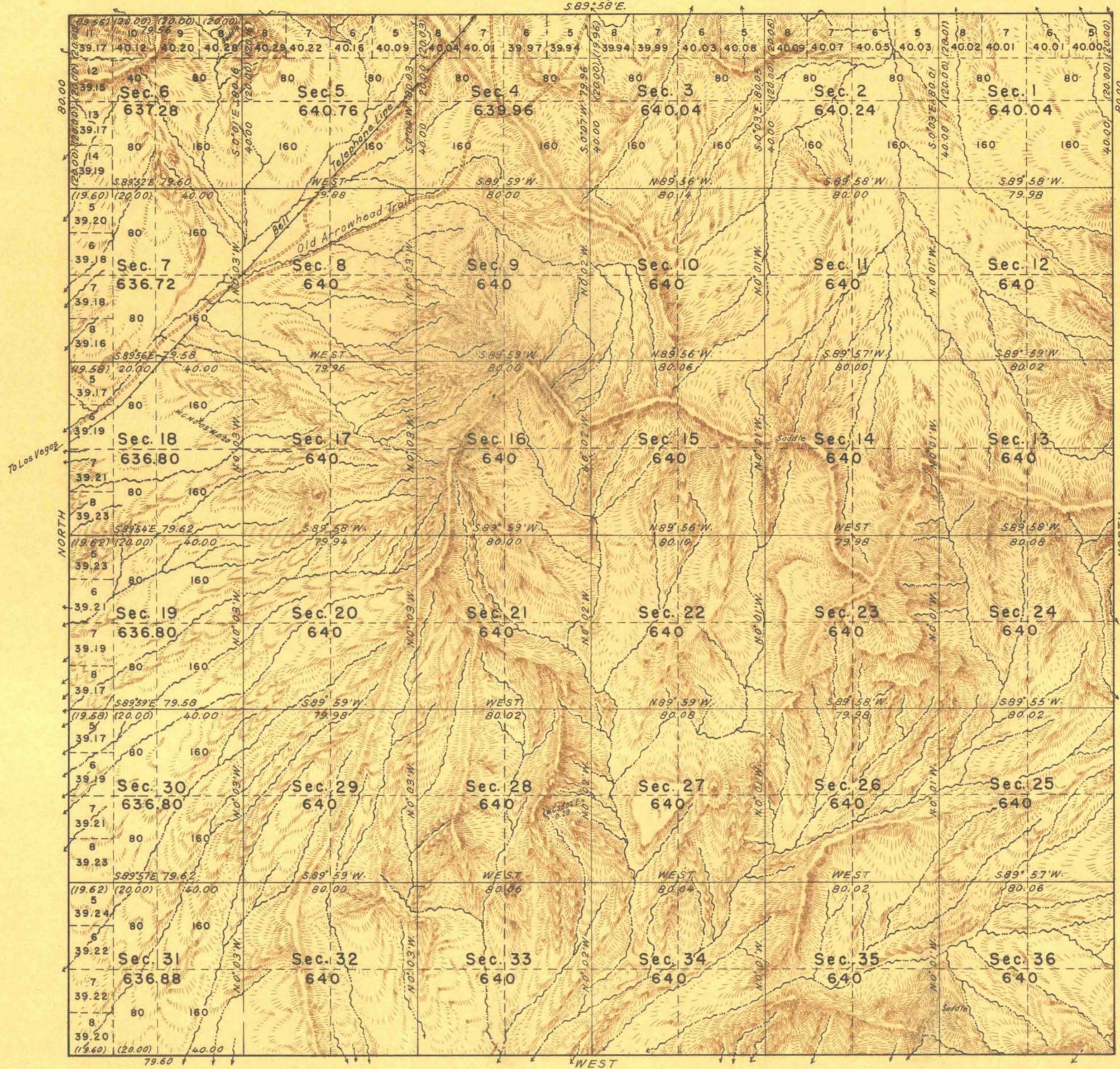

This resurvey was executed under authority of letter 1675821 E, dated March 23, 1937.

Latitude 36°15'N.  
Longitude 114°46.5'W.

UNITED STATES DEPARTMENT OF THE INTERIOR  
GENERAL LAND OFFICE

Denver, Colorado, Oct. 30, 1944  
The above plat of Township No. 19 South, Range No. 64 East, of the Mount Diablo Meridian, Nevada, is strictly conformable to the field notes of the resurvey thereof which have been examined and approved.

Washington, D.C., MAY 11, 1945  
The resurvey represented by this plat having been correctly executed in accordance with the requirements of law and the regulations of this office, is hereby accepted.

*W. H. Horton*  
Supervisor of Surveys.

*Joel David Wolfson*  
Assistant Commissioner.

Mean Magnetic Declination, 16°30'E. Scale: 1 Inch Equals 40 Chains. Area resurveyed, 23,022.32 Acres.

LINES DESIGNATED	BY WHOM SURVEYED	GROUP No.	DATE OF SPECIAL INSTRUCTIONS	WHEN SURVEYED	
				BEGUN	COMPLETED
Exterior, N&E	James W. Hardison, Wilson McConkie, & J. Glenn Dyer	237	November 4, 1937	Jan. 29, 1938	Feb. 12, 1938
Subdivisional					

Computed by Plot, P. & B.