

TOWNSHIP 19 SOUTH, RANGE 60 EAST, MOUNT DIABLO MERIDIAN, NEVADA
SUPPLEMENTAL PLAT OF SECTION 19

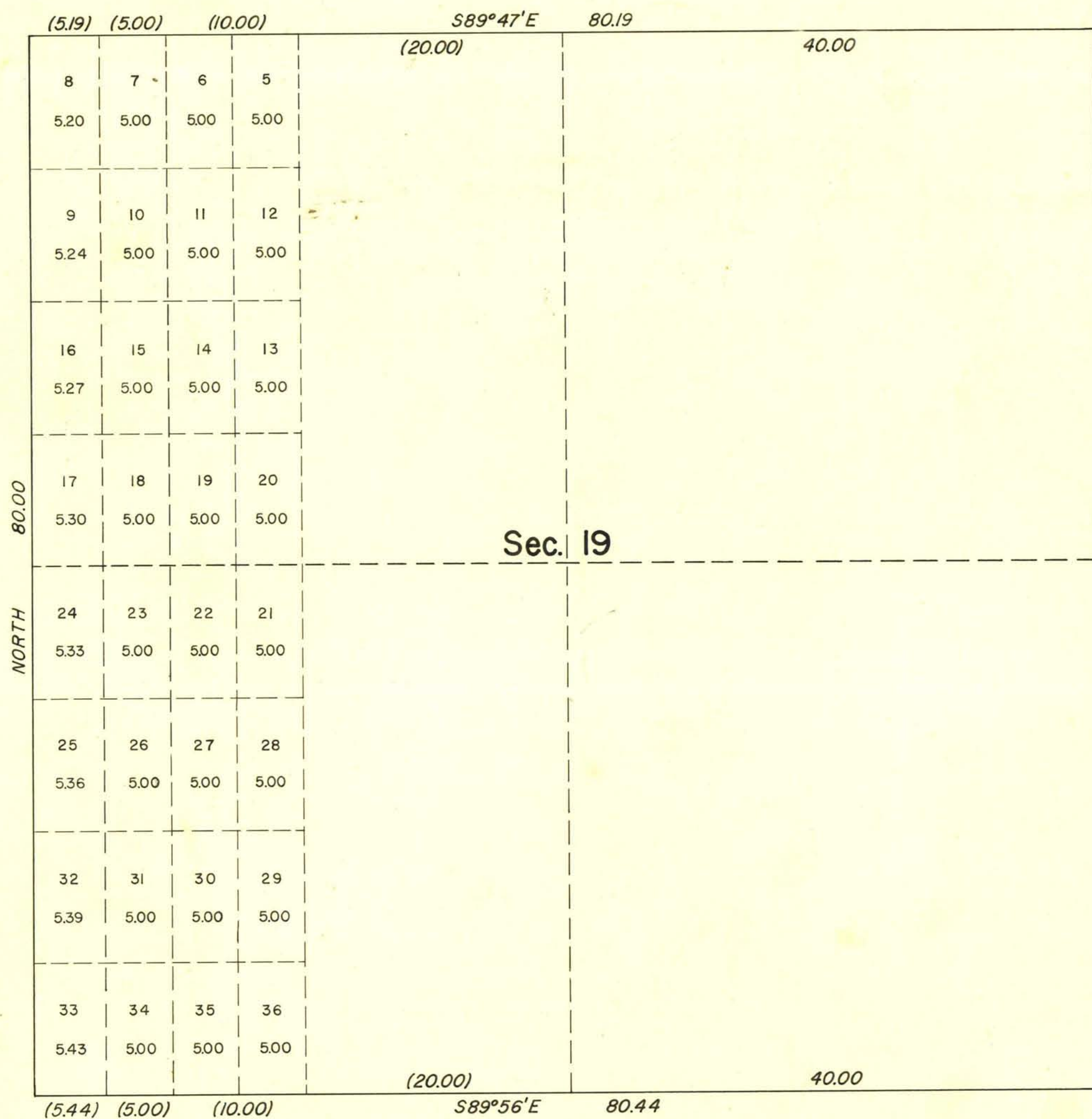

This plat showing a subdivision of original lots 1, 2, 3, and 4, is based upon the plat approved April 28, 1882.

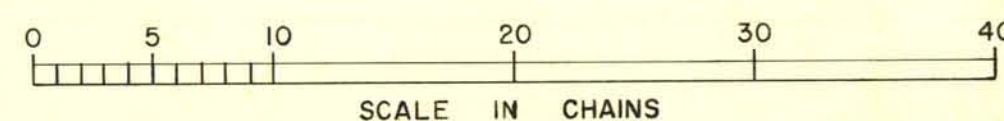

UNITED STATES DEPARTMENT OF THE INTERIOR
BUREAU OF LAND MANAGEMENT
Washington, D. C. June 29, 1955

This plat showing amended lottings, having been correctly prepared in accordance with the regulations, is hereby accepted.

For the Director
Carl G. Harrington
Cadastral Engineering Staff Officer