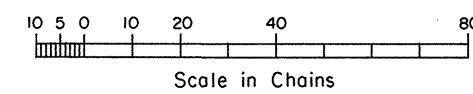
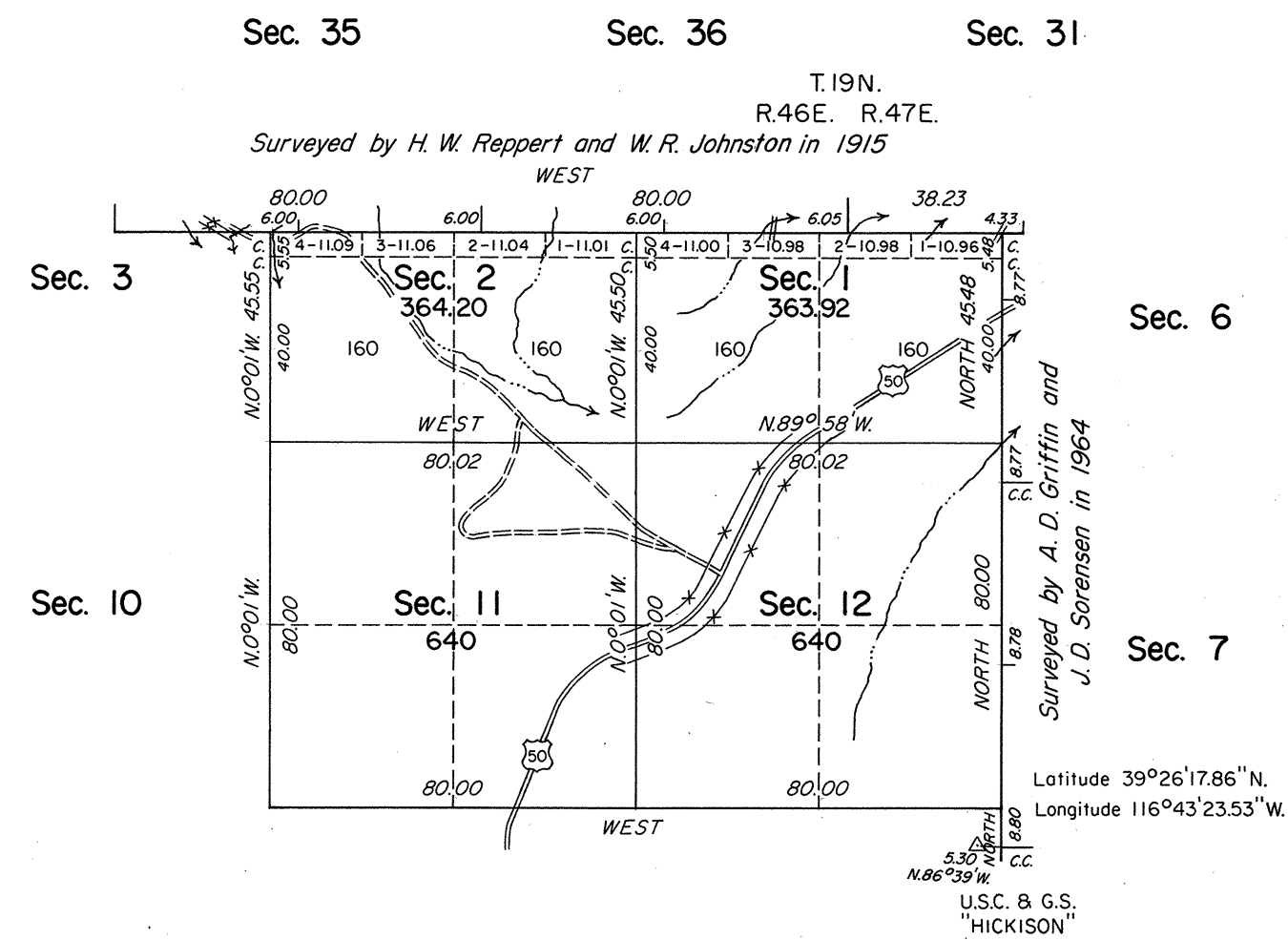
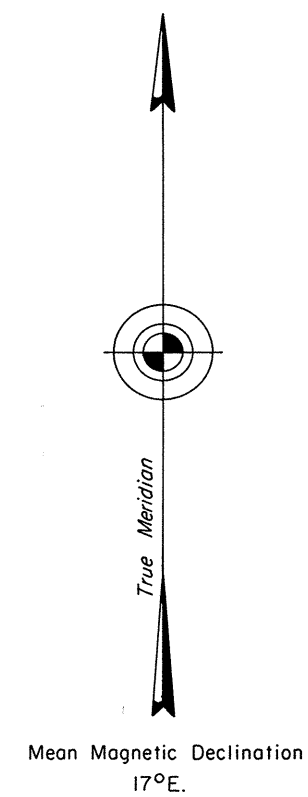

TOWNSHIP 18 $\frac{1}{2}$ NORTH, RANGE 46 EAST, OF THE MOUNT DIABLO MERIDIAN, NEVADA

Area Surveyed - 2,008.12 Acres

A history of surveys is contained in the field notes.

This plat represents the survey of a portion of the south boundary and a portion of the subdivisional lines of T. 18 $\frac{1}{2}$ N., R. 46 E., Mount Diablo Meridian, Nevada.

Survey executed by Ronald K. Baugh, Cadastral Surveyor, beginning May 8, 1978, and completed May 16, 1978, pursuant to Special Instructions dated April 7, 1978, for Group No. 561, Nevada.

UNITED STATES DEPARTMENT OF THE INTERIOR
BUREAU OF LAND MANAGEMENT
Denver, Colorado March 10, 1980

This plat is strictly conformable to the approved field notes, and the survey, having been correctly executed in accordance with the requirements of law and the regulations of this Bureau, is hereby accepted.

For the Director

Chief, Cadastral Survey
Examination and Approval Staff