

TOWNSHIP N^o 18 SOUTH RANGE N^o 68 EAST MOUNT DIABLO MERIDIAN

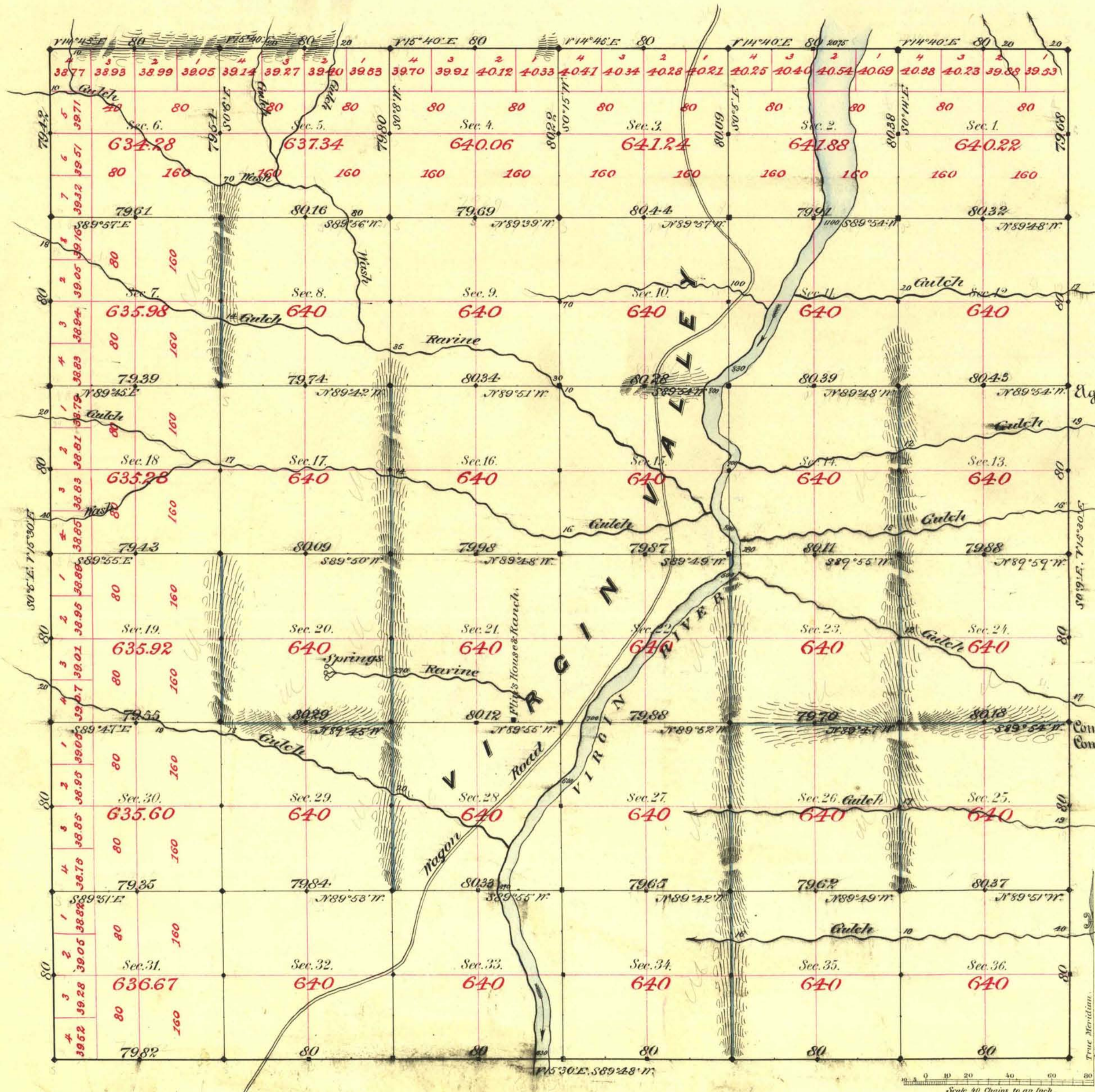

Aggregate Area of Public Land surveyed 23014.47 Acres

Commenced November 14th 1881
Completed 1882

Subdivisions run with a Variation of 15° 30' East.

Survey Designated	By Whom Surveyed	Date of Contract	Amount of Survey	When Surveyed
Commissaries	Wood & Myrick	Jan. 20 th 1881	28 - 78 - 92	1881
Subdiv ^{ns} black	"	"	45 - 78 - 80	November
blue	"	"	14 - 00 - 17	"

379 Cont
109
"

The above Map of Township N. 18 South of Range N. 68 East of Mount Diablo Meridian is strictly conformable to the field notes of the survey thereof on file in this Office, which have been examined and approved.
Surveyor General's Office,
Reno, Nevada.
March 27th 1882

W. H. Parry
Sur. Gen. Nev.