

TOWNSHIP 18 SOUTH, RANGE 66 1/2 EAST, OF THE MOUNT DIABLO MERIDIAN, NEVADA

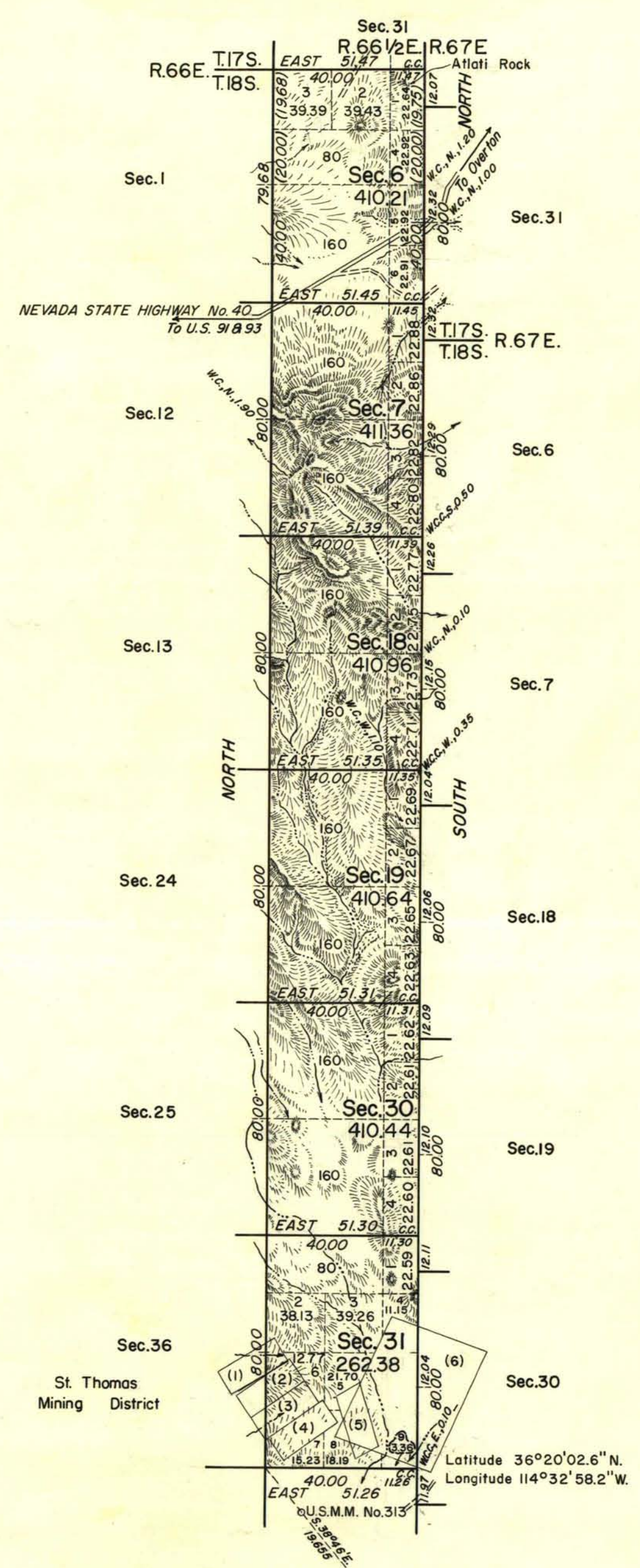

SURVEYED		MINING CLAIMS	
Index No.	Survey No.	Name of Claim	
1	4623	EAST A.B.A. No.4	
2	4645	LIBERTY No.2	
3	4645	LIBERTY No.3	
4	4645	LIBERTY No.4	
5	4647	ARGUS	
6	4648	COTTON BALL No.3 PLACER	

History of earlier surveys is contained in the field notes.

Survey of the north and south boundaries and subdivisional lines of T. 18 S., R. 66 1/2 E., Mount Diablo Meridian, Nevada, executed by Dell Cazier, March 31 and April 1, 1959 under special instructions dated June 5, 1958 for Group 373, Nevada.

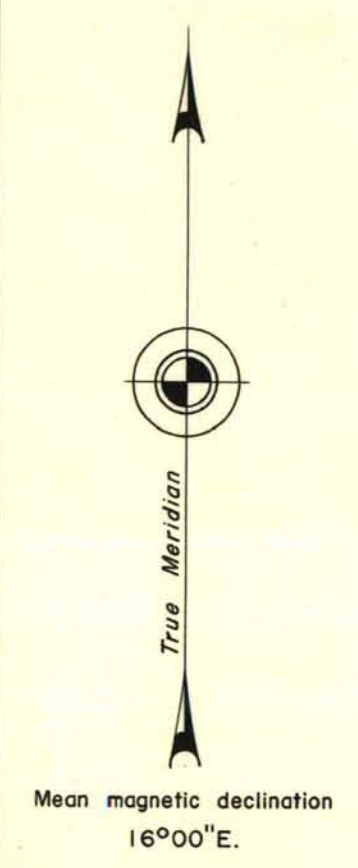

St. Thomas
Mining District

UNITED STATES DEPARTMENT OF THE INTERIOR
BUREAU OF LAND MANAGEMENT
Washington, D.C. September 27, 1961

This plat is strictly conformable to the approved field notes, and the survey, having been correctly executed in accordance with the requirements of law and the regulations of this Bureau, is hereby accepted.

For the Director
E. J. Remington
Chief, Division of Engineering

Scale in Chains
Area Surveyed = 2,315.99 Acres
Area Segregated = 147.86 Acres
Total = 2,463.85 Acres

3076-10

T. 18 S., R. 66 1/2 E.