

# TOWNSHIP 17 SOUTH, RANGE 66 EAST, OF THE MOUNT DIABLO MERIDIAN, NEVADA

## INDEPENDENT RESURVEY

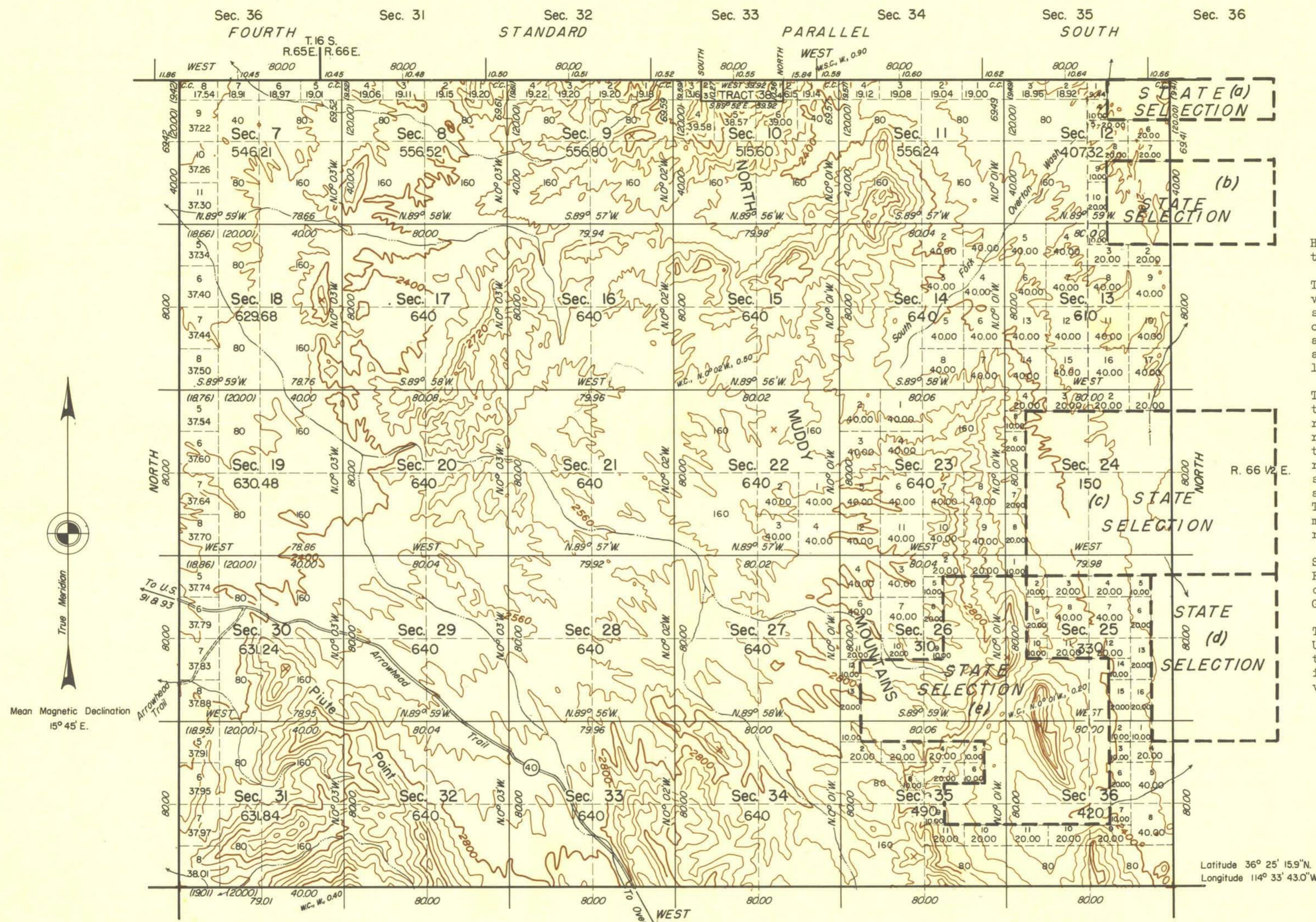

History of earlier surveys is contained in the field notes:

This plat represents an independent resurvey of the south and east boundaries and subdivisional lines which is independent of and supersedes, as far as public lands are concerned, all such similar units that are shown upon plat approved September 18, 1882.

Tract 38 shown hereon and all state selections shown to conform to the lines of the resurvey in terms of new legal subdivisions represent the position and form of said tracts under the original description as referred to the original survey located as such on the ground according to the best available evidence of the true position. The legal descriptions of these lands remain in terms of the original survey plat referred to above.

Survey executed by Craig P. Sylvester, February 18 to March 18, 1959, under special instructions dated June 5, 1958 for Group 373, Nevada.

Topography on this plat furnished by the U. S. Geological Survey. For additional topography along surveyed lines, reference is made to the field notes. Contour interval is 80 feet.

INDEX TO TRACT SEGREGATION

No.	Entry	Original Survey Description
38	M.E. Carson City 014389	Lots 5 and 6, Sec. 4, T. 17 S., R. 66 E.

INDEX TO CONFORMED TRACTS

Entry	Index	Original Survey Description
State Selection, Carson City 017453	(a)	Lots 1, 2, 3, and 4, Sec. 1, T. 17 S., R. 66 E.
State Selection, Carson City 017453	(b)	S $\frac{1}{2}$ Sec. 1, T. 17 S., R. 66 E.
State Selection, Carson City 017453	(c)	All sec. 13, E $\frac{1}{2}$ Sec. 14, T. 17 S., R. 66 E.
State Selection, Carson City 017453	(d)	E $\frac{1}{2}$ and E $\frac{1}{2}$ W $\frac{1}{2}$ Sec. 24, T. 17 S., R. 66 E.
State Selection, Carson City 017453	(e)	SE $\frac{1}{4}$ Sec. 22, W $\frac{1}{2}$ and SE $\frac{1}{4}$ Sec. 23, NE $\frac{1}{4}$ , E $\frac{1}{2}$ NW $\frac{1}{4}$ , and NW $\frac{1}{4}$ NW $\frac{1}{4}$ Sec. 26, T. 17 S., R. 66 E.

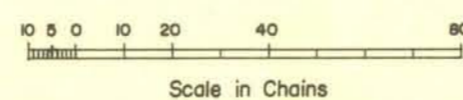

Area resurveyed 16,931.93 Acres  
Area segregated 1,719.44 "  
Total Area 18,651.37 "

UNITED STATES DEPARTMENT OF THE INTERIOR  
BUREAU OF LAND MANAGEMENT  
Washington, D.C.    September 27, 1961

This plat is strictly conformable to the approved field notes, and the survey, having been correctly executed in accordance with the requirements of law and the regulations of this Bureau, is hereby accepted.

For the Director

*E. Remington*  
Chief, Division of Engineering

3076-A

T. 17 S., R. 66 E.

J.P.H.