

TOWNSHIP N<sup>o</sup> 17 SOUTH, RANGE N<sup>o</sup> 64 EAST, OF THE MOUNT DIABLO MERIDIAN, NEVADA.  
INDEPENDENT RESURVEY WITH TRACT SEGREGATIONS

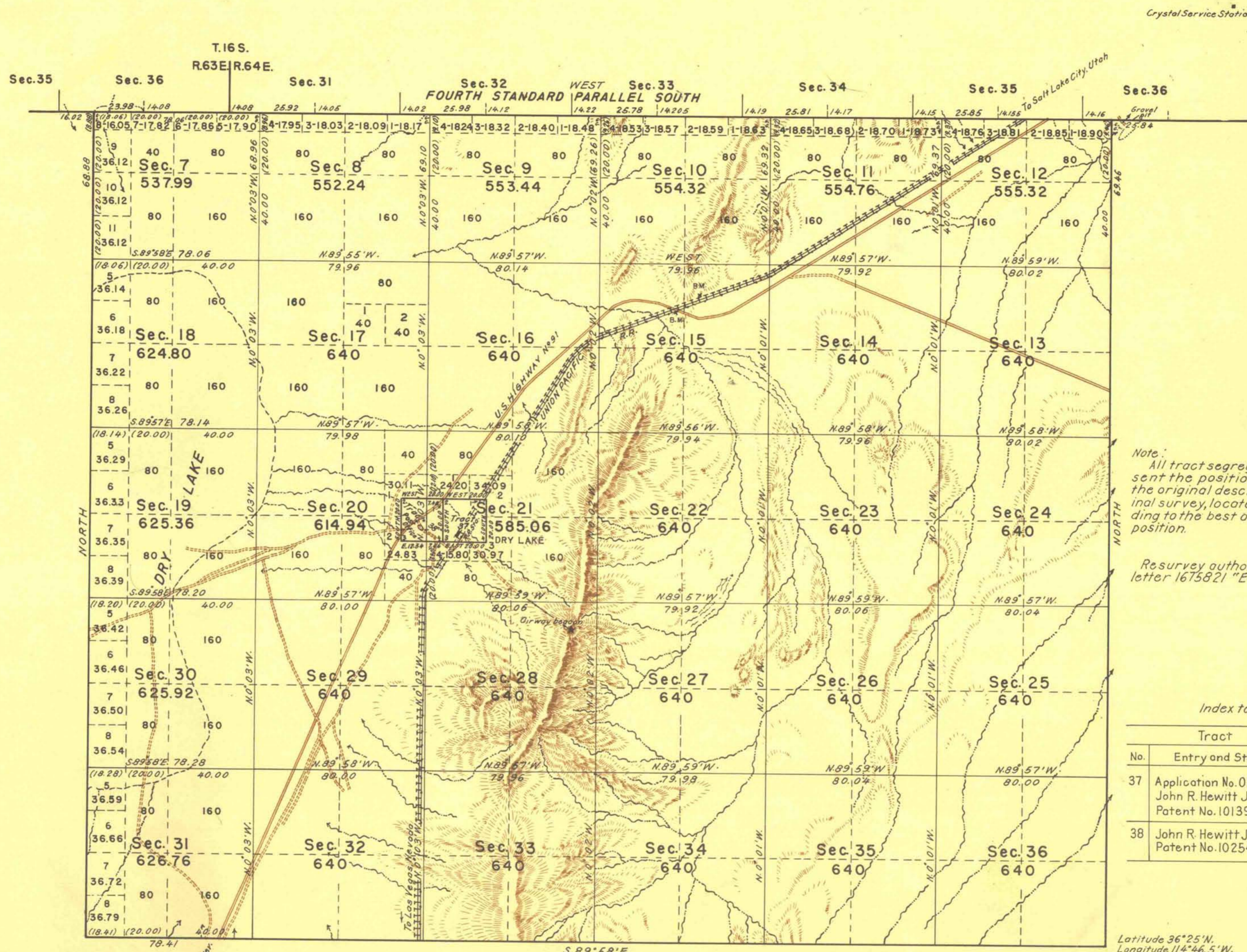

Note: All tract segregations shown hereon represent the position and form of said tracts under the original description as referred to the original survey, located as such on the ground according to the best available evidence of their true position.

Resurvey authorized by General Land Office letter 1675821 "E" dated March 23, 1937.

Index to Segregated Tracts

No.	Tract	Original Survey			
		Entry and Status	Tp.	Rg.	Sec.
37	Application No. 015688 John R. Hewitt Jr. Patent No. 1013908	17S. 64E. 17			SE 1/4 NE 1/4
38	John R. Hewitt Jr. Patent No. 1025448	17S. 64E. 17			SW 1/4 NE 1/4

Latitude 36° 25' N.  
Longitude 114° 46.5' W.

Mean Magnetic Declination, 16° 30' E.  
Scale: 1 Inch Equals 40 Chains

Area of tract segregations, 80.00 Acres.  
Area exclusive of tract segregations, 18,530.91  
Total area of township, 18,610.91

UNITED STATES DEPARTMENT OF THE INTERIOR  
GENERAL LAND OFFICE

LINES DESIGNATED	BY WHOM SURVEYED	GROUP No.	DATE OF SPECIAL INSTRUCTIONS	WHEN SURVEYED	
				BEGUN	COMPLETED
Exterior E & W Subdivisional Miscellaneous	James W. Hardison, Wilson McConkie, & J. Glenn Dyer	237	November 4, 1937	Mar. 21, 1938	April 14, 1938

Denver, Colorado, Oct. 30, 1944.  
This plat of Township No. 17 South, Range No. 64 East, of the Mount Diablo Meridian, Nevada, is strictly conformable to the field notes of the resurvey thereof which have been examined and approved.

Washington, D.C., MAY 11, 1945  
The resurvey represented by this plat having been correctly executed in accordance with the requirements of law and the regulations of this office, is hereby accepted.

*W. H. ...*  
Supervisor of Surveys

*Joel David Wolfson*  
Assistant Commissioner