

TOWNSHIP N^o 17 SOUTH RANGE N^o 62 EAST MOUNT DIABLO MERIDIAN

Moapa National Forest

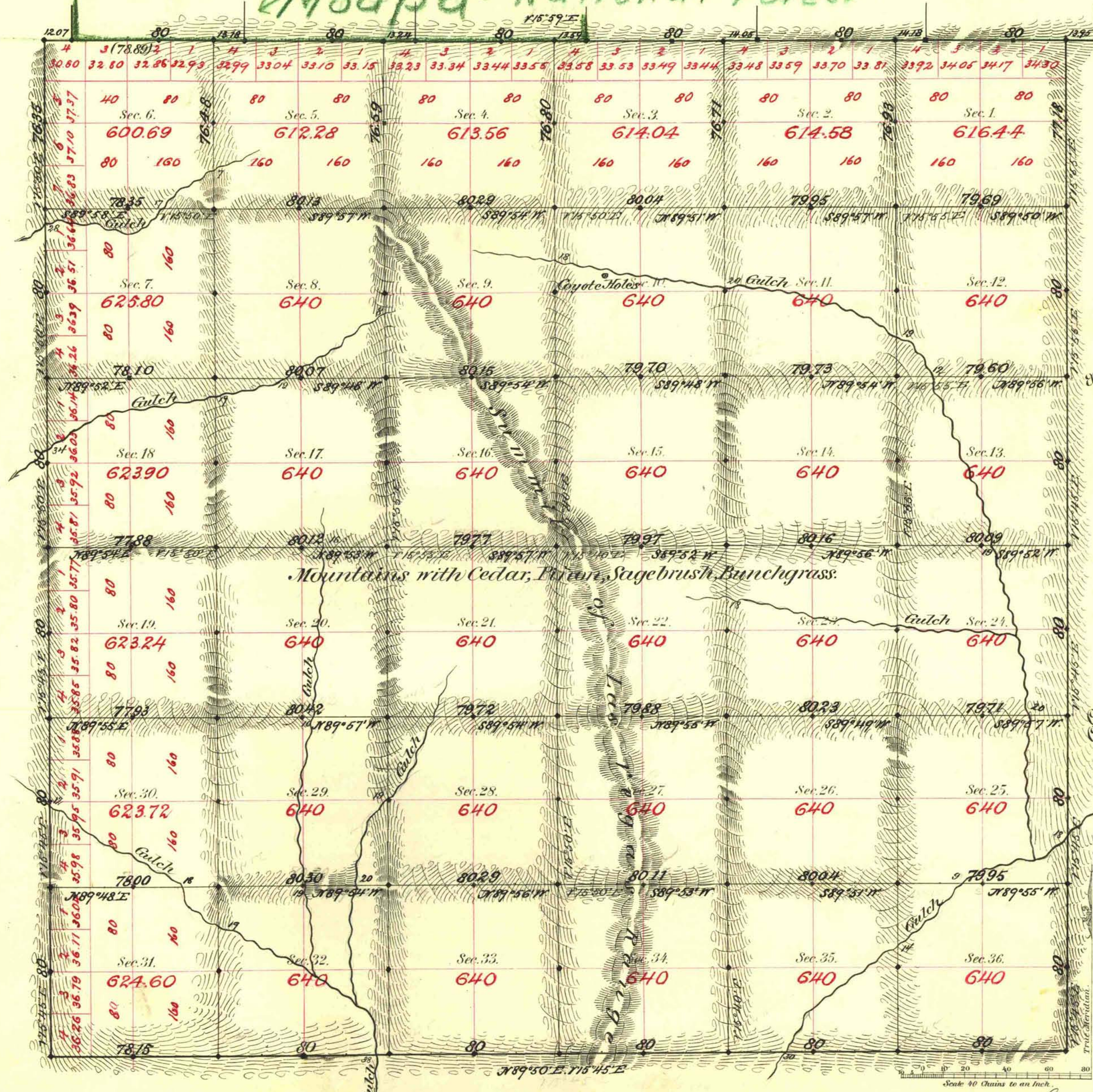

Aggregate Area of Public Land surveyed 22792.85 Acres.

Commenced March 1st 1882.
Completed " 7th "

Subdivisions not noted run with a Variation of 15° 45' East.

Surveys Designated	By Whom Surveyed	Date of Contract	Amount of Surveys	When Surveyed
N. Boundary	Woods & Myrick	Jan. 20 th 1881	6 ^m 00 ^{ch} 00 ^{ac}	1881
E. N. & S.	"	" 28 th "	17-71-68	1882
Subdivisions	"	"	59-53-88	March
Convergency	"	"	58-24	"

7th Cor.
109
111

The above Map of Township N. 17 South of Range N. 62 East of Mount Diablo Meridian is strictly conformable to the field notes of the survey thereof on file in this Office, which have been examined and approved.

Surveyor General's Office,
Terr. Nevada
April 28th 1882.

W. C. Davis
Sur. Gen. Nevada