

TOWNSHIP N° 16 NORTH, RANGE N° 45½ EAST OF THE MOUNT DIABLO MERIDIAN, NEVADA.

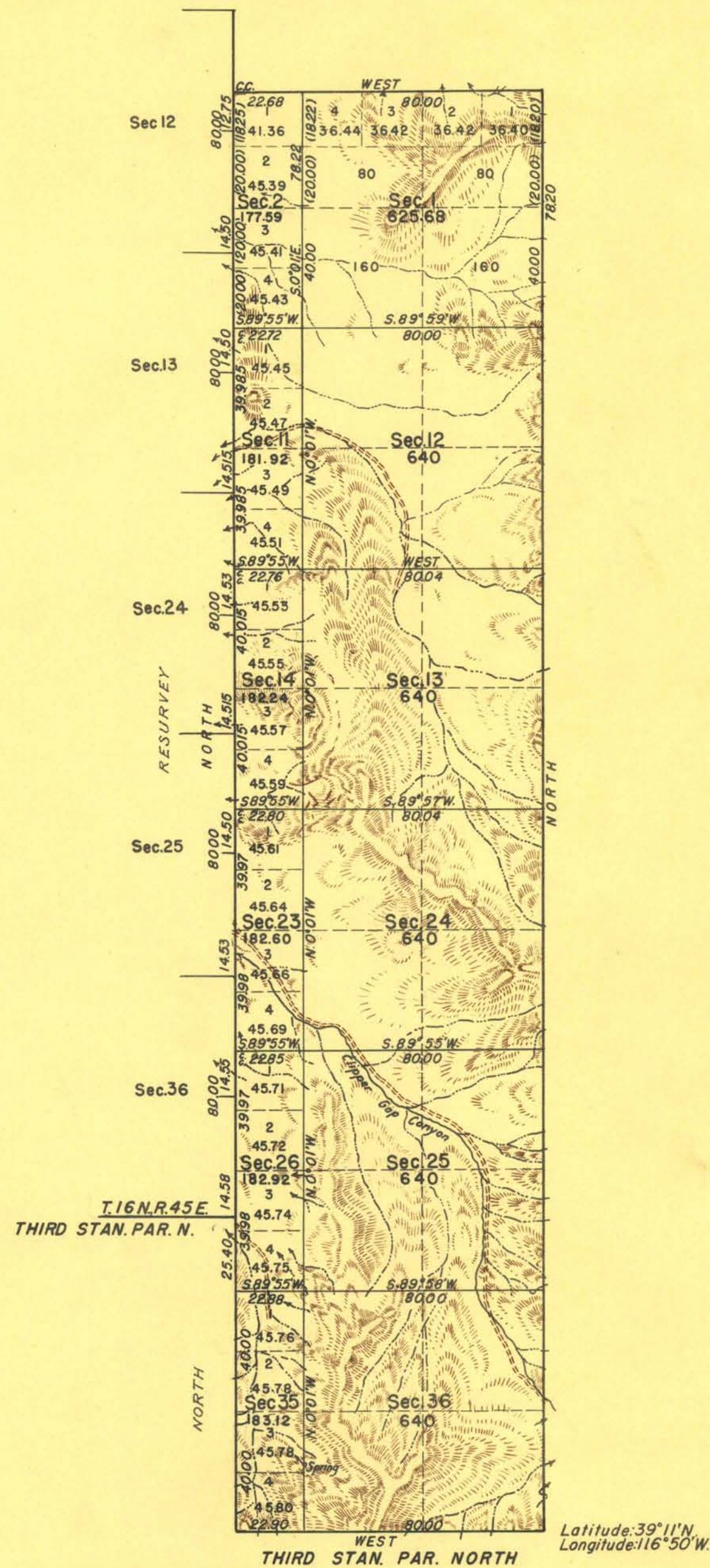

Scale: 40 Chains to an Inch.

Area Surveyed 4,916.07 Acres.

LINES DESIGNATED	BY WHOM SURVEYED	GROUP		MILEAGE		WHEN SURVEYED	
		Nº	DATE	MLS.	CHS.	BEGUN	COMPLETED
Exterior	Carl S. Swanholm	176	March 3, 1933.	14	41.93	July 29, 1937.	Aug. 16, 1937.
Subdivisional	James W. Hardison	"	" " "	12	31.31	" " "	" " "
Miscellaneous		"	" " "		72.64	" " "	" " "

OFFICE OF SUPERVISOR OF SURVEYS
DENVER, COLORADO, JULY 1, 1941.
THE ABOVE PLAT OF TOWNSHIP NO. 16 NORTH, RANGE
NO. 45½ EAST OF THE MOUNT DIABLO MERIDIAN, NEVADA,
IS STRICTLY CONFORMABLE TO THE FIELD NOTES OF
THE SURVEY THEREOF WHICH HAVE BEEN EXAMINED AND
APPROVED.

Oran A. Johnson

SUPERVISOR OF SURVEYS.

UNITED STATES
DEPARTMENT OF THE INTERIOR
GENERAL LAND OFFICE
WASHINGTON, D.C., JULY 11, 1941.
THE SURVEY REPRESENTED BY THIS PLAT
HAVING BEEN CORRECTLY EXECUTED IN ACCORDANCE WITH
THE REQUIREMENTS OF LAW AND THE REGULATIONS OF
THIS OFFICE, IS HEREBY ACCEPTED.

Joel David Wolfson
ASSISTANT COMMISSIONER.