

T.16N. R.21E. M.D.M. NEVADA.

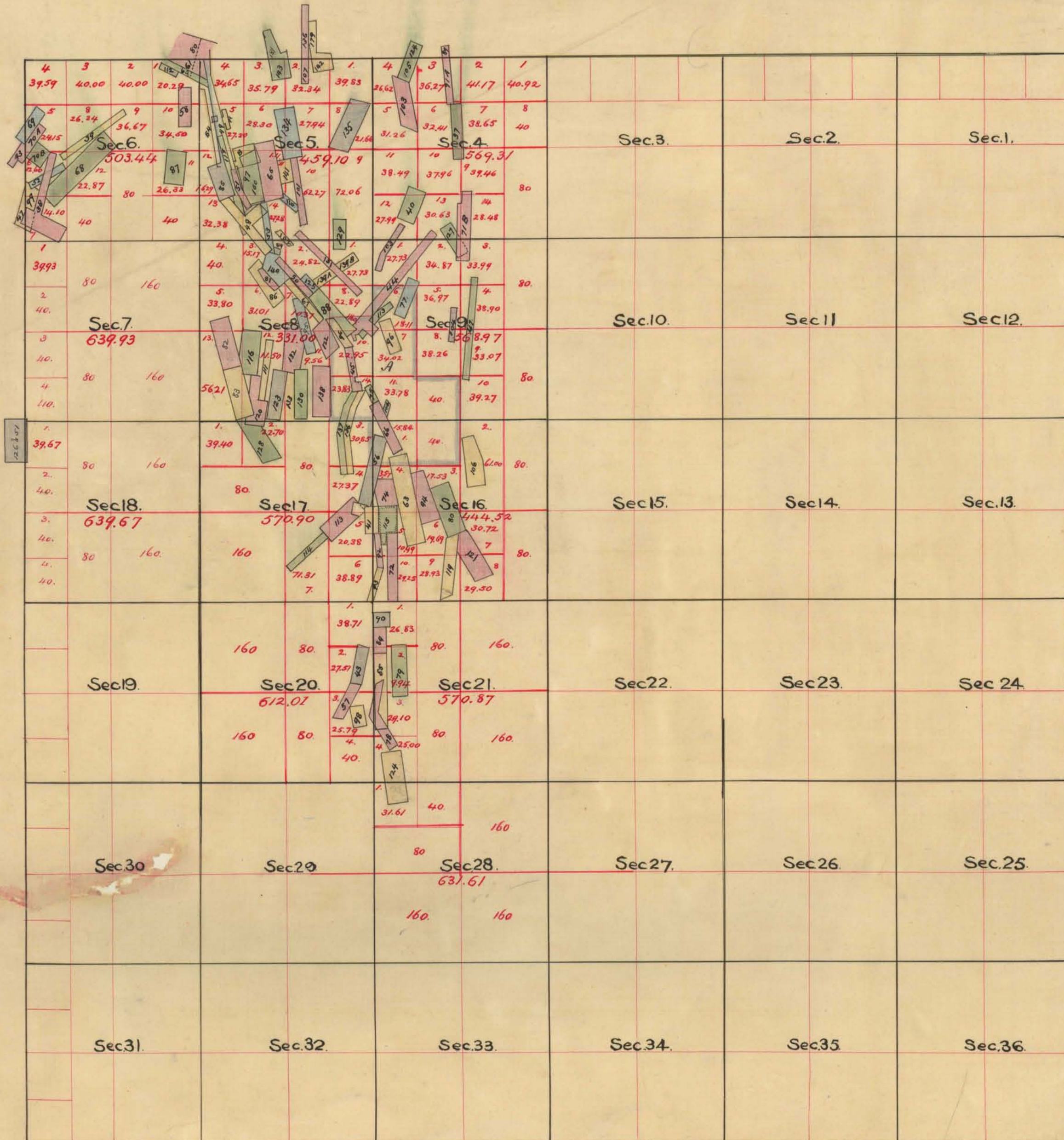

The above map delineates the location of mineral claims in Township No. 16 North Range No. 21 East Mount Diablo Meridian and is strictly conformable to the field notes of surveys thereof on file in this office which have been examined and approved.
 U.S. Surveyor Genl's Office,
 Virginia City Nev.
 July 27th 1880.

E. J. Davis
 U.S. Surveyor Genl of Nev.