

TOWNSHIP N^o 15 NORTH RANGE N^o 39 EAST MOUNT DIABLO MERIDIAN

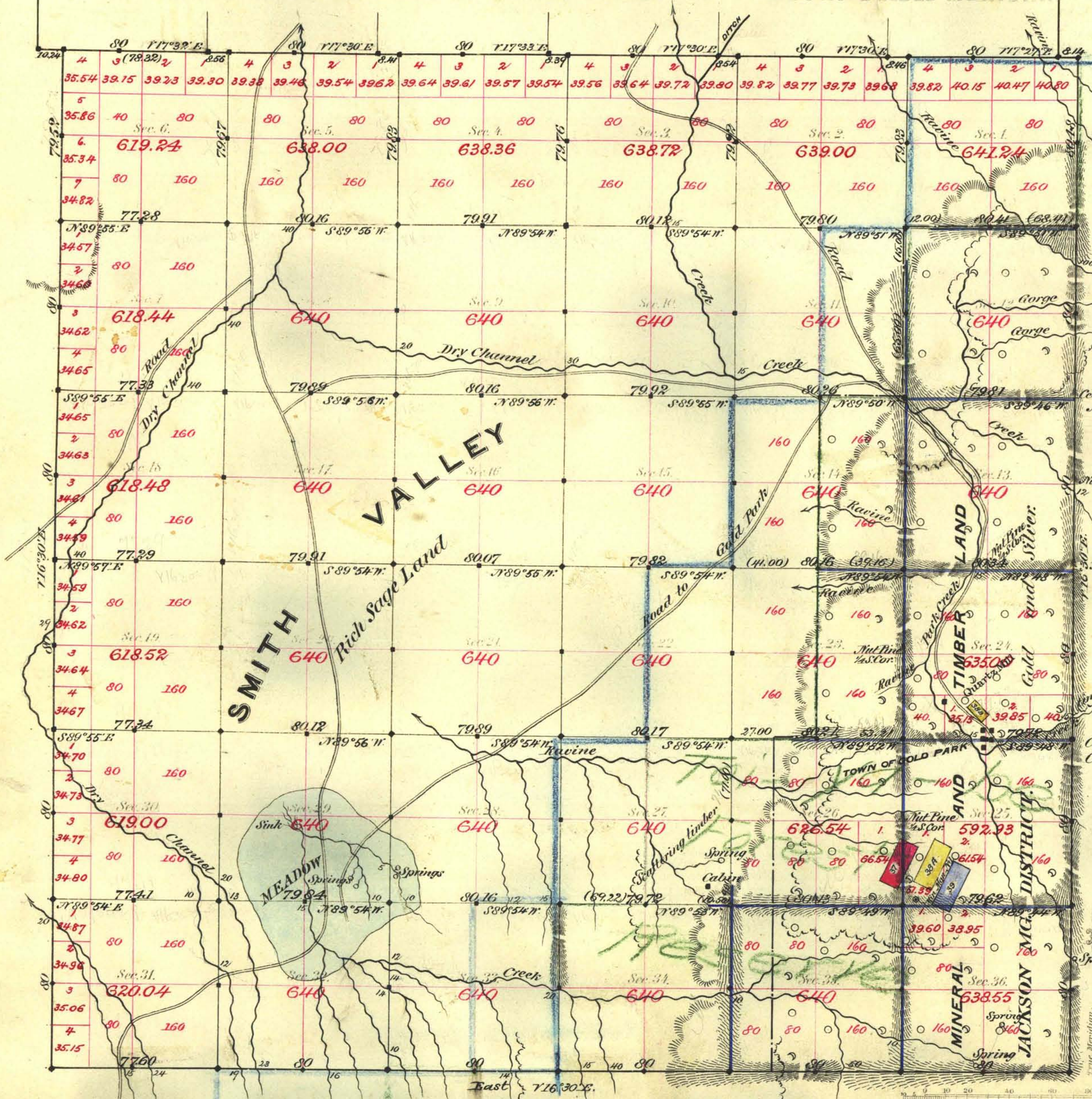

| N ^o | Claim. | Lode. | Acres. | Approval. |
|----------------|-------------------|------------------|--------|----------------|
| 37 | E. Bradley et al. | San Francisco | 20.66 | March 11, 1881 |
| 38, 45, B | R. Desmond | Star of the West | 25.66 | " 10 " |
| 39 | " | Arctic | 20.66 | " 11 " |

Aggregate Area of Public Land Surveyed 18109.04 Acres.
 " " " Mineral " 4800.00 "
 " " " Aggregate " 22909.04 "

Commenced April 11th 1883.
 Completed " 18th "

Subdivisions run with a Variation of 16'30" East.

| Surveys Designated | By Whom Surveyed | Date of Contract | Amount of Surveys | When Surveyed |
|----------------------------|--------------------|-----------------------------|-------------------|---------------|
| North Boundary | Barkere, McClellan | July 15 th 1879 | 6-00-00 | 1879 |
| E. T. & S. | Stewart & Morrison | March 21 st 1883 | 17-77-60 | 1883 |
| Subdiv ^{ns} black | " | " | 46-61-08 | April 1883 |
| blue | " | " | 13-04-90 | " |
| Convergenc ^y | " | " | 42-36 | " |
| | | | 79-65-93 | |

968 Cov.
 89
 164
 "
 "

The above Map of Township N^o 15 North of Range N^o 39 East of Mount Diablo Meridian is strictly conformable to the field notes of the survey thereof on file in this Office, which have been examined and approved.
 Surveyor General's Office, Reno, Nevada
 June 14th 1883
 C. C. Conning, Sur. Gen. Nevada