

TOWNSHIP N^o 13 NORTH RANGE N^o 22 EAST MOUNT DIABLO MERIDIAN

1.16" 30.2.1.

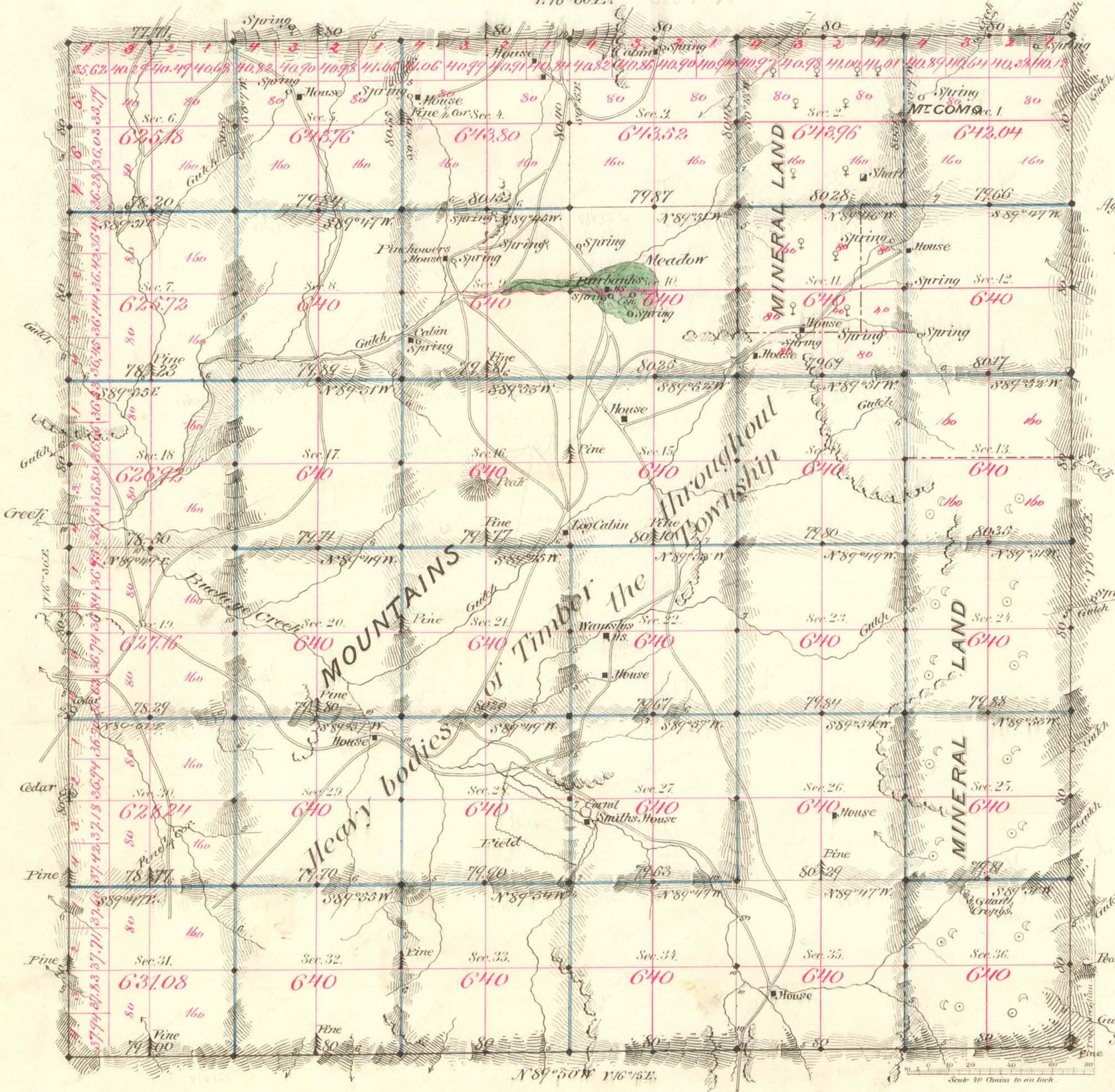

| | | |
|---|----------|-------|
| Aggregate Area of Public Lands Surveyed | 19897.42 | Acres |
| " " " Mineral " | 3083.96 | " |
| " " " " | 22981.38 | " |

Surveys Commenced July 22nd 1881
Completed " 30th

Subdivisions run with Variation 16" 16'E

| Survey Designated | By Whom Surveyed | Date of Contract | Amount of Surveys | When Surveyed | N ^o Cont |
|-----------------------|----------------------|----------------------------|-------------------|---------------|---------------------|
| Tn. Lines | Stewart & Consulting | June 15 th 1881 | N 22 75 71 | 1881 | 129 |
| Subdivisions 17x6x8 " | " | " | 5 72 06 | July " | " |
| " 17x6 " | " | " | 52 73 02 | " | " |

The above Map of Township N^o 13 North of Range N^o 22 East Mount Diablo Meridian is strictly conformable to the field notes of the survey thereof on file in this Office, which have been examined and approved.

Surveyor General's Office,
Virginia City Nevada -
October 27th 1881.

W. A. Parry
Sur. Genl.