

Township N^o 12 North

Range N^o 6 East

Mount Diablo Meridian

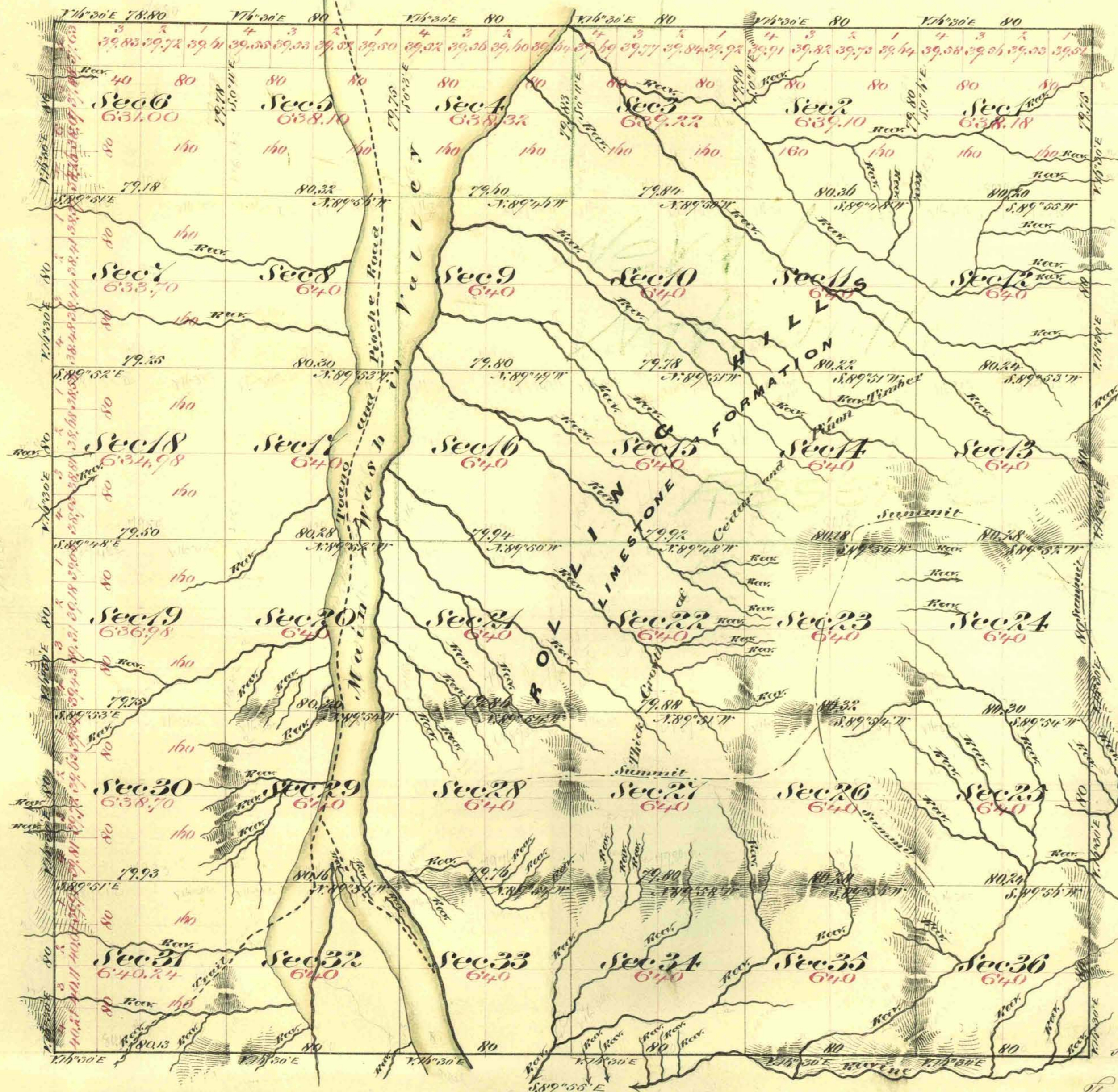

Aggregate Area of Public Land 23,008.52 Acres

Commenced December 21st 1874
Completed " 26th 1874

Subdivision lines not otherwise noted run with a variation of 1/2^o East

| Surveys Designated | By Whom Surveyed | Date of Contract | Acres of Survey | When Surveyed | N ^o Cont. |
|-----------------------------|------------------------------|--|-----------------|------------------------|----------------------|
| N ^o 4 N Boundary | E. S. Moore & A. S. Waterman | Nov ^{br} 1 st 1874 | 11 78 80 | 1872 | 48 |
| S ^o 4 E " | " " " " " | July 24 th 1874 | 11 79 88 | 1874 | 63 |
| Subdivision lines | " " " " " | " " " | 59 78 81 | Dec ^{br} 1874 | " |

The above Map of Township N^o 12 North, Range N^o 6 East, Mount Diablo Meridian is strictly conformable to the field notes of the Surveyors hereof on file in this Office, which have been examined and approved by the Surveyor General's Office, Virginia City, Nevada, May 4th 1875