

TOWNSHIP 12 NORTH, RANGE 56 EAST, MOUNT DIABLO MERIDIAN, NEVADA
DEPENDENT RESURVEY

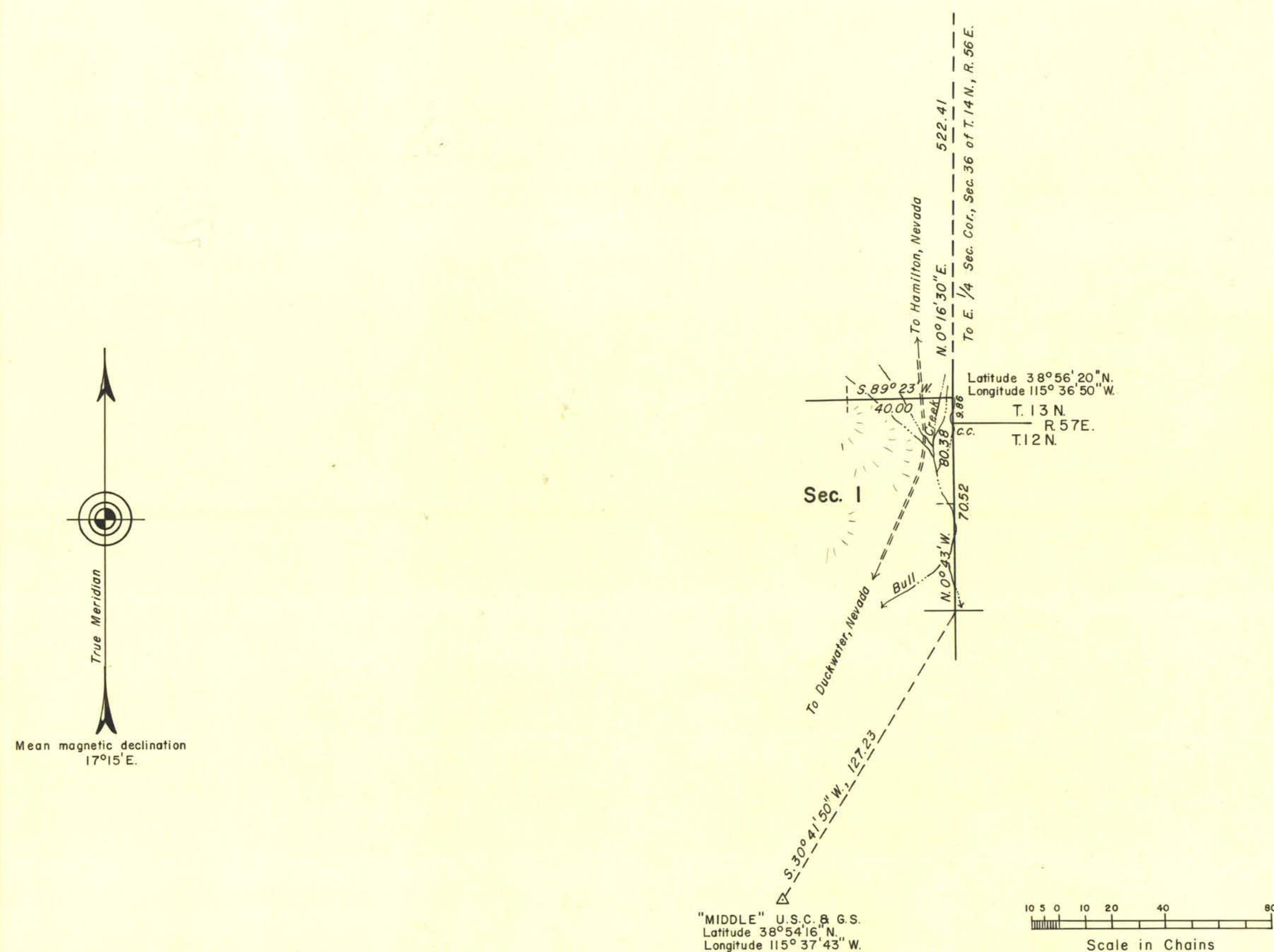

The north and east boundaries were surveyed by E. B. Monroe in 1870.

This plat represents a dependent re-survey of the east boundary and the east half of the north boundary of sec. 1, T. 12 N., R. 56 E., Mt. Diablo Meridian, Nevada, designed to restore the corners in their original locations according to the best available evidence.

Survey executed by Emil Voigt, May 6 to June 26, 1941, under special instructions dated May 26, 1939, for Group 261, Nevada.

UNITED STATES DEPARTMENT OF THE INTERIOR
BUREAU OF LAND MANAGEMENT
Washington, D. C. December 5, 1956

This plat is strictly conformable to the approved field notes, and the survey, having been correctly executed in accordance with the requirements of law and the regulations of this Bureau, is hereby accepted.

For the Director

Earl G. Harrington
Cadastral Engineering Staff Officer