

TOWNSHIP N^o 12 NORTH RANGE N^o 37 EAST MOUNT DIABLO MERIDIAN

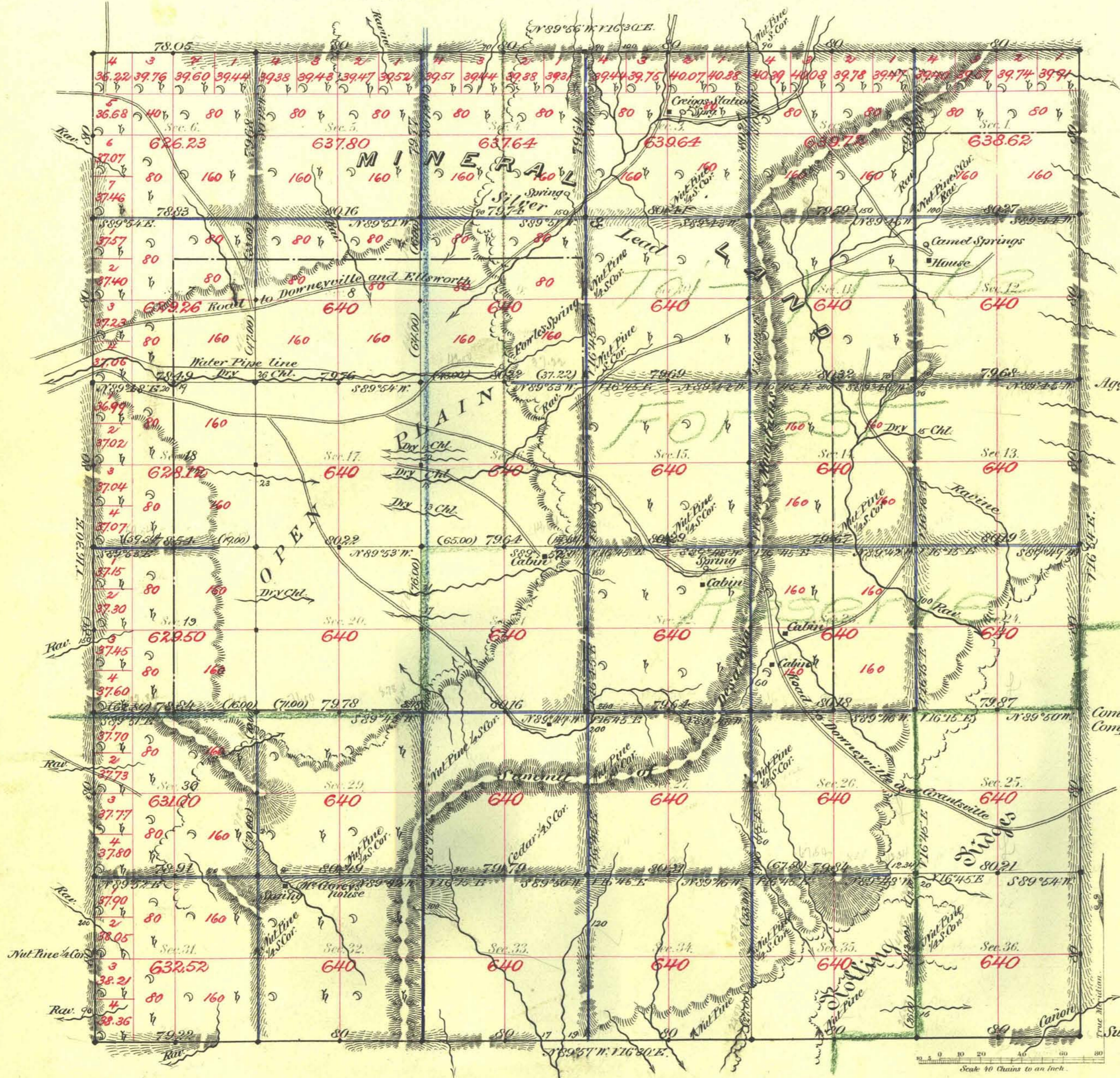

Aggregate Area of Public Land Surveyed 12400.00 Acres.
 " " Mineral " 10570.05 "
 Aggregate 22970.05 "

Commenced April 30th 1882.
 Completed May 10th "

Subdivisions not noted run with a variation of 16°30' East.

Survey Designated	By Whom Surveyed	Date of Contract	Amount of Surveys	When Surveyed	T ^o Cor.
East Poly.	Glover & Perrin	Nov. 22 nd 1880	6- 80 - 80	1881	104
N.W. & S.	Stewart & Morrison	March 21 st 1883	17- 27 - 27	1883	164
Subdiv ^{ns} black	"	"	15- 66 - 89	April & May, 1882	"
" blue	"	"	44- 65 - 80	"	"

The above Map of Township N. 12 North of Range N. 37 East of Mount Diablo Meridian is strictly conformable to the field notes of the survey thereof on file in this Office, which have been examined and approved.

Surveyor General's Office, }
 Reno, Nevada }
 June 14th 1883 } *C. C. Covington*
 Sur. Gen. Nevada