

TOWNSHIP N° 12 NORTH RANGE N° 36 EAST MOUNT DIABLO MERIDIAN

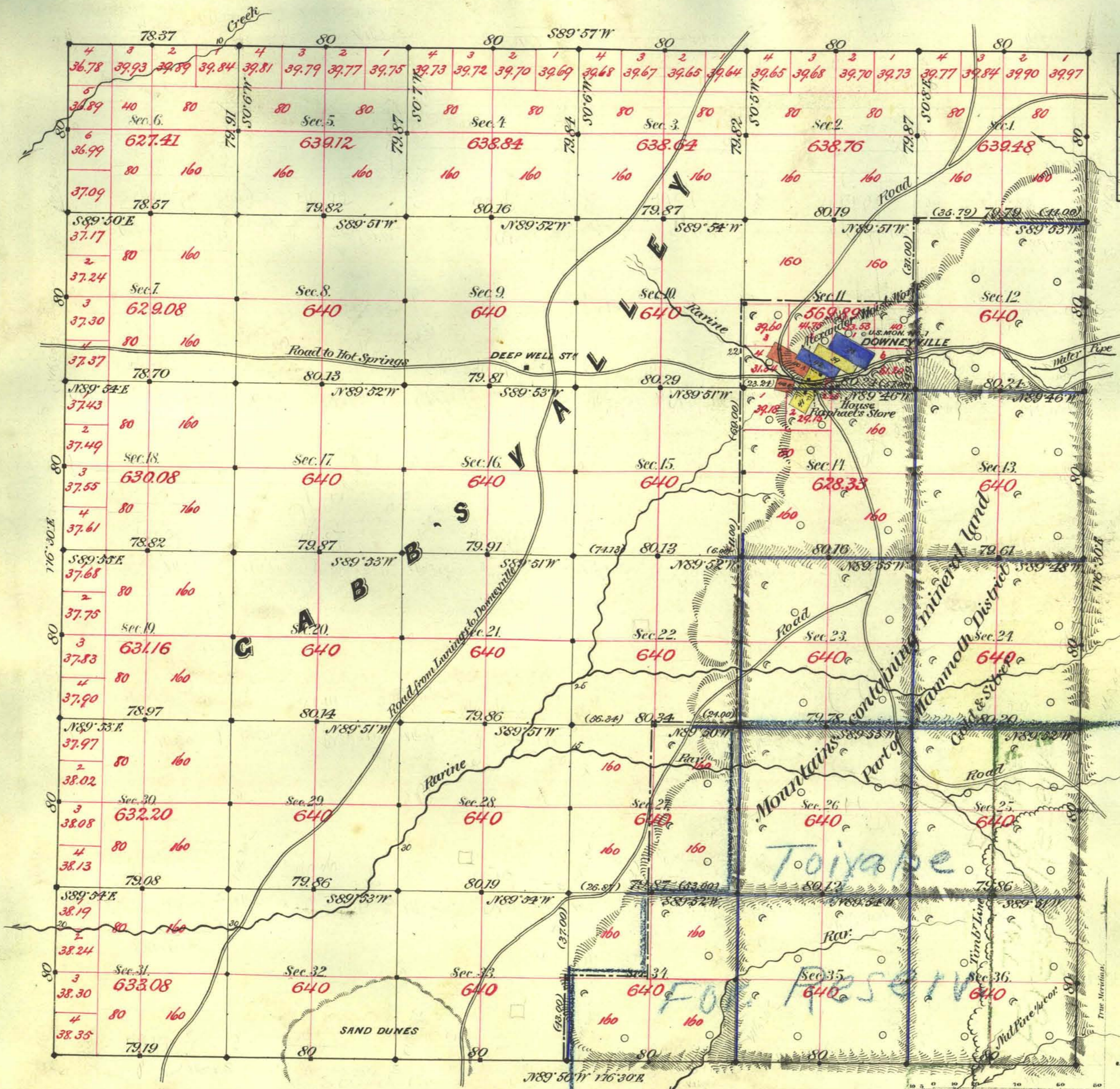

PART OF MAMMOTH DIST.				
No	Claim	Lode	Acres	Approval
38	P. Downey	Lookout	79.13	Oct. 1 <sup>st</sup> 1878
39	"	Alexander	11.26	" " "
40	"	Great Western	20.42	" 2 <sup>nd</sup> "
41	"	Domingo	18.27	" " "
42	"	Lizzie Downey	12.70	Sept. 30 <sup>th</sup> "

Aggregate Area of Public Land surveyed 16,097.85 Ac.  
 " " " " Mineral " 6,880.00 "  
 " " " " Aggregate 22,977.85 "

Commenced Sept. 1<sup>st</sup> 1883  
 Completed " 5<sup>th</sup> "

Subdivisions run with a Var. of 16' 30"E.

Surveys Designated	By Whom Surveyed	Date of Contract	Amount of surveys	When surveyed	79 <sup>th</sup> Cor.
E. bdy	Stewart & Morrison	March 21 <sup>st</sup> 1883	76 - 20 - 140	1883	16 <sup>th</sup>
N.S. & W. bdy	" & Conkling	July 19 <sup>th</sup> "	17 - 77 - 56	"	16 <sup>th</sup>
Subdsns black	"	"	42 - 26 - 92	Sept.	"
" blue	"	"	17 - 46 - 97	"	"

The above Map of Township No. 12 North of Range No. 36 East Mount Diablo Meridian is strictly conformable to the field notes of the survey thereof on file in this Office, which have been examined and approved.  
 Surveyor General's Office, Reno, L. L. Downing  
 Jan. 5<sup>th</sup> 1884

Surr. Gen'l of Nevada