

TOWNSHIP N^o 11 NORTH RANGE N^o 39 EAST MOUNT DIABLO MERIDIAN

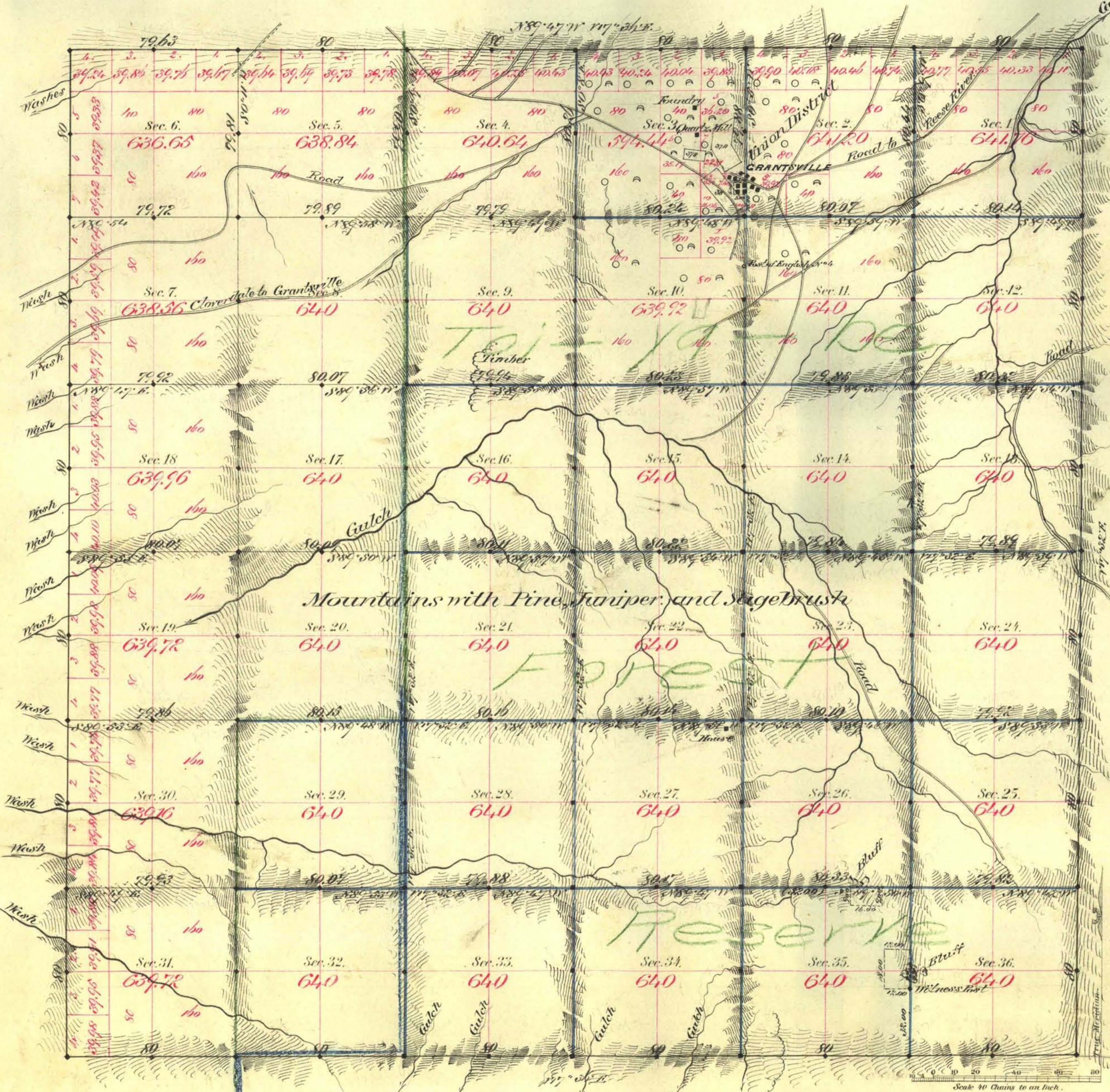

Mineral Claims				
N ^o	Claim	Lode	Acre	Approval
67	Alexander M. C.	Great American Forks	25.66	Dec. 18 1877
68	M. San Pedro	Alameda	20.66	May 4 1856

Aggregate Area of Public Land Surveyed 21,605.61 ac.
 " " " " " " " " " " " " " " 1,440.68 "
 " " " " " " " " " " " " " " 23,046.29 "

Commenced March 2nd 1881
 Completed " 9th "

This line was
 by 19 - Cont 104 vol. 1
 Subdivision lines not noted per article Variation of 17.37 East

Survey Designated	By Whom Surveyed	Date of Contract	Amount of Survey	When Surveyed	960 Con.
Township lines	Blair & Dean	May 2nd 1850	363 - 00 - 00	1851	104
Subdivision back to 1850	"	"	17 - 70 - 00	"	"
	"	"	42 - 02 - 00	"	"

The above Map of Township N. 11 North of Range N. 39 East Mt Diablo Meridian is strictly conformable to the field notes of the survey thereof on file in this Office, which have been examined and approved.
 Surveyor General's Office,
 Virginia City, Nev.
 April 6th 1881
 C. S. Davis,
 Sur. Gen. Nev.