

TOWNSHIP 11 NORTH, RANGE 36 EAST, MOUNT DIABLO MERIDIAN, NEVADA  
SUPPLEMENTAL PLAT OF SECTION 4

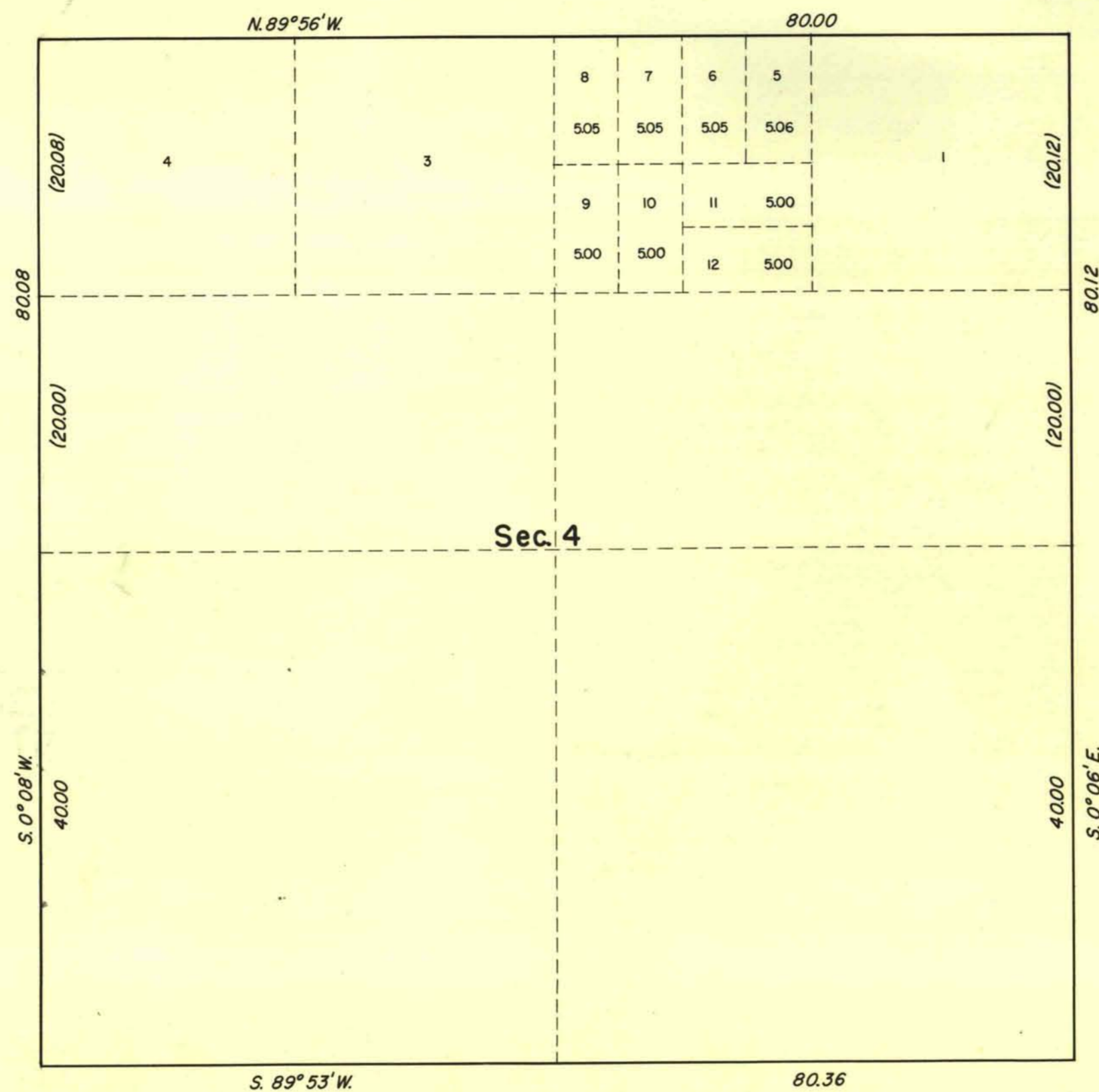

This supplemental plat showing the subdivision of original lot 2, sec. 4, T. 11 N., R. 36 E., Mount Diablo Meridian, Nevada, is based upon plat approved January 5, 1884.

UNITED STATES DEPARTMENT OF THE INTERIOR  
BUREAU OF LAND MANAGEMENT  
Washington, D. C. January 27, 1959

This plat, showing amended lottings, is based upon the official records, and having been correctly prepared in accordance with the regulations, is hereby accepted.

For the Director

*Earl G. Harrington*  
Cadastral Engineering Staff Officer

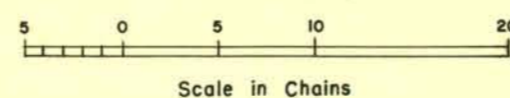

1069-a

T11 N, R36 E

*M.N.*