

TOWNSHIP 8 SOUTH, RANGE 64 EAST, MOUNT DIABLO MERIDIAN, NEVADA

INDEPENDENT RESURVEY

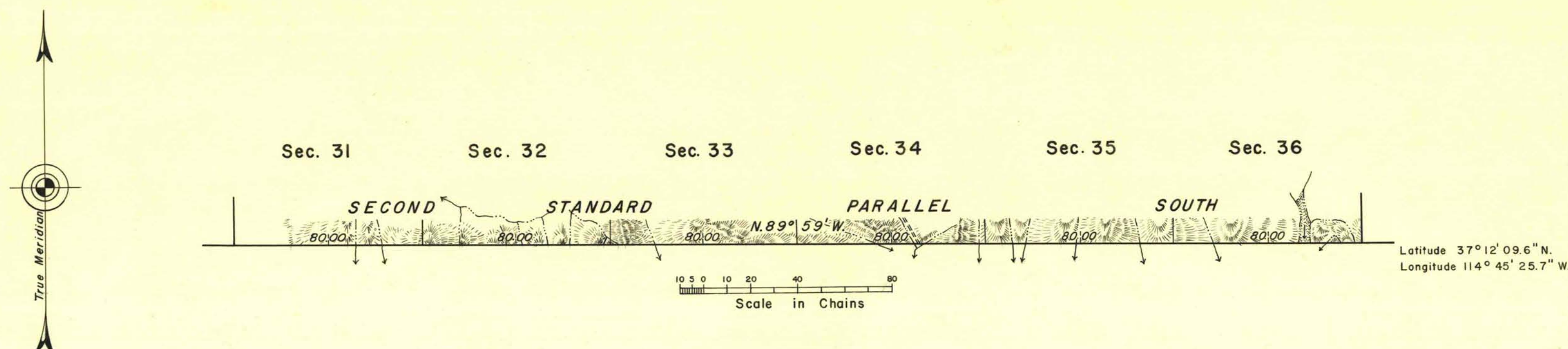

The Second Standard Parallel South through R. 64 E. was surveyed by A. R. Talamantes in 1911.

The independent resurvey of the Second Standard Parallel South along the south boundary of T. 8 S., R. 64 E., Mount Diablo Meridian, Nevada was executed by Dupree R. Averill and John Boggs, November 17 to 24, 1952, under special instructions for Group 355, Nevada dated August 7, 1952.

UNITED STATES DEPARTMENT OF THE INTERIOR
BUREAU OF LAND MANAGEMENT
Washington, D. C. March 26, 1957

This plat is strictly conformable to the approved field notes, and the survey, having been correctly executed in accordance with the requirements of law and the regulations of this Bureau, is hereby accepted.

For the Director

Earl S. Harrington

Cadastral Engineering Staff Officer