

TOWNSHIP 8 SOUTH, RANGE 59 EAST, OF THE MOUNT DIABLO MERIDIAN, NEVADA

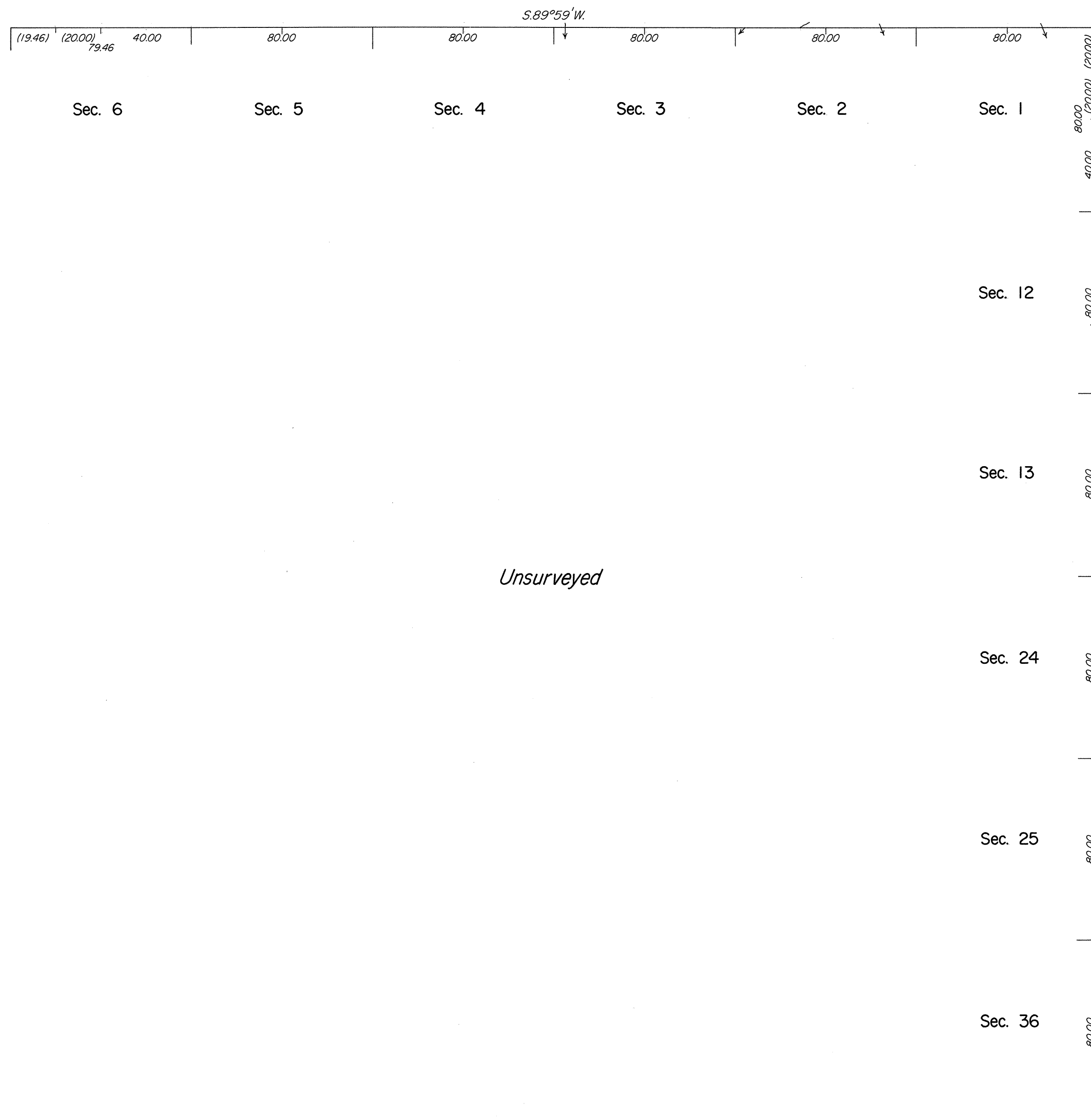

This plat represents the survey of the east and north boundaries of T. 8 S., R. 59 E., Mount Diablo Meridian, Nevada.

Survey executed by Ronald K. Baugh, Cadastral Surveyor, March 13 to March 17, 1978, under Supplemental Special Instructions dated July 1, 1977, for Group No. 548, Nevada.

UNITED STATES DEPARTMENT OF THE INTERIOR
BUREAU OF LAND MANAGEMENT
Washington, D.C. February 16, 1979

This plat is strictly conformable to the approved field notes, and the survey, having been correctly executed in accordance with the requirements of law and the regulations of this Bureau, is hereby accepted.

For the Director

Acting Chief, Division of Cadastral Survey

Latitude 37°12'06.4"N.
Longitude 115°18'05.3"W.

