

TOWNSHIP 8 NORTH, RANGE 44 EAST, MOUNT DIABLO MERIDIAN, NEVADA

MINERAL SEGREGATIONS IN SECTIONS 19, 20, 21 & 31

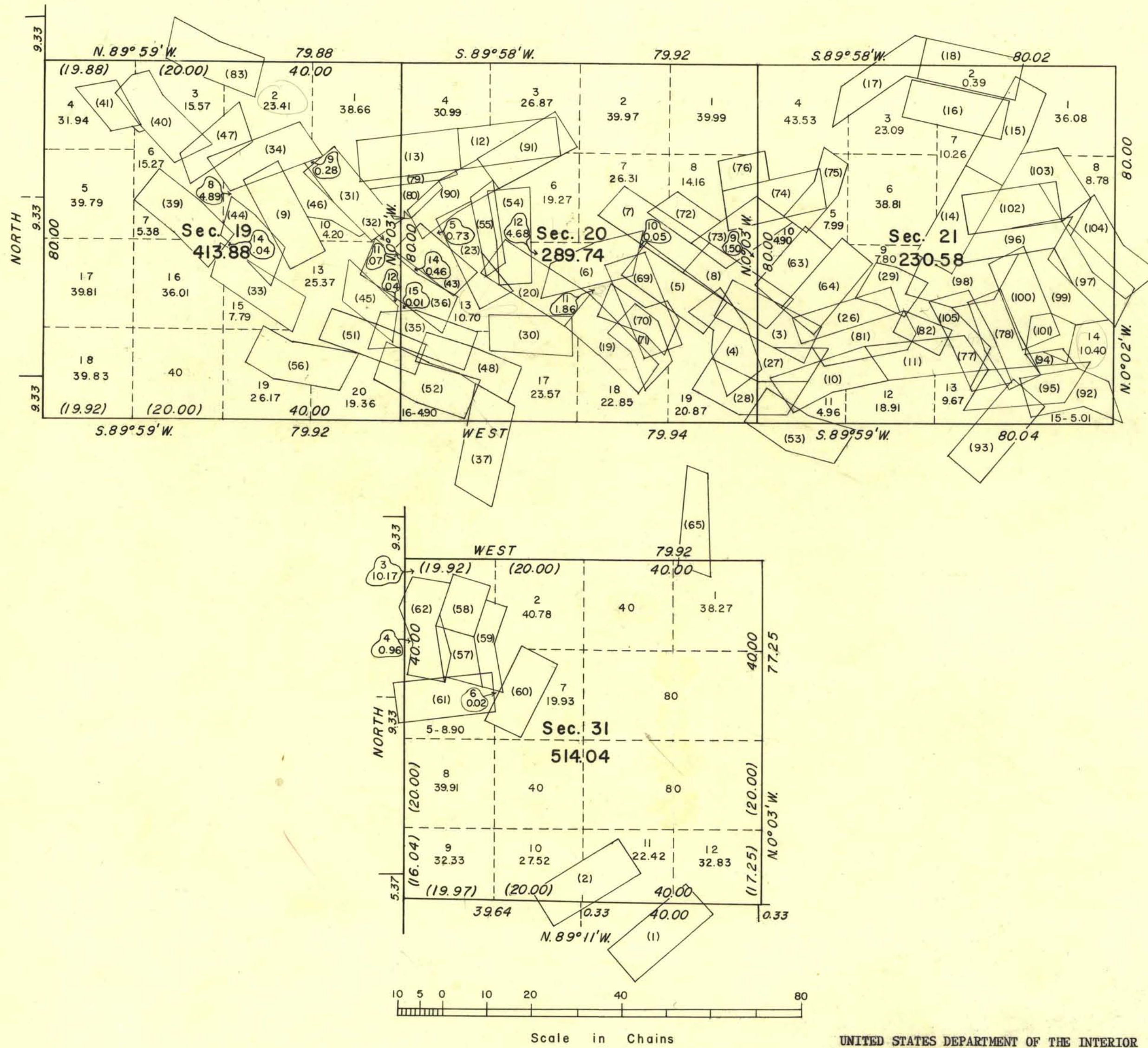

INDEX NO. SURVEY NO. NAME OF LODE SEC. NO.

(1)	1657 (39)	Cherokee	31
(2)	1658 (40)	Wyoming	31
(3)	2528	Silver Pick No.1	21
(4)	2544	Earl	20
(5)	2552	Union No. 2	20
(6)	2553	Union No. 3	20
(7)	2554	Union No. 4	20
(8)	2555	Union No. 5	20
(9)	2556	Union No. 9	19
(10)	2579	White Cap	21
(11)	"	White Cap No.1	21
(12)	2580	Dexter No.13	20
(13)	"	Dexter No.14	20
(14)	2601	Dexter No.1	21
(15)	"	Dexter	21
(16)	"	Dexter No.6	21
(17)	"	Dexter No.9	21
(18)	"	Dexter No.10	21
(19)	2602	Dexter No.7	20
(20)	"	Dexter No.8	20
(21)	2603	Dexter No.11	16
(22)	"	Dexter No.12	17
(23)	2613	Carson	20
(24)	2625	Union	28
(25)	"	Union No.1	28
(26)	2651	Katie No.1	21
(27)	2692	Keystone	21
(28)	2693	Red Boy	20
(29)	2694	Whooper Fraction	21
(30)	2695	Uno	20
(31)	2696	Big Four	19
(32)	"	Last Chance	19
(33)	2729	St. George	19
(34)	2743	Little Grey	19
(35)	2759	May Flower	20
(36)	"	Big Pine	20
(37)	2764	Snow Drift	29
(38)	2773	Ivanhoe	28
(39)	2822	Skookum	19
(40)	2831	Wolfstone	19
(41)	"	Wolfstone Fraction	19
(42)	"	Wolfstone Fraction No.1	19
(43)	2842	Black Jack	20
(44)	2845	Crescent	19
(45)	2846	Reilly Fraction	19
(46)	2847	Gold Wedge	19
(47)	2848	Nellie Gray	19
(48)	2874	Annie Laurie	20
(49)	2876	Copper Farm	18
(50)	"	Eldorado No. 2	18
(51)	2879	Iron King	19
(52)	"	Iron Queen	20
(53)	2882	Mule Skinner	28
(54)	2914	Jackson	20
(55)	2915	Pine Nut	20
(56)	2965	Virginia	19
(57)	2973	Baby Ruth	31
(58)	2974	Baby Ruth No.1	31
(59)	2975	Baby Ruth No.2	31
(60)	2976	Broken Pick	31
(61)	2977	King Oscar No.1	31
(62)	2986	Country Boy	31
(63)	3098	"	21
(64)	"	Virgin Mary No.1	21
(65)	3364	Lucky Boy No.2	30
(66)	3623	Crescent	16
(67)	3641	Diman King	9
(68)	"	Diman King No.1	10
(69)	3667	Snowman	20
(70)	"	Flying Cloud	20
(71)	"	Eva	20
(72)	3733	Sundown Fraction	20
(73)	"	October	20
(74)	"	Elephant	21
(75)	"	Tiger	21
(76)	"	Triangle Fraction	20
(77)	3751	High Grade	21
(78)	"	Top Notch	21
(79)	4052	Hazel Fraction No.1	20
(80)	"	Joker Fraction	20
(81)	4073	"	21
(82)	"	Morning Glory	21
(83)	4095	Orphant	19
(84)	4294	Ledger	22
(85)	"	Ledger No.1	22
(86)	"	Ledger No.2	22
(87)	"	Ledger No.3	22
(88)	"	Ledger No.4	22
(89)	"	Ledger No.5	22
(90)	4299	Lottie	20
(91)	"	Ida	20
(92)	4335	Contact	21
(93)	"	White Cap Extension	28
(94)	"	White Cap Fraction	21
(95)	"	White Cap Extension No.1	21
(96)	"	Cash Entry No.1	21
(97)	"	Cash Entry No.2	21
(98)	"	Cash Entry Fraction	21
(99)	"	Cash Entry Fraction No.2	21
(100)	"	Birds Eye	21
(101)	"	Birds Eye Fraction	21
(102)	"	Thelma	21
(103)	"	Tip Top	21
(104)	"	Producer	21
(105)	4346	Exclusion	21

UNITED STATES DEPARTMENT OF THE INTERIOR
BUREAU OF LAND MANAGEMENT
Washington, D. C. April 10, 1957

This plat is strictly conformable to the approved field notes, and the survey, having been correctly executed in accordance with the requirements of law and the regulations of this Bureau, is hereby accepted.

For the Director
Earl G. Harrington
Cadastral Engineering Staff Officer

MS. 8.83

T8N, R44E (Sheet 2 of 2)