

Township N^o 8 North

Range N^o 43 East

Mount Diablo Meridian

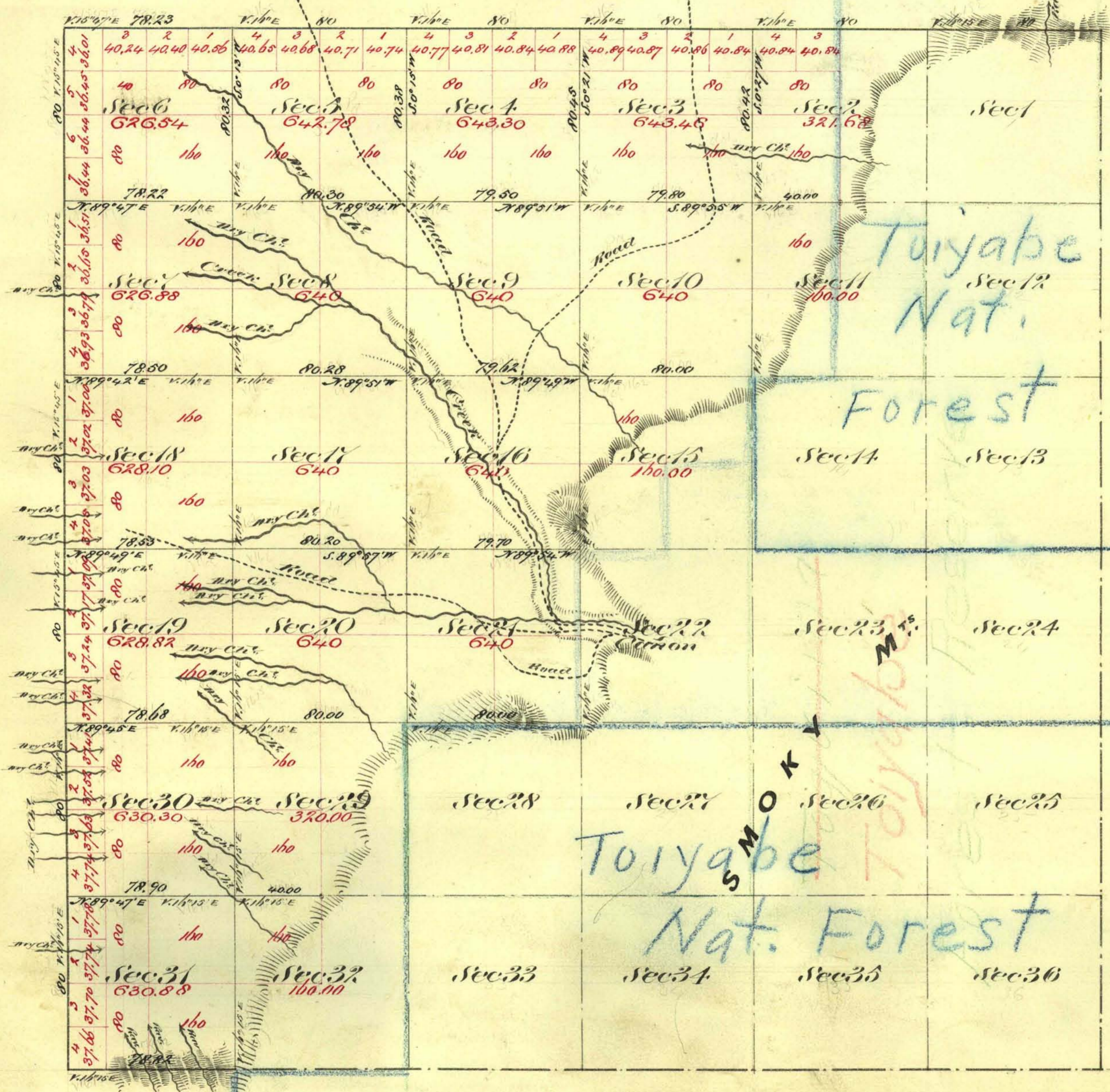

Aggregate Area of Public Land (Surveyed) 11,302.74 Acres
 Estimated " " Mountains (unsurveyed) 11,682.52 "
 Aggregate 22,985.26 "

Commenced August 16th 1873
 Completed " 9th "

| Surveys Designated | By Whom Surveyed | Date of Contract | Area of Surveys Ac. Ch. Rds. | When Surveyed | 3 rd Com. |
|------------------------|------------------------------------|----------------------------|---------------------------------|---------------|----------------------|
| West Boundary | C. C. Tracy | July 2 nd 1867 | 6 00 00 | 1867 | 3 |
| Rest of Township Lines | A. Hatch & H. Kneller & L. Bridges | June 10 th 1873 | 6 77 05 | 1873 | 57 |
| Subdivision Lines | " " " " " | " " " | 31 73 80 | August 1873 | " |

The above Map of Township N^o 8 North, Range N^o 43 East, Mount Diablo Meridian is strictly conformable to the field notes of the Surveyors thereof on file in this Office, which have been examined and approved by the U. S. Surveyor General's Office, Virginia City, Nevada, October 13th 1873.

E. S. Davis
 U. S. Surveyor General

T 8 N. R 43 E.