

TOWNSHIP 7 SOUTH, RANGE 71 EAST, OF THE MOUNT DIABLO MERIDIAN, NEVADA.

RECEIVED
LAND AND SURVEY OFFICE
RENO, NEVADA
MAY 23 1955

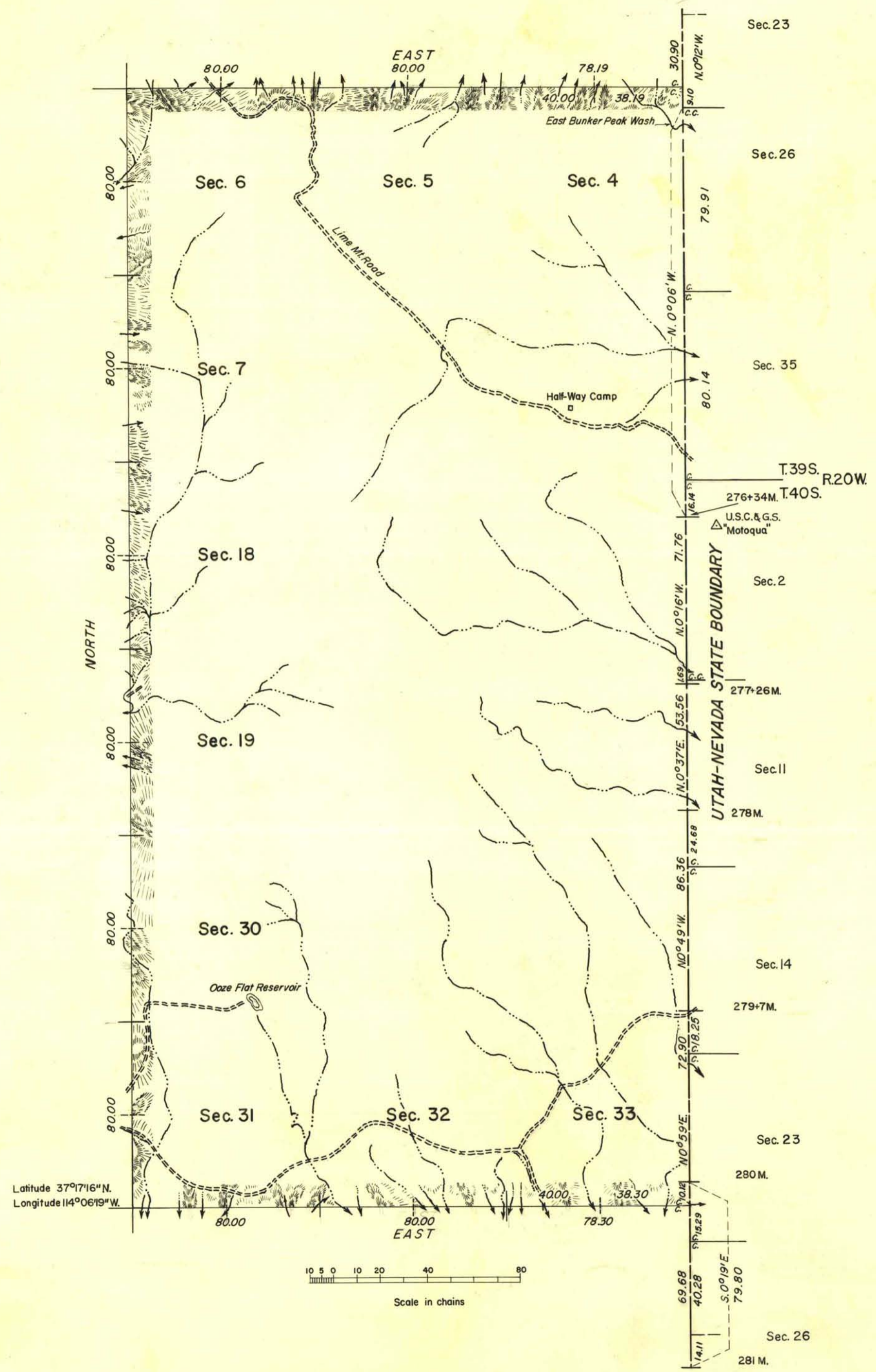

The Nevada-Utah State boundary was dependently resurveyed by James C. O'Brien in 1921 and the west boundary was surveyed by Dupree R. Averill and Roger F. Wilson in 1953 under this same group.

Survey of the north and south boundaries of fractional Township 7 South, Range 71 East, executed by Dupree R. Averill and Roger F. Wilson, May 7 to 13, 1953, under special instructions for Group 295, Nevada, dated March 5, 1953.

Drainage in unsurveyed area taken from planimetric maps prepared from aerial photographs.

UNITED STATES DEPARTMENT OF THE INTERIOR
BUREAU OF LAND MANAGEMENT
Washington, D. C. February 15, 1956

This plat is strictly conformable to the approved field notes, and the survey, having been correctly executed in accordance with the requirements of law and the regulations of this Bureau, is hereby accepted.

For the Director
Earl G. Harrington
Cadastral Engineering Staff Officer

3348-A

T. 7 S. R. 71 E.