

TOWNSHIP 6 SOUTH, RANGE 62 EAST, MOUNT DIABLO MERIDIAN, NEVADA

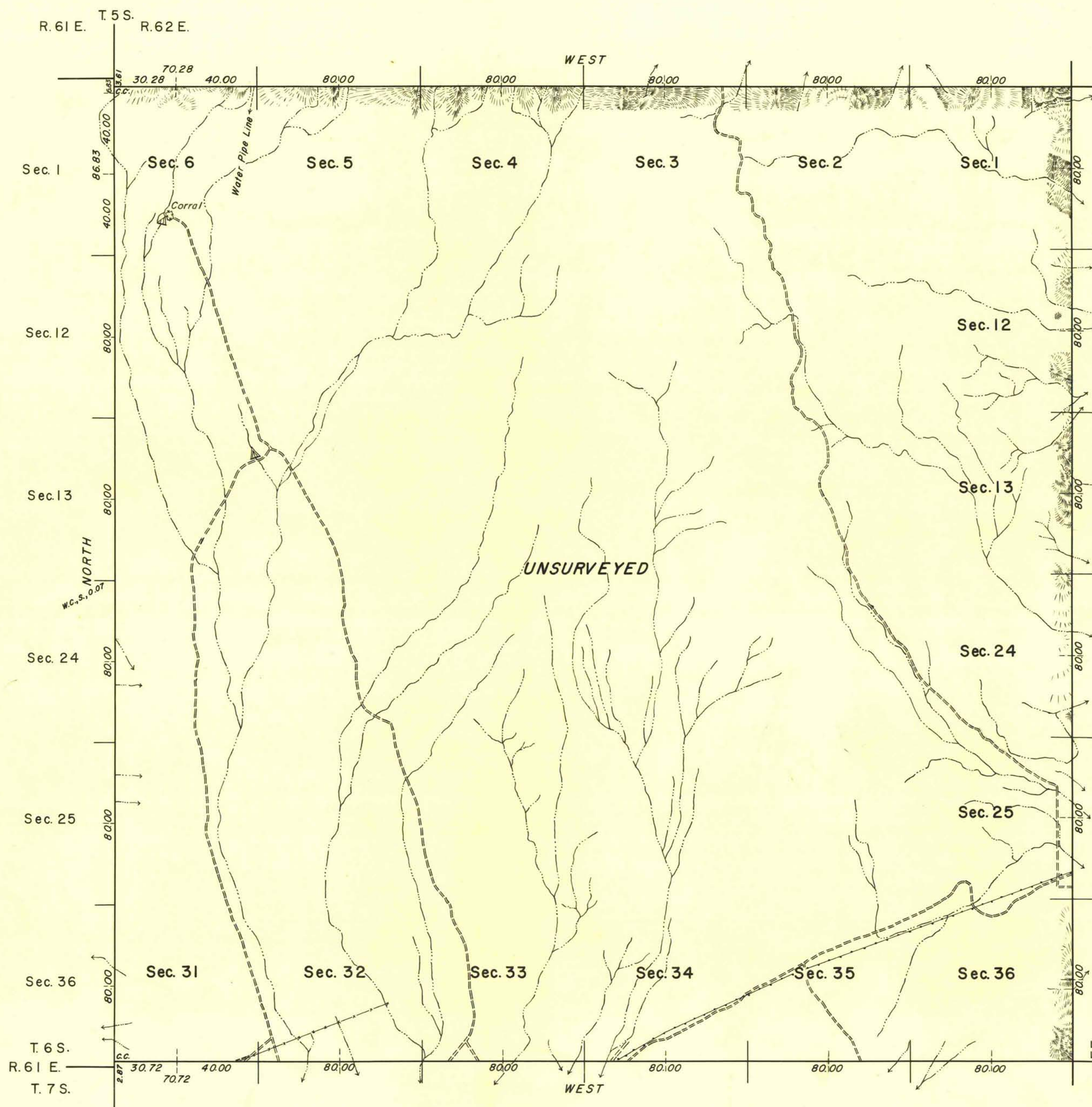

The south boundary was surveyed and the west boundary was resurveyed under this same group, the record of which appears in the field notes of T. 7 S., R. 62 E. and T. 6 S., R. 61 E., respectively.

Survey of the east and north boundaries of T. 6 S., R. 62 E., Mount Diablo Meridian, Nevada, executed by Dupree R. Averill, July 13 to 21, 1953, under special instructions for Group 355, Nevada, dated August 7, 1952.

UNITED STATES DEPARTMENT OF THE INTERIOR
BUREAU OF LAND MANAGEMENT
Washington, D. C. June 11, 1957

This plat is strictly conformable to the approved field notes, and the survey, having been correctly executed in accordance with the requirements of law and the regulations of this Bureau, is hereby accepted.

For the Director
Donald C. [Signature]
Acting Cadastral Engineering Staff Officer

Latitude 37° 22' 36.3" N.
Longitude 114° 58' 28.8" W.

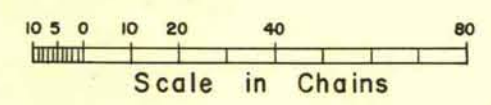

2739-a

T. 6 S., R. 62 E.

M.S. [Signature]