

TOWNSHIP N<sup>o</sup> 6 NORTH RANGE N<sup>o</sup> 43 EAST MOUNT DIABLO MERIDIAN

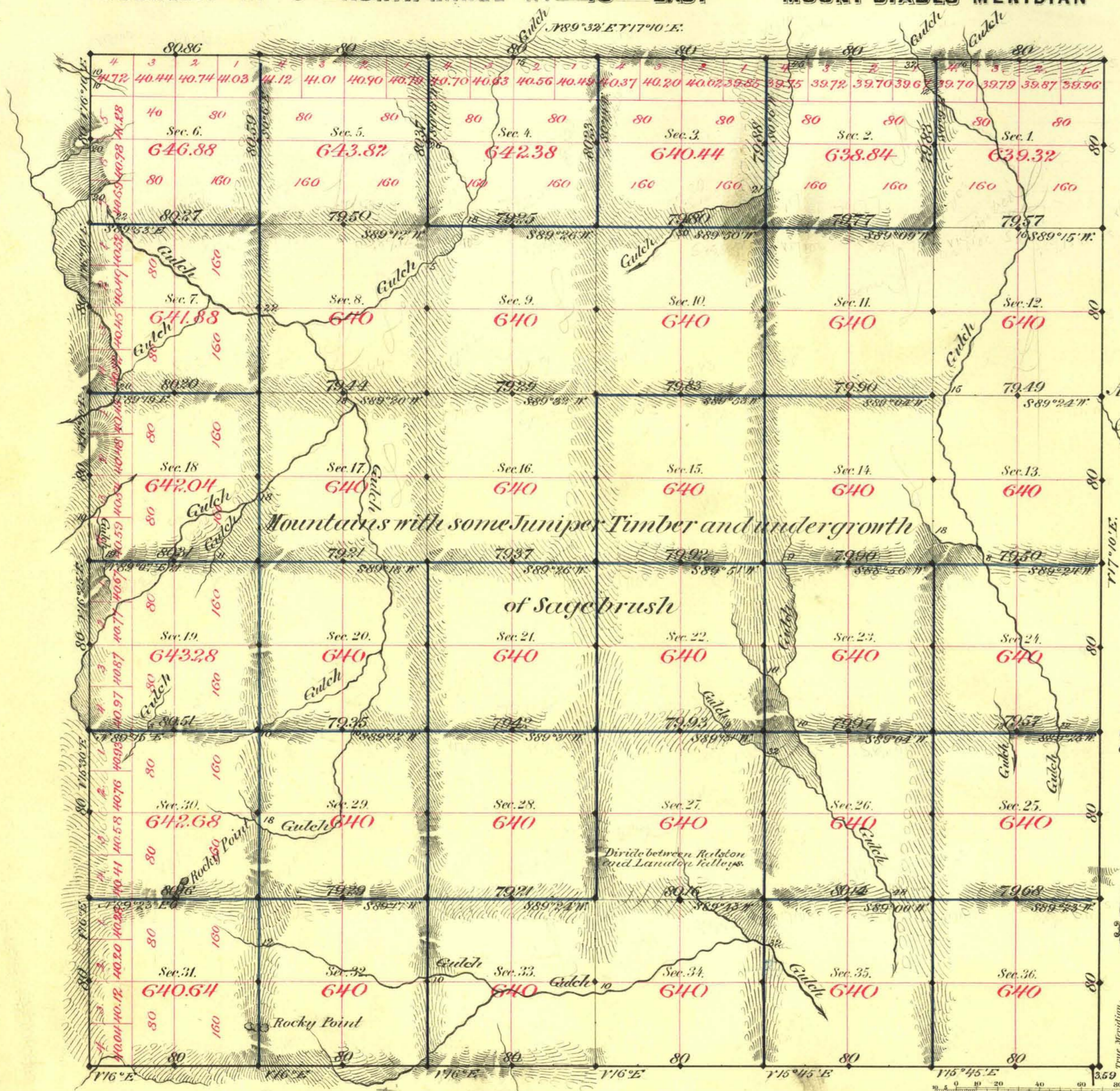

Aggregate Area of Public Land surveyed 2306220 Acres.

Commenced June 2<sup>nd</sup> 1881.  
Completed " 10<sup>th</sup> "

Subd<sup>ns</sup> run Var. 17°10' East.

For connections see T 5

Surveys Designated	By Whom Surveyed	Date of Contract	Amount of Surveys	When Surveyed
W. & S. Bdy.	C. C. Tracy	July 16 <sup>th</sup> 1867	12 <sup>00</sup> 00 <sup>00</sup> 00 <sup>00</sup>	1867
W. & S. Bdy.	Glover & Perrin	April 15 <sup>th</sup> 1881	18-00-86	1881
Subd <sup>ns</sup> black # 8.	"	"	11-77-46	June
" blue # 10	"	"	47-76-36	"

7<sup>th</sup> Cor  
3  
122  
"

The above Map of Township N<sup>o</sup> 6 North of Range N<sup>o</sup> 43 East, Mount Diablo Meridian is strictly conformable to the field notes of the survey thereof on file in this Office, which have been examined and approved.  
Surveyor General's Office,  
Virginia City, Nevada }  
November 4<sup>th</sup> 1881. }  
Sur. Gen. Nev.