

TOWNSHIP 5 SOUTH, RANGE 66 EAST, OF THE MOUNT DIABLO MERIDIAN, NEVADA

OFFICIALLY FILED
NEVADA STATE OFFICE
10:00 a.m., September 21, 1978

A history of surveys is contained in the field notes.

This plat represents a survey of a portion of the subdivisinal lines, of T. 5 S., R. 66 E., Mount Diablo Meridian, Nevada.

Survey executed by Robert A. Pratt, Cadastral Surveyor, June 15 to June 21, 1977, under Special Instructions dated May 20, 1977, for Group No. 547, Nevada.

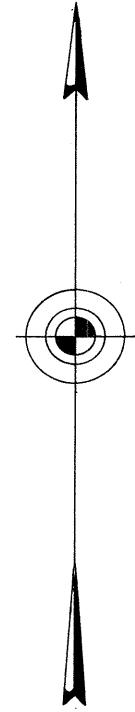

Mean Magnetic Declination
15 1/2° E.

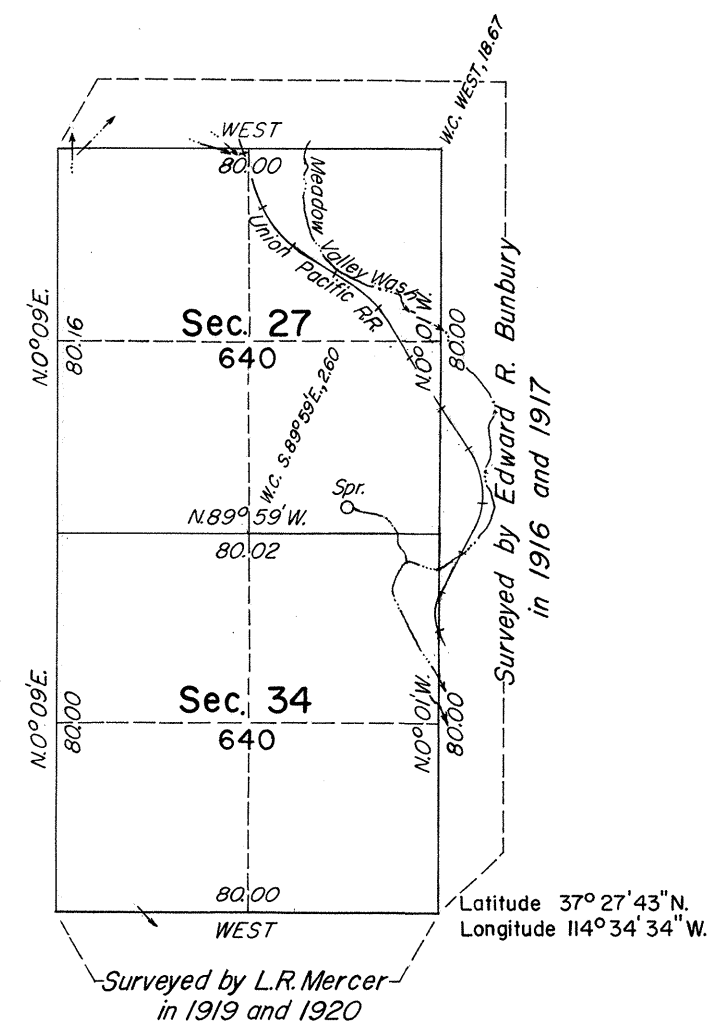

UNITED STATES DEPARTMENT OF THE INTERIOR
BUREAU OF LAND MANAGEMENT
Washington, D.C. May 5, 1978

This plat is strictly conformable to the approved field notes, and the survey, having been correctly executed in accordance with the requirements of law and the regulations of this Bureau, is hereby accepted.

For the Director

Louis C. Gilbert

Acting Chief, Division of Cadastral Survey

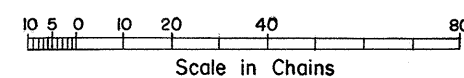

Area surveyed 1280.00 Acres