

ORIGINAL

TOWNSHIP 5 SOUTH, RANGE 55 EAST, OF THE MOUNT DIABLO MERIDIAN, NEVADA

Sec. 32
FIRST STANDARD PARALLEL SOUTH
Resurveyed by Robert A. Pratt in 1977

5.89°48'W.
40.44'

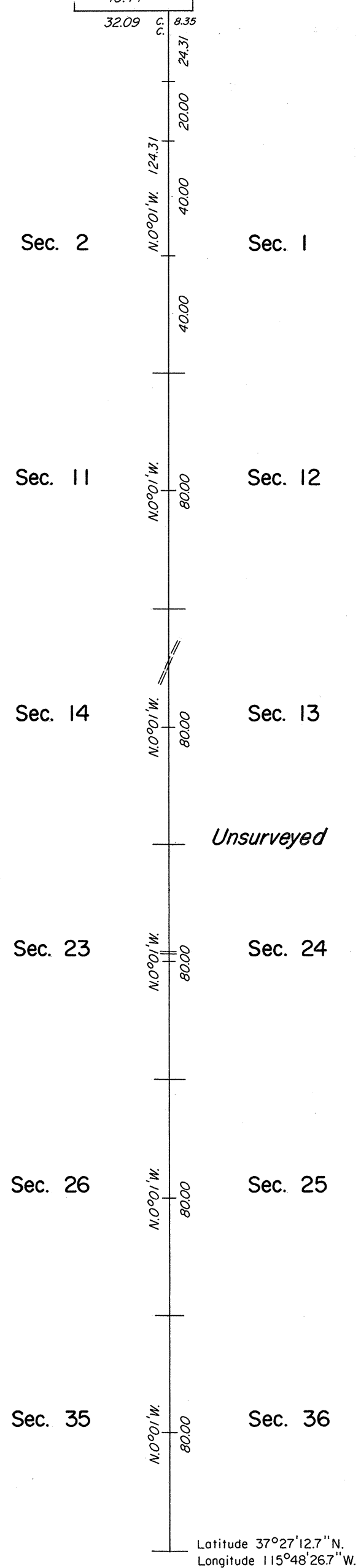

A history of surveys is contained in the field notes.

The corner of sections 1, 2, 35 and 36, on the south boundary of the Township, was established under T. 6 S., R. 55 E., Mount Diablo Meridian, Nevada, of this same group.

This plat represents the survey of a portion of the subdivisional lines of T. 5 S., R. 55 E., Mount Diablo Meridian, Nevada.

Survey executed by Robert A. Pratt, Cadastral Surveyor, beginning March 15, 1978, and completed November 22, 1978, pursuant to Special Instructions dated March 7, 1978, and Supplemental Special Instructions dated November 14, 1978, for Group No. 560, Nevada.

1000 a.m. April 8, 1980
OFFICIALLY FILED
NEVADA STATE OFFICE

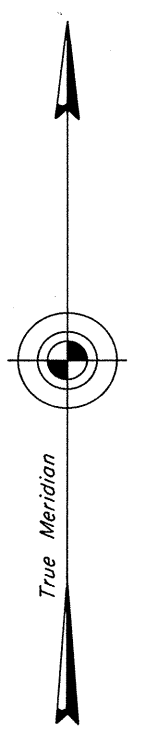

Mean Magnetic Declination
16 1/2° E.

Unsurveyed

Unsurveyed

UNITED STATES DEPARTMENT OF THE INTERIOR
BUREAU OF LAND MANAGEMENT
Denver, Colorado March 4, 1980

This plat is strictly conformable to the approved field notes, and the survey, having been correctly executed in accordance with the requirements of law and the regulations of this Bureau, is hereby accepted.

For the Director

Chief, Cadastral Survey
Examination and Approval Staff

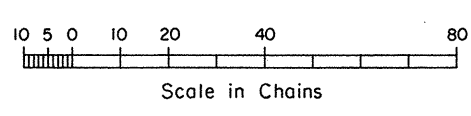

Latitude 37°27'12.7"N.
Longitude 115°48'26.7"W.

DD#