

Copy rec'd from L.A. Co. Off.  
3-30-61, ELD

Township No 5 South. Range No 37 East. Mount Diablo Meridian.

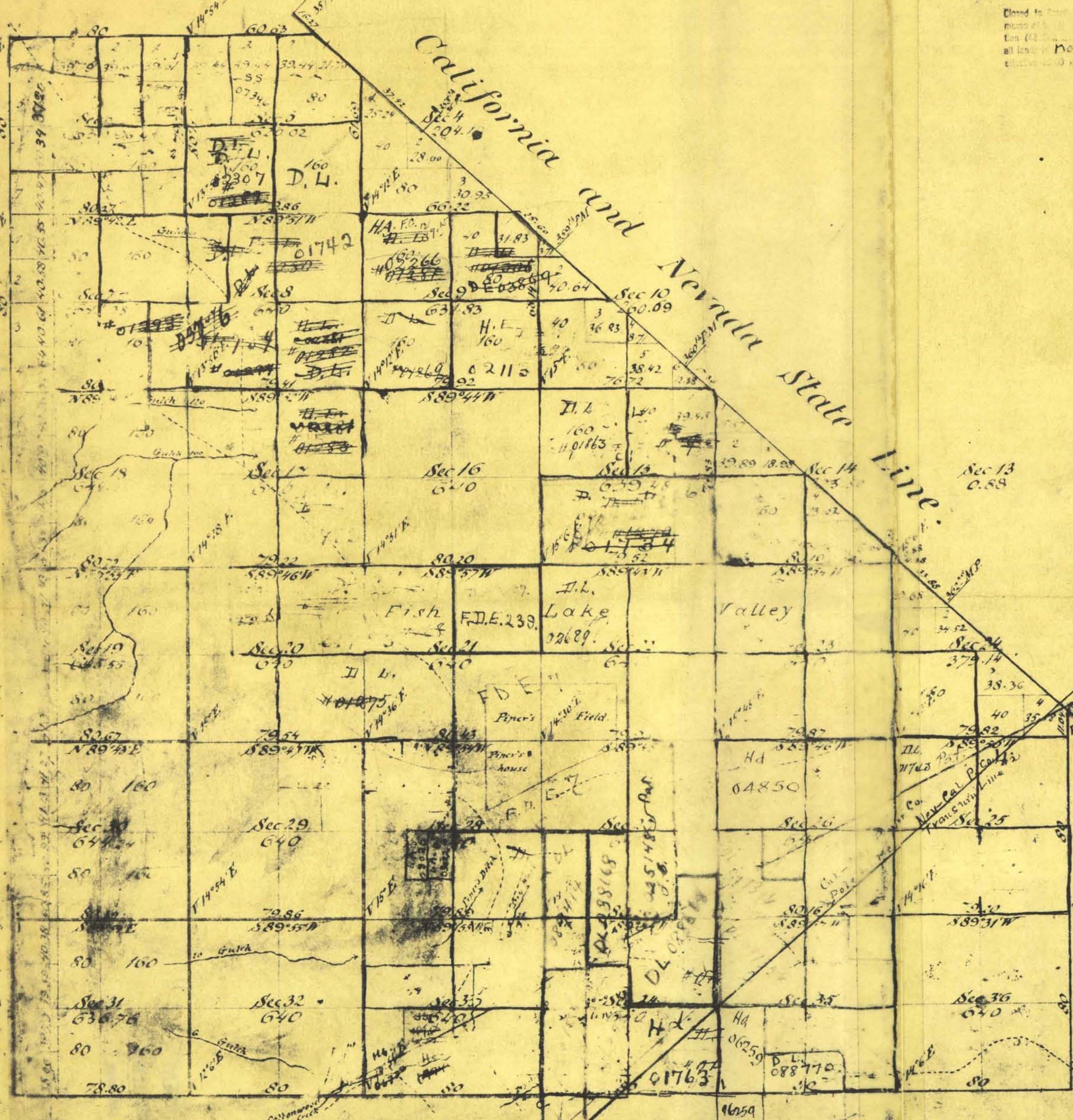

Aggregate Area of Public Land surveyed: 17,792.85 Acres.

SRH Desig. # 346 Cal # 29 Effective June 24, 1921  
 20 June 20-1921.  
 Sec. 32, 36, 35E.  
 33 30' 50"  
 Same Desig. End. No. 1013 Cal # 29  
 dated Dec 29, 1921

Lines colored red pass over mountainous land.

Transmission Line Right of Way # 1395,  
 May 4, 1937- Nev. Cal. Electric Corp.  
 EPC letter 12/13/37-  
 T. 5S., R. 37E., M.D.M.  
 Sec. 25, N1/4SW1, SW1/4SW1, SW1/4NW1;  
 Sec. 26, E1/4SE1, SW1/4SE1;  
 Sec. 35, N1/4NE1, E1/4NW1, SW1/4NW1.

Surveys Designated.	By whom surveyed.	Date of Contract.	Amount of Surveys	When surveyed.
California & Nevada State Line.	A. W. Von Schmidt			
Boundary of Township.	N. L. Berdan	October 19th 1879	1m's 60ns. 63ks	1880
White lines colored red.		"	5 " 78 " 80 "	"
Black lines colored red.		"	8 " 11 " 04 "	"
Black lines colored red.		"	9 " 1 " 64 "	"

The above Map of Township No 5 South, Range No 37 East, Mount Diablo Meridian is strictly conformable to the field-notes of the surveys thereof on file in this Office, which have been examined and approved.  
 Surveyor General's Office.  
 San Francisco, California.  
 March 31st 1880