

TOWNSHIP N<sup>o</sup> 5 NORTH RANGE N<sup>o</sup> 43 EAST MOUNT DIABLO MERIDIAN

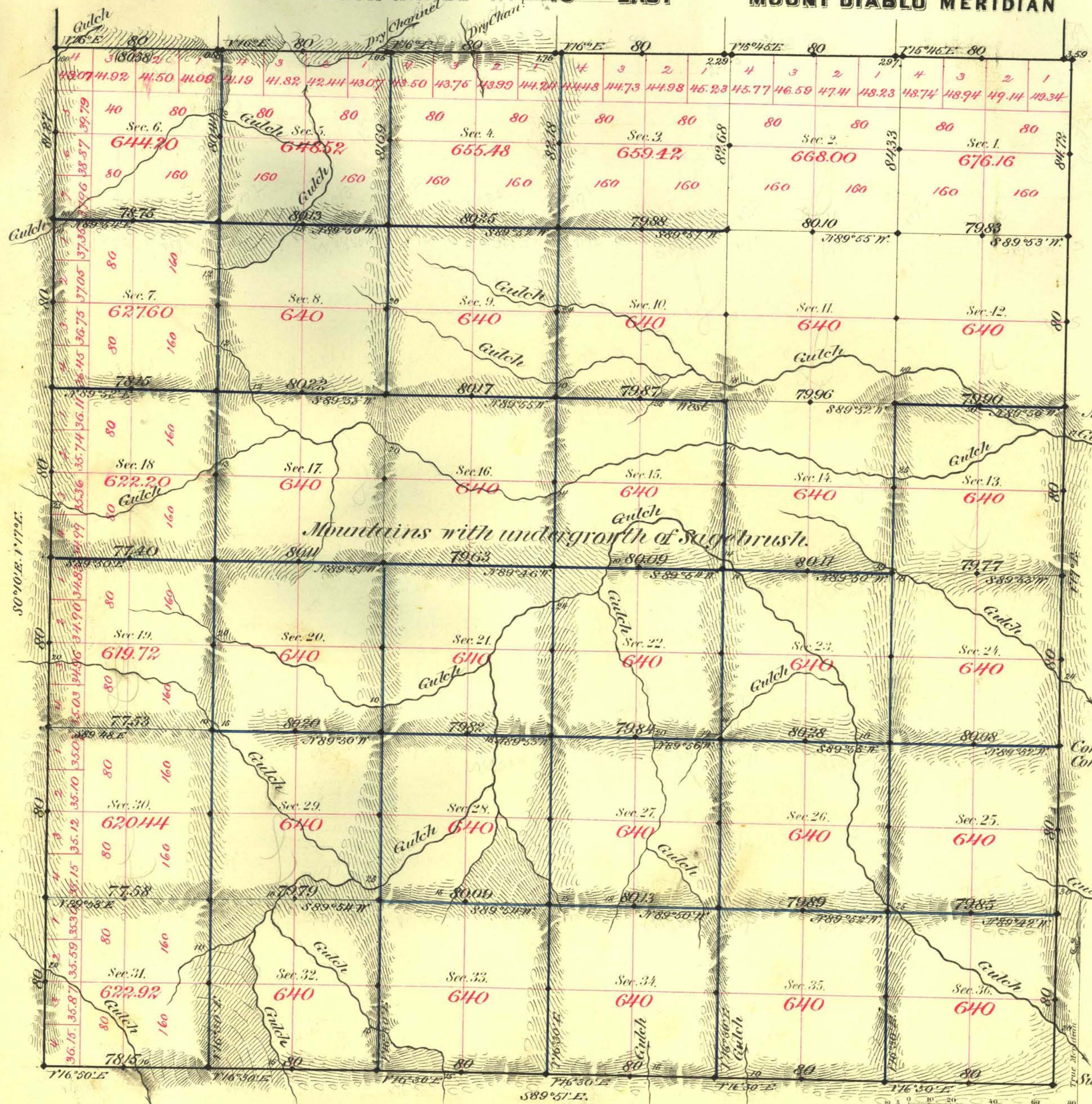

Aggregate Area of Public Land surveyed 23064.66 Acres.

Commenced August 1<sup>st</sup> 1881.  
Completed " 8<sup>th</sup> "

Subdivisions not noted run Variation 17° East.

Survey Designated	By Whom Surveyed	Date of Contract	Amount of Surveys	When Surveyed
North Bound <sup>d</sup>	C.C. Tracy	July 2 <sup>nd</sup> 1867	6 <sup>th</sup> 00 <sup>th</sup> 00 <sup>th</sup> 00 <sup>th</sup>	1867
E.N.S.	Gloryer Perrin	April 15 <sup>th</sup> 1881	18 04 14	1881
Subd <sup>s</sup> Black 88	"	"	12 01 37	August "
" Blue 90	"	"	47 78 94	" "
Convergency	"	"	08 64	" "

779 Cor.  
3  
128

The above Map of Township N<sup>o</sup> 5 North of Range N<sup>o</sup> 43 East  
Mt. Diablo Meridian is strictly conformable to the field  
notes of the survey thereof on file in this Office, which have been examined and approved.  
Surveyor General's Office,  
Virginia City, Nevada }  
November 7<sup>th</sup> 1881. }  
Sur. Gen. Nev.