

TOWNSHIP N^o 5 NORTH RANGE N^o 39 EAST MOUNT DIABLO MERIDIAN

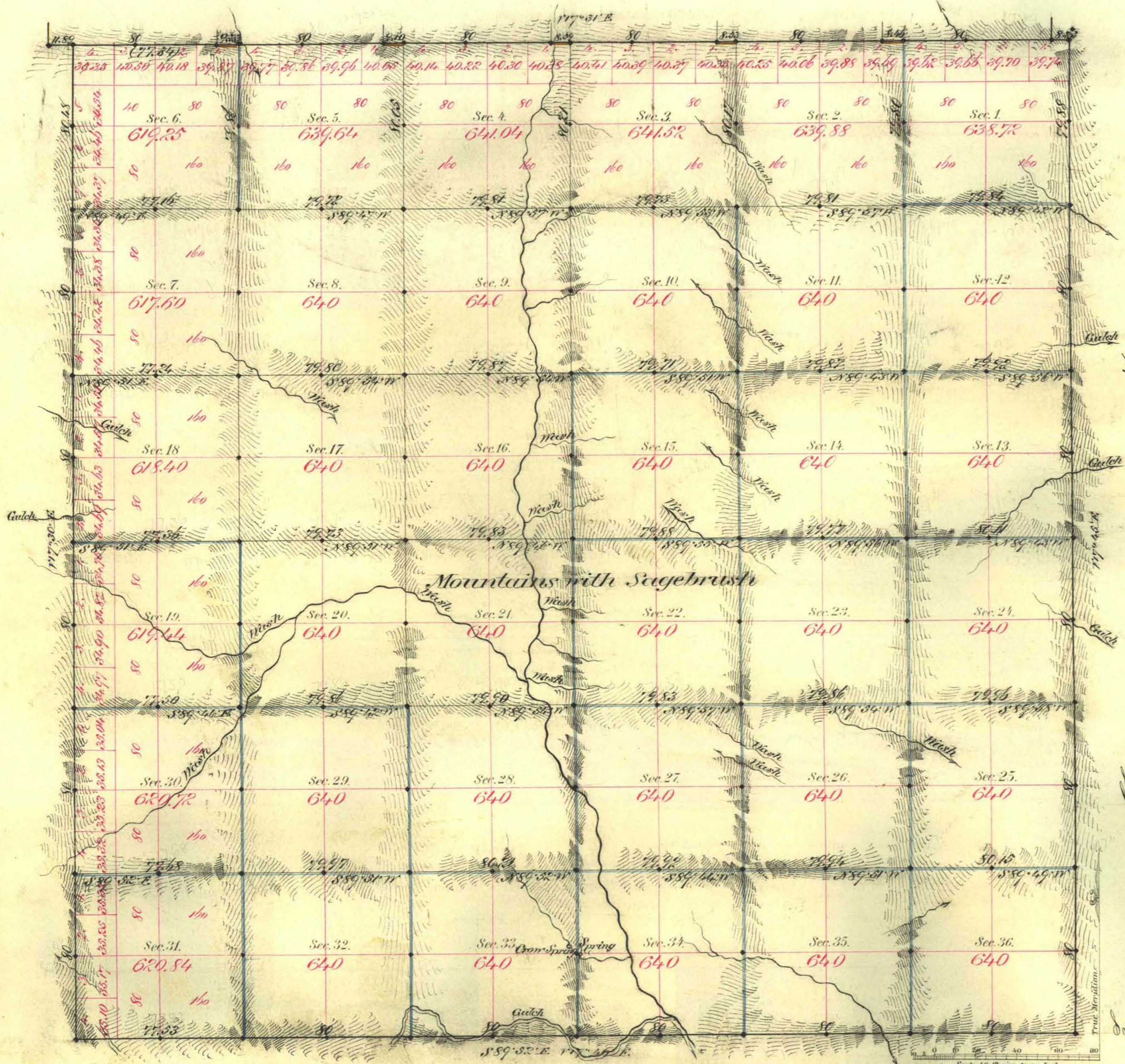

Aggregate Area of Public Land Surveyed 22,917.05 ac.

Commenced March 4th 1881
Completed " 11th "

Subdivisions run with a Variation of 14° 40' East.

Survey Designated	By Whom Surveyed	Date of Contract	Amount of Survey	When Surveyed	362 Com.
N. bdy.	Glavin & Anderson	Nov 13 th 1880	26- 52- 56	1880	102
O. W. & D. bdy.	Billy & George	Dec 2 nd "	17- 77- 89	1881	108
Sub divisions (black)	" "	" "	19- 73- 93	March "	"
" (blue)	" "	" "	39- 71- 00	" "	"
Demingway (yellow)	" "	" "	43- 91	" "	"

The above Map of Township N^o 5 North of Range N^o 39 East of Mount Diablo Meridian is strictly conformable to the field notes of the survey thereof on file in this Office, which have been examined and approved.

Surveyor General's Office. }
Virginia City Nev. }
March 25th 1881 }
C. S. Paine }
Sur. Gen. Nev. }