

Township N^o 4 South

Range N^o 60 East

Mount Diablo Meridian

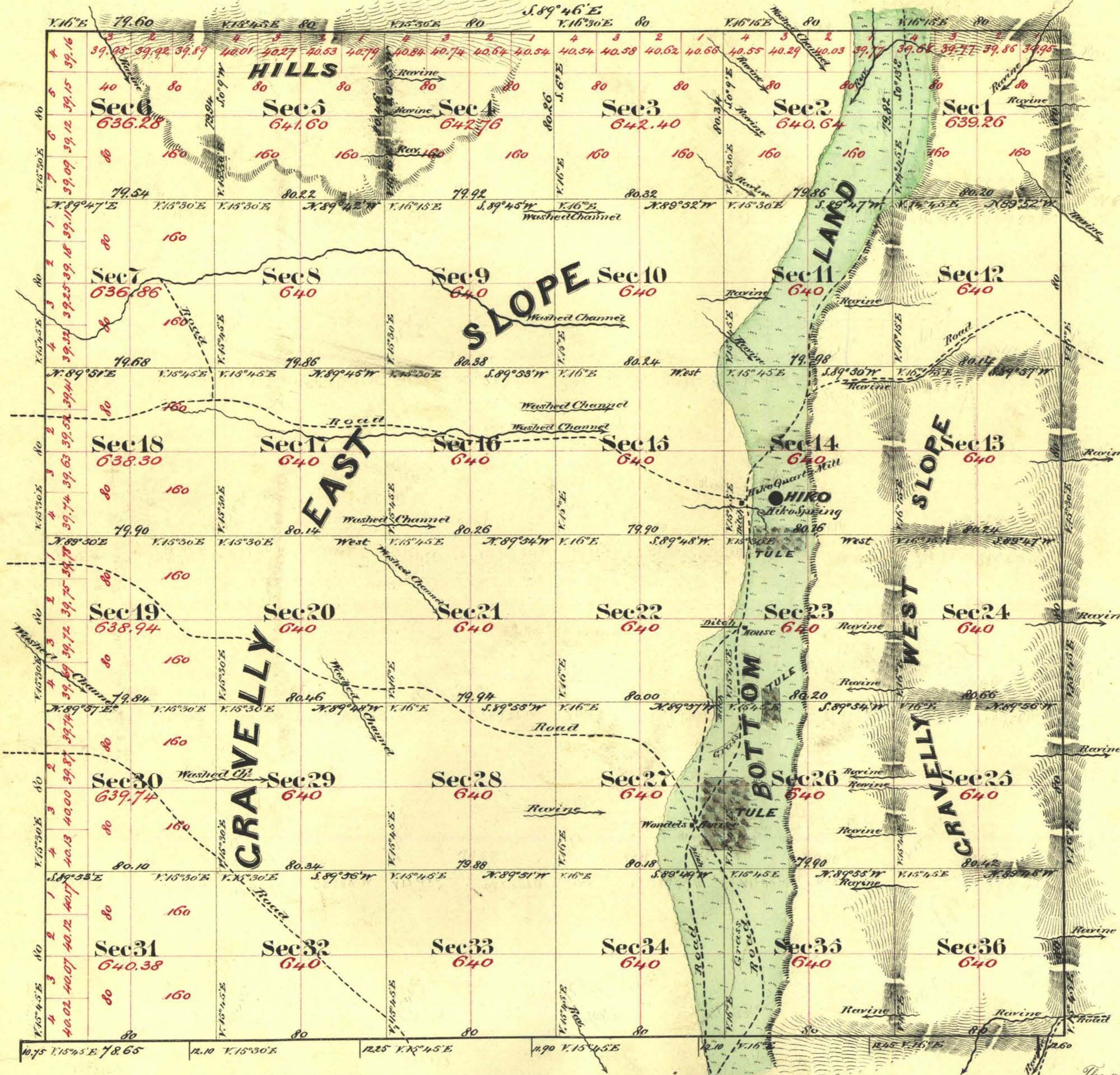

Aggregate Area of Public Land (Surveyed) 23,037.16 Acres

Commenced September 5th 1870
Completed 12th

Surveys Designated	By Whom Surveyed	Date of Contract	Amount of Surveys M ^o C ^o A ^c	When Surveyed	7 th Con.
South Boundary of Township	E. B. Monroe	October 1 st 1869	6. 00. 00.	1869	31
Rest of Township lines	" "	December 12 th 1869	17. 79. 60.	1870	34
Subdivision lines	" "	August 13 th 1870	60. 03. 68.	Sept 1870	35

The above Map of Township N^o 4 South Range N^o 60 East Mount Diablo Meridian is strictly conformable to the field notes of the surveys thereof on file in this office which have been examined and approved
U. S. Surveyor General's Office
Virginia City Nevada
October 20th 1870

E. S. Paris

U. S. Surveyor General Nevada

VP