

# TOWNSHIP 2 SOUTH, RANGE 51½ EAST, OF THE MOUNT DIABLO MERIDIAN, NEVADA

A history of surveys is contained in the field notes.

This plat represents a survey of the south boundary and a portion of the east boundary of section 33, T. 2 S., R. 51½ E., Mount Diablo Meridian, Nevada.

Survey executed by Robert A. Pratt, Cadastral Surveyor, August 1 to October 10, 1977, under Special Instructions dated May 25, 1977 and Supplemental Special Instructions dated October 6, 1977, for Group No. 548, Nevada.

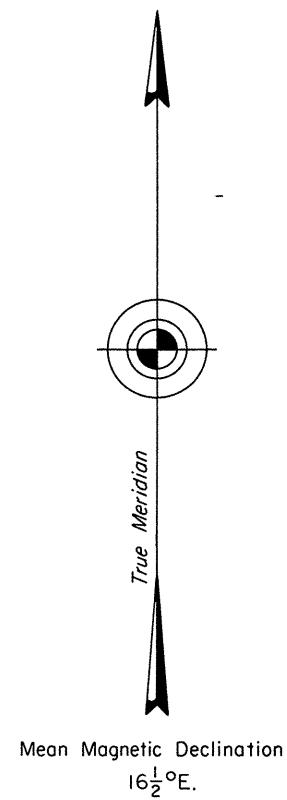

Unsurveyed

UNITED STATES DEPARTMENT OF THE INTERIOR  
BUREAU OF LAND MANAGEMENT  
Washington, D.C. May 17, 1978

This plat is strictly conformable to the approved field notes, and the survey, having been correctly executed in accordance with the requirements of law and the regulations of this Bureau, is hereby accepted.

For the Director

*Bernard W. [Signature]*  
Chief, Division of Cadastral Survey

Sec. 31                      Sec. 32                      Sec. 33

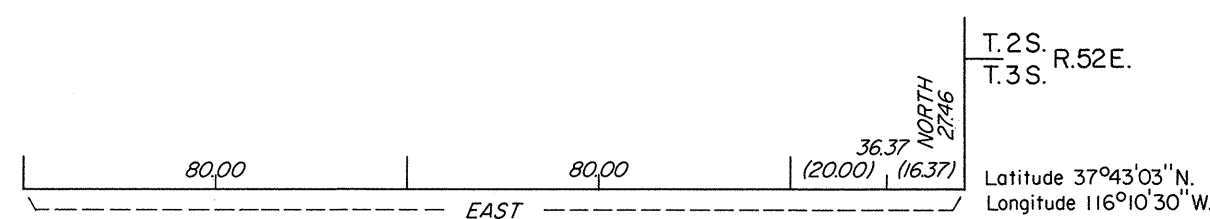

T. 2 S. R. 52 E.  
T. 3 S.  
Latitude 37°43'03" N.  
Longitude 116°10'30" W.

