

TOWNSHIP N<sup>o</sup> 2 SOUTH RANGE N<sup>o</sup> 46 EAST MOUNT DIABLO MERIDIAN

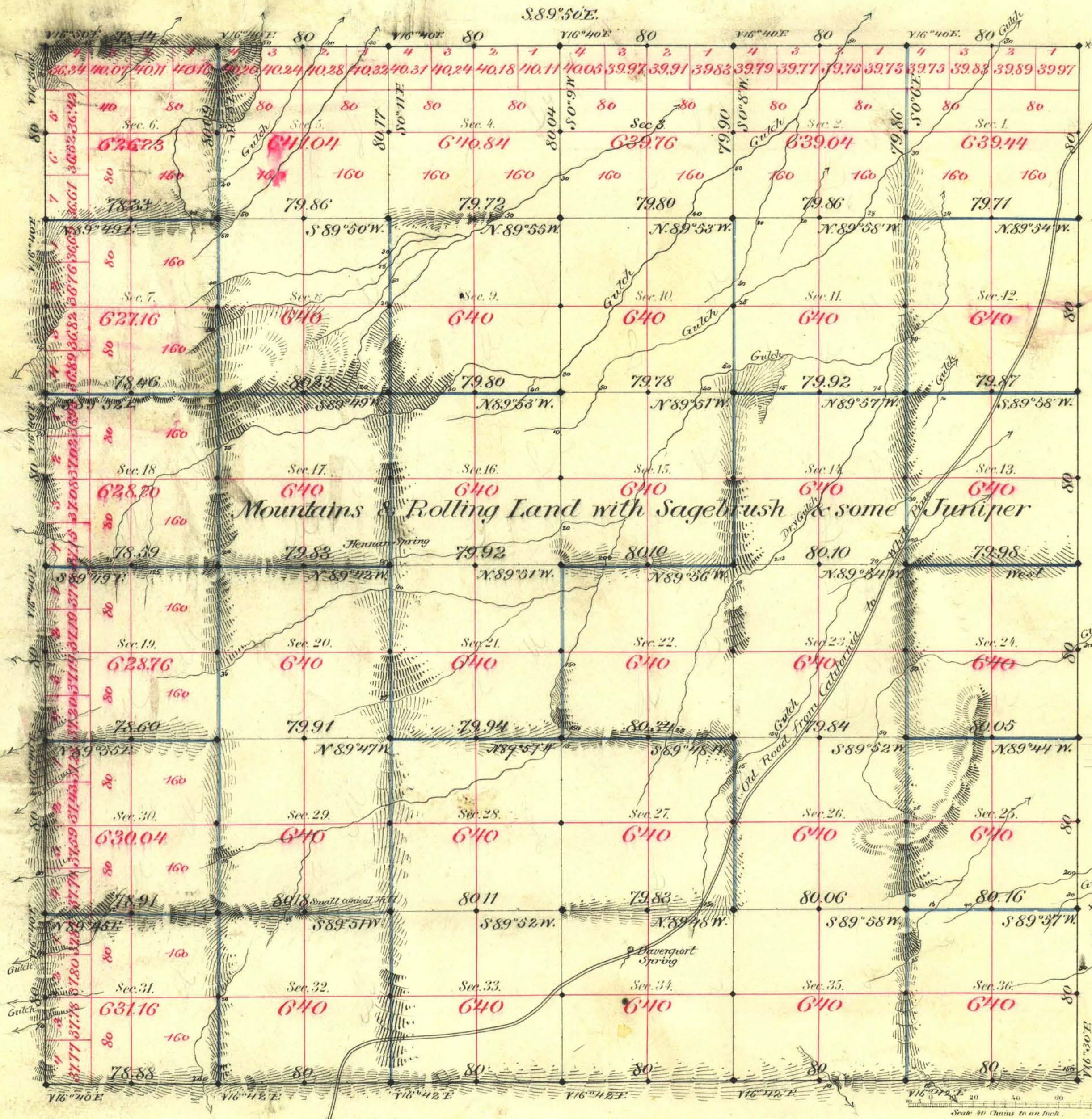

Aggregate Area of Public Lands Surveyed 22,971.67 Acres

Commenced Sept. 14<sup>th</sup> 1881  
Completed " 22 "

Subdivision Lines run with Variation 16° 42' East

Surveys Designated	By Whom Surveyed	Date of Contract	Amount of Surveys	When Surveyed
Township Lines	A. Ludlum	March 22 <sup>nd</sup> 1881	23 - 77 - 82	1881
Subdiv. Black	"	" " "	20 - 78 - 90	"
" Blue	"	" " "	35 - 72 - 95	"

79<sup>th</sup> Con

118

The above Map of Township N<sup>o</sup> 2 South of Range N<sup>o</sup> 46 East Mount Diablo Meridian is strictly conformable to the field notes of the survey thereof on file in this Office, which have been examined and approved.

Surveyor General's Office.  
Virginia City, Nev.  
October 7<sup>th</sup> 1881

C. S. Davis  
Sur. Gen.