

TOWNSHIP N<sup>o</sup> 2 SOUTH RANGE N<sup>o</sup> 44 EAST MOUNT DIABLO MERIDIAN

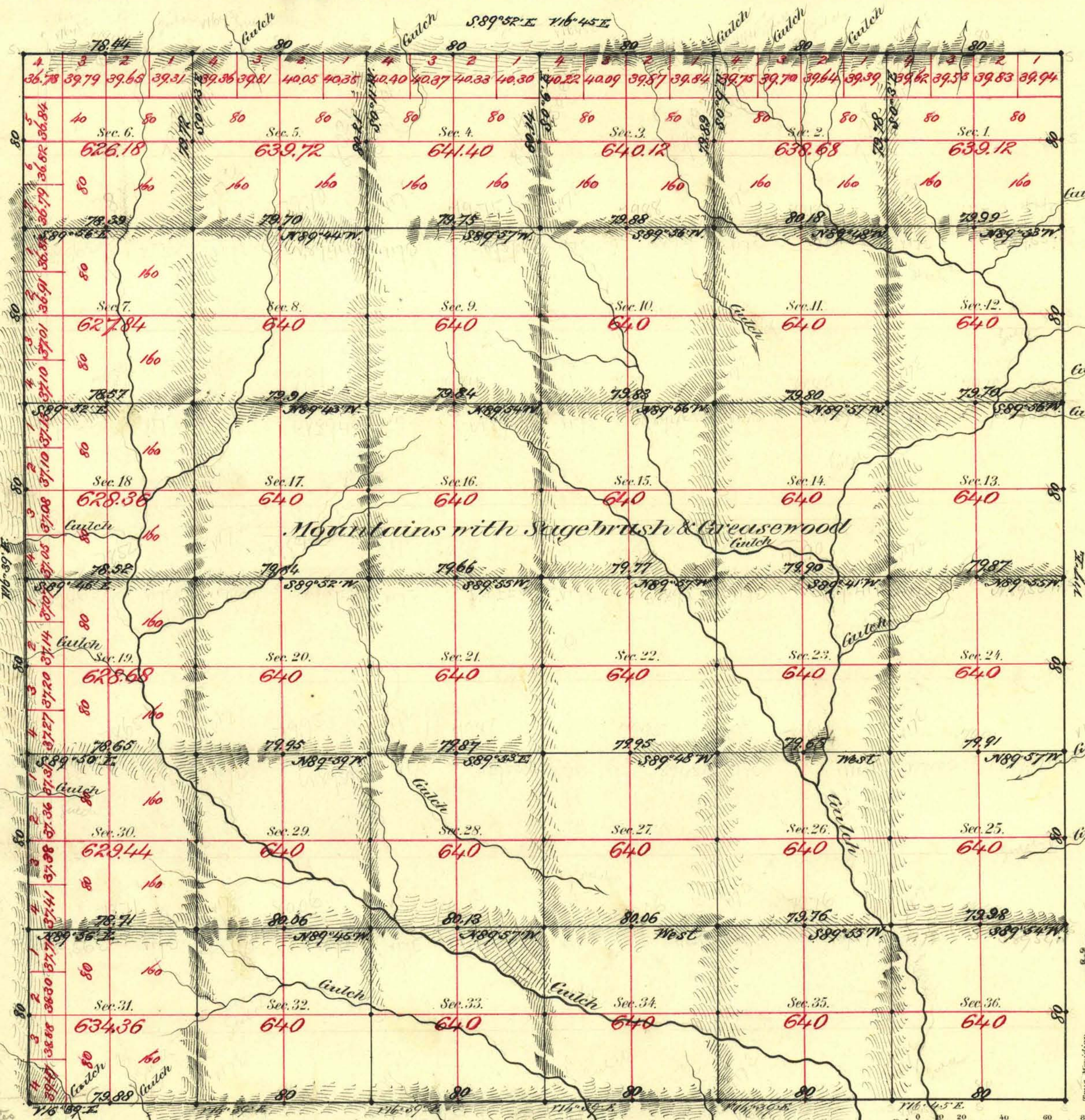

Aggregate Area of Public Land Surveyed 22,973.90 A.

Commenced June 4th 1881  
Completed " 15th "

Dimensions run with a Variation of 17.0.

75.88  
See Field Notes

For connections see T 3

| Surveys Designated | By Whom Surveyed | Date of Contract | Amount of Surveys | When Surveyed |
|--------------------|------------------|------------------|-------------------|---------------|
| Some Shipments     | A. Landman       | March 2nd 1881   | 260 4/8 - 150     | 1881          |
| Public Lands 810   | "                | "                | 39 - 49 - 42      | "             |

779 Corr.  
116 "

The above Map of Township N<sup>o</sup> 2 South of Range N<sup>o</sup> 44 East of Mount Diablo Meridian is strictly conformable to the field notes of the survey thereof on file in this Office, which have been examined and approved.

Surveyor General's Office,  
Virginia City Nev.  
June 24<sup>th</sup> 1881

C. A. Davis  
Sur. Gen.