

TOWNSHIP N<sup>o</sup> 2 NORTH RANGE N<sup>o</sup> 43 EAST MOUNT DIABLO MERIDIAN

S. 89° 47' E. 17 1/2'

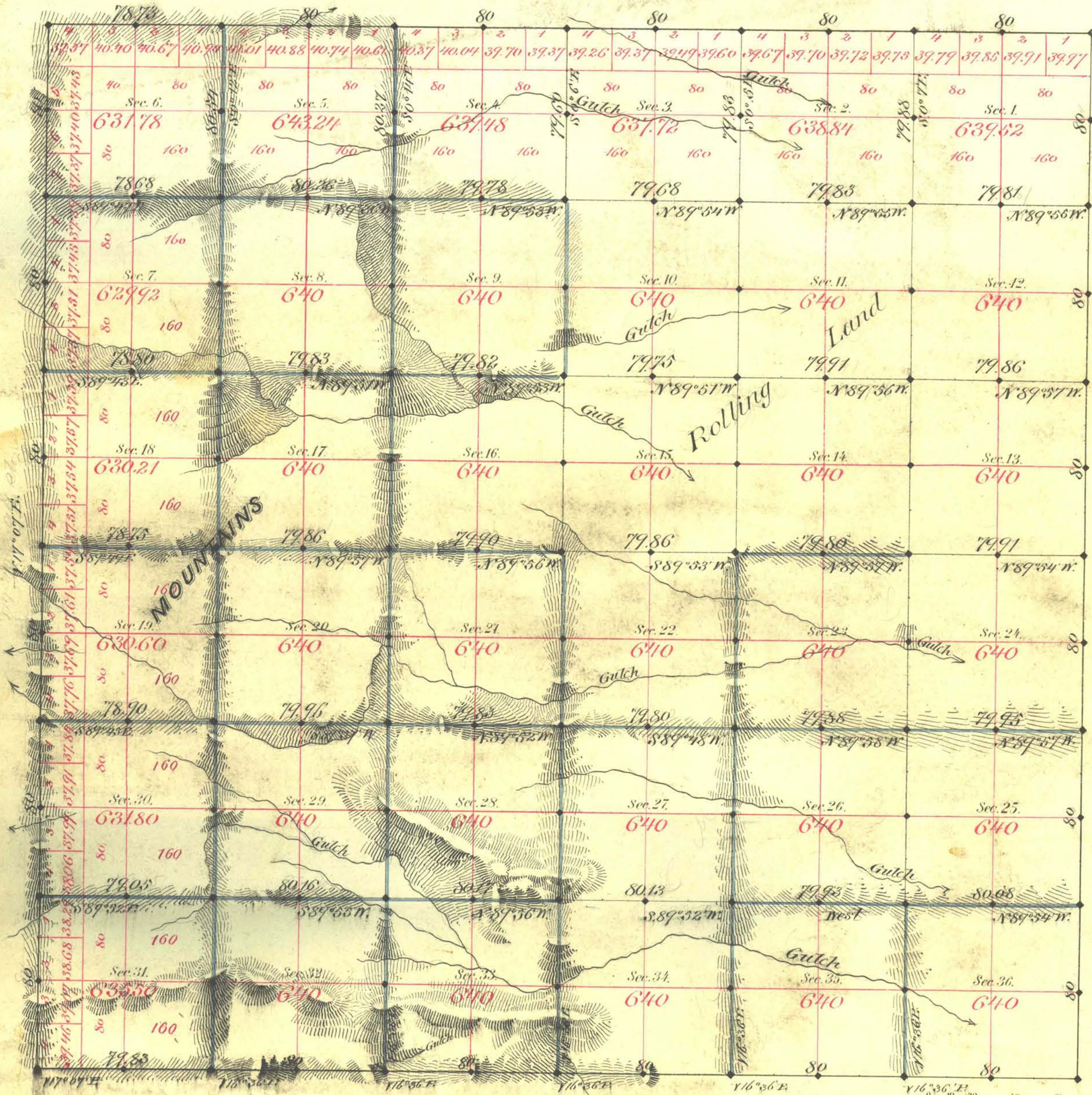

Aggregate Area of Public Lands Surveyed 22988.61 Acres

Survey Commenced July 7<sup>th</sup> 1881  
Completed " 14 "

Subdivisions not otherwise noted run with Var 16° 58' East

Surveys Designated	By Whom Surveyed	Date of Contract	Amount of Surveys	When Surveyed
S. boundary	A. Leedum	March 22 <sup>nd</sup> 1881	25-00-00	1881
N. "	Glouvers Perkin	Jan'y 19 <sup>th</sup> "	6-00-00	"
E. "	"	April 16 "	11-75-73	"
Subd's Black 1/200	"	"	18-78-08	"
" Blue 1/100	"	"	20-74-00	"

799 Cor

113

110

122

"

"

The above Map of Township N<sup>o</sup> 2 North of Range N<sup>o</sup> 43 East Mount Diablo Meridian is strictly conformable to the field notes of the survey thereof on file in this Office, which have been examined and approved.

Surveyor General's Office,  
Virginia City Nevada  
September 20<sup>th</sup> 1881

C. S. Davis  
Sur. Gen.