

OFFICIALLY FILED  
NEVADA STATE OFFICE  
10:00 A.M. February 23, 1978

# TOWNSHIP 1 SOUTH, RANGE 50 EAST, OF THE MOUNT DIABLO MERIDIAN, NEVADA.

## DEPENDENT RESURVEY

Sec. 31                      Sec. 32                      Sec. 33                      Sec. 34                      Sec. 35                      Sec. 36

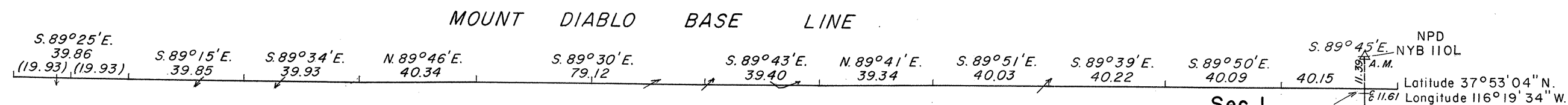

Sec. 1

Sec. 12

Sec. 13

Sec. 24

Sec. 25

Sec. 36

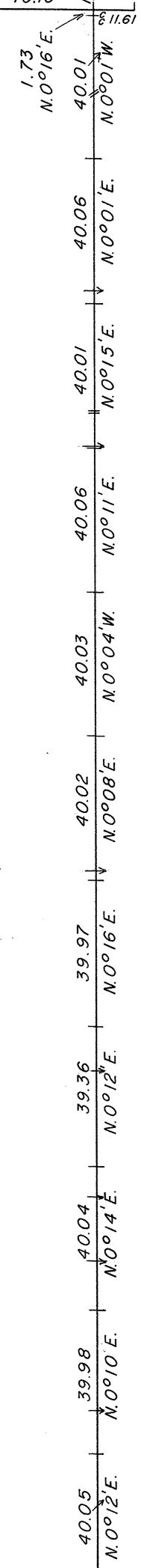

NPD NYB 110L  
Latitude 37° 53' 04" N.  
Longitude 116° 19' 34" W.

A history of surveys is contained in the field notes.  
This plat represents a dependent resurvey of the Mount Diablo Base Line, through R. 50 E., and the east boundary of T. 1 S., R. 50 E., Mount Diablo Meridian, Nevada, designed to restore the corners in their true original locations according to the best available evidence.

Survey executed by Duane R. Garoutte, Cadastral Surveyor, May 3 to June 1, 1976, under Special Instructions dated March 5, 1976, and Supplemental Special Instructions dated April 8, 1976 for Group No. 531, Nevada.

UNITED STATES DEPARTMENT OF THE INTERIOR  
BUREAU OF LAND MANAGEMENT  
Washington, D.C.                      January 20, 1978

This plat is strictly conformable to the approved field notes, and the survey, having been correctly executed in accordance with the requirements of law and the regulations of this Bureau, is hereby accepted.

For the Director

*Roger T. Barron*

Acting Chief, Division of Cadastral Survey

Latitude 37° 48' 16" N.  
Longitude 116° 19' 44" W.

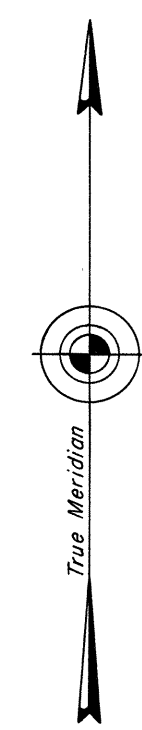

Mean Magnetic Declination  
16 1/2° E.

