

RETRACEMENT AND REMONUMENTATION OF CERTAIN CORNERS
OF A PORTION OF MINERAL SURVEY NOS.
2893, 2900, 2903 AND 2904, MDM, NEVADA

CHAINS

Set an iron post, 28 ins. long, 2½ ins. diam, 8 ins. in the ground to bedrock and in a mound of stone, 3½ ft. base to top, with brass cap mkd.

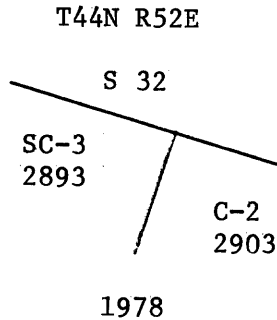

reset the original wooden post alongside the iron post.

Thence S. 75° 47' E.

9.25 Cor. No. 3 of M.S. 2903, Colorado lode, and place of beginning.

GENERAL DESCRIPTION

The lines resurveyed within Township 44 North, Range 52 East, is mountainous and is located in the Bull Run Mountains. The elevation ranges from about 5800 to 9300 ft. above sea level. The soil varies from sandy clay loam in the lower elevations to rocky in the higher elevations. The vegetation consists of sagebrush, bunchgrass, aspens and fir trees.

Access into the township is provided by State Route No. 11A and numerous unimproved trail roads.

Principal users of the area are cattlemen. There has been mining activity throughout the Township.