

SUBDIVISION OF T. 23 N., R. 34 E.

- Chains
- 60.40 Same rocky ravine, drains NW. Asc. rocky SW. slope over series of ledges 40 ft. to
- 69.25 Desc. rocky broken NW. slope 105 ft. to 79.80 chs.
- 71.25 Rocky ravine, drains N. 80° W.
- 73.85 Rocky spur, projects W.
- 78.45 Rocky spur, projects W.
- 79.80 Intersect N. bdy. of Tp., N. 89° 57' W., 14.44 chs. from the cor. of secs. 33 and 34, and at point of intersection; set an iron post, 3 ft. long, 2 ins. diam., 12 ins. in the ground to bedrock, with a granite stone, 5x4x2 ins., mkd. X, deposited at the base, and in a mound of stone, for the closing cor. of secs. 3 and 4, with brass cap mkd.

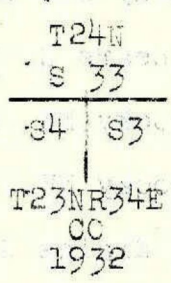

Land, rough mountainous. Soil, rocky, 4th rate. Timber, none. Undergrowth, sagebrush, squaw brush, shadscale. General drainage, NW. Grazing, poor.

From the cor. of secs. 4, 5, 32, and 33, on S. bdy. of Tp. N. 0° 02' W., bet. secs. 32 and 33.

Over rough mountainous land, through scattering timber and sparse undergrowth.

Asc. SE. to E. precipitous rocky slopes over impassable series of ledges 435 ft. to

28.00 Steep rocky inaccessible canyon, drains SE.

Asc. precipitous rocky broken SW. slope over impassable cliffs and slides 335 ft. to 49.00 chs.

From the cor. of secs. 4, 5, 32, and 33; vertical angle to flag on line is +16°; auxiliary flag bears East, 23.99 chs. dist.; from flag on line the auxiliary flag bears S. 23° 13' E.; all angles are determined by deflection;

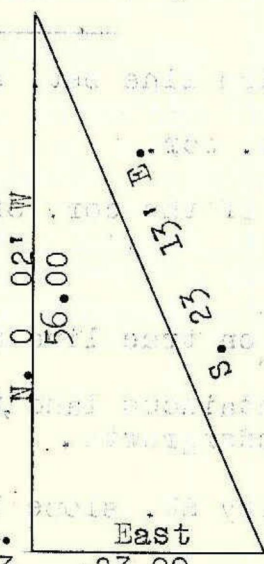

Cor. of secs. 4, 5, 32, 33 East 23.99 Auxiliary flag