

Chains

and raise a mound of stone, 2 ft. base, 1½ ft. high E. of corner.  
 Land; rolling land with a slope to the S.E. Soil; poor quality, coarse texture, wash from the hills to the W. Contains considerable gravel and loose volcanic rock. Quite dry, 3rd. rate. Good growth short sagebrush and shadscale, not much grass, no timber.

2.50 N. 0° 11' W. bet. secs. 5 and 6  
 40.00 Over rolling land, sloping to the S.E.  
 Wash, course S. E.  
 Set an iron post, 3 ft. long, 1 in. diam., 24 ins. in the ground for ¼ sec. cor., with brass cap mkd.,

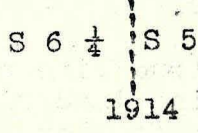

43.35 and raise a mound of stone, 2 ft. base, 1½ ft. high W. of corner.  
 77.35 Ravine, course S. E.  
 Intersect the 6th Standard Parallel North at E., 8.61chs from the standard S. W. cor. of sec. 32.  
 Set an iron post, 3 ft. long, 2 ins. diam., 24 ins. in the ground for closing corner of secs. 5 and 6 with brass cap mkd.,

*North E. Corner*

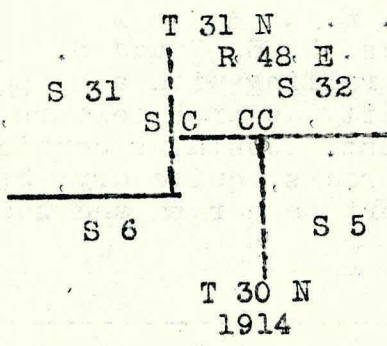

and raise amount of stone, 2 ft. base, 1½ ft. high S. of corner.  
 Land, rolling land sloping to the S. E. Soil; poor quality, coarse texture. Wash from the hills to the W. Contains much gravel and many loose volcanic rocks. Quite dry, 3rd. rate. Good growth short sagebrush and shadscale, not much grass, no timber.

21.86 From the cor. of secs. 31 and 32, on the S. bdy. of the  
 40.00 tp.  
 I retrace  
 S. 89° 2' W. on the S. bdy. of sec. 31.  
 The ¼ sec. cor. for sec. 6.  
 Set an iron post, 3 ft. long, 1 in. diam., 24 ins. in the ground for ¼ sec. cor. for sec. 31, with brass cap mkd.,

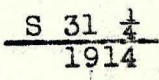

and raise amount of stone 2 ft. base, 1½ ft. high N. of corner.