

# Resurvey of 3<sup>d</sup> Standard Parallel North

chains

Set an iron post 3 ft. long, 3 ins. in diam., 24 ins. in the ground for closing cor. of the S.W. cor. of T. 16 N. R. 26 E. with brass cap marked.

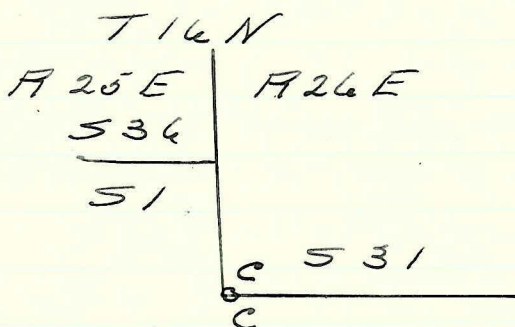

T 15 N R 26 E

1913

and raise a mound of stone, 2 ft. base, 1 1/2 ft. high. E. of cor.

Land, mountainous

Soil, lava rock, volcanic formation  
4<sup>th</sup> rate

Undergrowth, scattering sage-  
and desert brush, bunch grass  
No timber

July 31, 1913.

## Retracement Subdivision T 15 N R 26 E

July 26, 1913:

From the cor. of secs. 3, 4, 33  
and 34, on the S. bdy. of the  
Twp., heretofore described, we  
retrace

with Mt. secs. 33 and 34

40.00

Set temp. 7 sec. cor. The old  
cor. is described in the field  
notes of the Surveyor General as  
a post with pile and mound  
of earth. After diligent search  
we find no traces of post.